

CHAPTER 42PPP-1
VILLAGE COMMUNITY DEVELOPMENT DISTRICT 10

42PPP-1.001	Amended District
42PPP-1.002	Boundary of the Amended District
42PPP-1.003	Supervisors of the Amended District

42PPP-1.001 Amended District.

The boundaries of Village Community Development District No. 10, initially established by county ordinance, are hereby amended to exceed the amount of land specified in subsection 190.046(1)(e)2., F.S.

Rulemaking Authority 190.005 FS. Law Implemented 190.004, 190.005, 190.046 FS. History--New 1-5-14.

42PPP-1.002 Boundary of the Amended District.

The boundaries of the district are those set forth in Exhibit "6" dated July 2013 and entered into the record during the August 14, 2013, administrative hearing conducted by the Division of Administrative Hearings (DOAH). The legal description of the boundaries of the amended district described in Exhibit "6" is hereby incorporated by reference, and available at <https://www.flrules.org/Gateway/reference.asp?No=Ref-03358>, and copies of which are available by contacting the Clerk of the Florida Land and Water Adjudicatory Commission at Office of the Governor, Room 1801, The Capitol, Tallahassee, Florida 32399-0001.

The total Village Community Development District No. 10 area = 1,588.8 acres, more or less.

Rulemaking Authority 190.005 FS. Law Implemented 190.004, 190.005, 190.046 FS. History--New 1-5-14.

42PPP-1.003 Supervisors of the Amended District.

The following five persons are the members of the Board of Supervisors at the time of the boundary amendment that caused the amount of land within the District to exceed that specified in subsection 190.046(1)(e)2., F.S: Dennis Stradinger, Brad Brown, Heather Figlow, Roz Harris, and Don Waggoner.

Rulemaking Authority 190.005 FS. Law Implem

RESOLUTION No. 2013-27

A RESOLUTION OF THE BOARD OF COUNTY COMMISSIONERS OF SUMTER COUNTY, FLORIDA SUPPORTING THE EXPANSION OF THE VILLAGES COMMUNITY DEVELOPMENT DISTRICT NUMBER 10 TO A TOTAL AREA OF 1579 ACRES THROUGH THE ADDITION OF ACREAGE REMOVED FROM THE VILLAGES BROWNWOOD COMMERCIAL COMMUNITY DEVELOPMENT DISTRICT.

WHEREAS, the Board of County Commissioners of Sumter County established The Villages Community Development District Number 10 by Ordinance 2004-38 adopted on September 28, 2004, pursuant to the powers set forth in Chapter 190, Florida Statutes; and

WHEREAS, the expansion of the District will provide for the operation and maintenance of roadways, drainage infrastructure and water management facilities to the support and benefit of the residents of the District, being also residents of Sumter County, Florida;

NOW THEREFORE BE IT RESOLVED BY the Board of County Commissioners of Sumter County as follows:

Section 1. The Board of County Commissioners of Sumter County fully endorses and supports the proposed expansion of The Villages Community Development District Number 10 as specified in correspondence from The Villages Director of Development dated May 17, 2013.

Section 2. By virtue of this Resolution the Board of County Commissioners of Sumter County conveys and informs the Florida Land and Water Adjudicatory Commission of its endorsement and support of the proposed District expansion submitted pursuant to Chapter 190, Florida Statutes.

PASSED AND ADOPTED BY THE SUMTER COUNTY BOARD OF COUNTY COMMISSIONERS, SUMTER COUNTY, FLORIDA, THIS 28th DAY OF May, 2013.

SUMTER COUNTY BOARD OF COUNTY COMMISSIONERS



DOUG GILPIN, CHAIRMAN



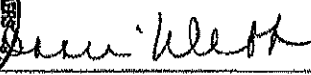

GLORIA HAYWARD,
SUMTER COUNTY CLERK OF COURT
BY: CONNIE WEBB, Deputy Clerk

Approved as to form for the reliance of
The Sumter County Board of County
Commissioners, only:

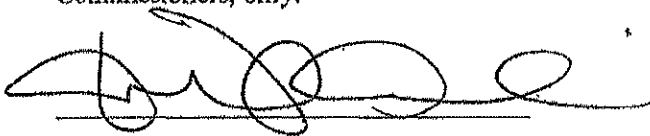

GEORGE ANGELIADIS, ESQ.,
THE HOGAN LAW FIRM, COUNTY ATTORNEY

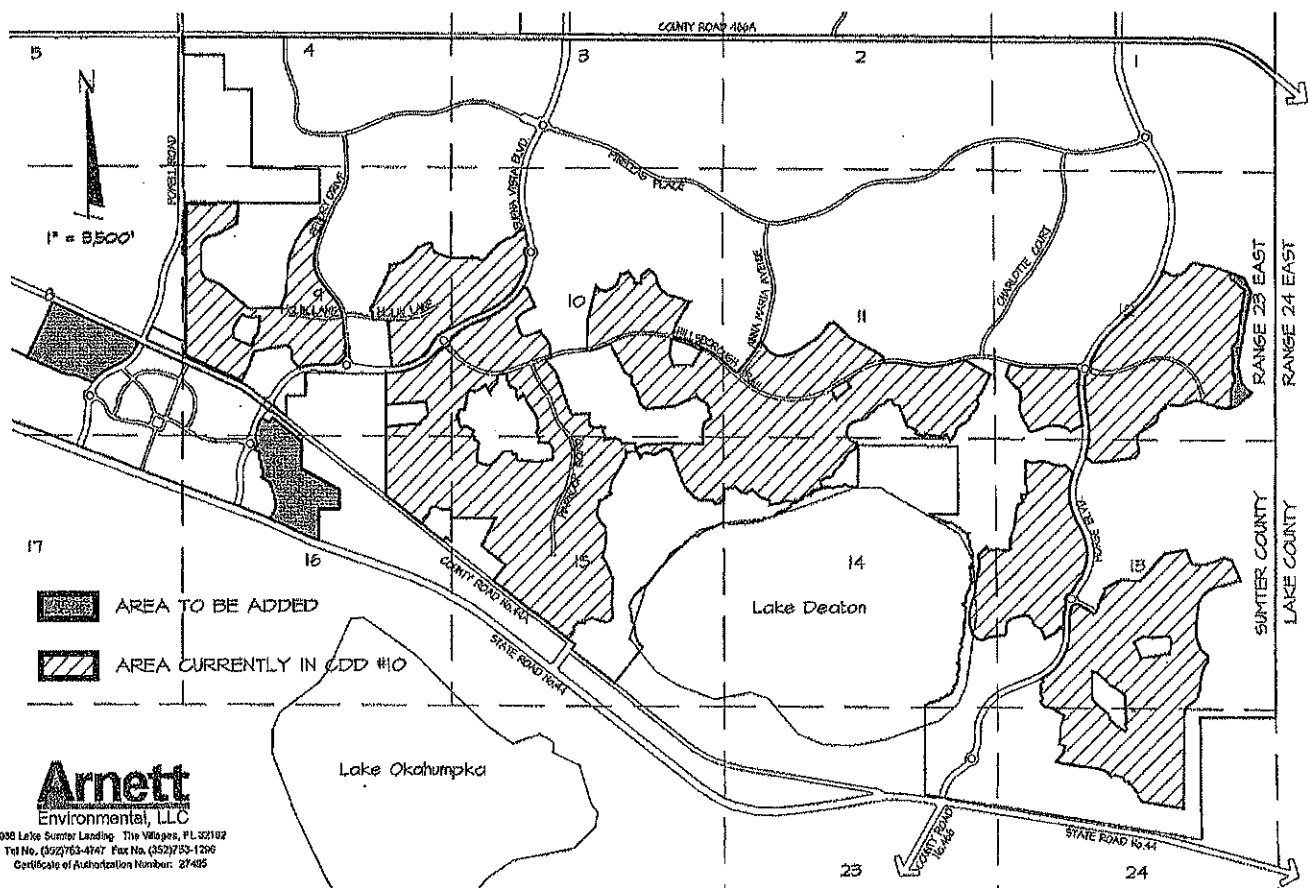

Arnett
Environmental, LLC

1000 Lake Sunset Landing The Villages, FL 32162
Tel No. (352) 763-4141 Fax No. (352) 733-1295
Certificate of Authorization Number: 27405

EXHIBIT "3"

**DESCRIPTION OF THE AREA TO BE ADDED
VILLAGE COMMUNITY DEVELOPMENT DISTRICT NO. 10
APPROXIMATELY 99.3 ACRES**

THAT LAND LYING IN SECTION 8, TOWNSHIP 19 SOUTH, RANGE 23 EAST, SUMTER COUNTY, FLORIDA, DESCRIBED AS FOLLOWS:

BEGIN AT THE INTERSECTION OF THE EASTERLY LINE OF KERL AND MILLERS SUBDIVISION FIRST ADDITION TO WILDWOOD, ACCORDING TO THE PLAT THEREOF AS RECORDED IN PLAT BOOK 2, PAGE 55, PUBLIC RECORDS OF SUMTER COUNTY, FLORIDA AND THE SOUTHERLY RIGHT OF WAY OF THE CSX RAILWAY; THENCE N24°48'19"E, ALONG THE NORTHEASTERLY EXTENSION THEREOF A DISTANCE OF 30.33 FEET TO THE SOUTHWESTERLY RIGHT OF WAY LINE OF COUNTY ROAD NO. 44A PER OFFICIAL RECORDS BOOK 2173, PAGE 643, PUBLIC RECORDS OF SUMTER COUNTY, FLORIDA; THENCE S65°10'12"E, ALONG SAID SOUTHWESTERLY RIGHT OF WAY LINE A DISTANCE OF 1,834.89 FEET TO THE POINT OF CURVATURE OF A CURVE CONCAVE WESTERLY AND HAVING A RADIUS OF 50.00 FEET; SAID POINT ALSO BEING ON THE WESTERLY RIGHT OF WAY LINE OF POWELL ROAD PER OFFICIAL RECORDS BOOK 2088, PAGE 199, PUBLIC RECORDS OF SUMTER COUNTY, FLORIDA; THE FOLLOWING (5) FIVE COURSES BEING ALONG SAID WESTERLY RIGHT OF WAY LINE OF POWELL ROAD: THENCE SOUTHERLY ALONG THE ARC OF SAID CURVE THROUGH A CENTRAL ANGLE OF 90°14'54", AN ARC DISTANCE OF 78.76 FEET TO THE POINT OF TANGENCY; THENCE S25°04'43"W, 30.65 FEET TO THE POINT OF CURVATURE OF A CURVE CONCAVE NORTHWESTERLY AND HAVING A RADIUS OF 690.00 FEET; THENCE SOUTHWESTERLY ALONG THE ARC OF SAID CURVE THROUGH A CENTRAL ANGLE OF 38°11'57", AN ARC DISTANCE OF 460.02 FEET TO THE POINT OF TANGENCY; THENCE S63°16'39"W, 330.88 FEET TO THE POINT OF CURVATURE OF A CURVE CONCAVE SOUTHEASTERLY AND HAVING A RADIUS OF 760.00 FEET; THENCE SOUTHWESTERLY ALONG THE ARC OF SAID CURVE THROUGH A CENTRAL ANGLE OF 27°47'37", AN ARC DISTANCE OF 368.67 FEET TO A POINT ON A NON-TANGENT LINE; THENCE DEPARTING SAID WESTERLY RIGHT OF WAY LINE RUN N66°22'30"W, 309.36 FEET; THENCE N69°21'04"W, 40.55 FEET; THENCE N75°37'23"W, 40.55 FEET; THENCE N82°26'11"W, 47.51 FEET; THENCE N86°19'02"W, 51.75 FEET; THENCE N81°27'56"W, 61.87 FEET; THENCE N75°49'16"W, 61.91 FEET; THENCE N70°02'15"W, 57.09 FEET; THENCE N65°11'41"W, 716.85 FEET TO A POINT ON THE SOUTHWESTERLY EXTENSION OF SAID EASTERLY LINE OF KERL AND MILLER SUBDIVISION; THENCE N24°48'19"E, ALONG SAID SOUTHWESTERLY EXTENSION AND EASTERLY LINE A DISTANCE OF 1,151.34 FEET TO THE POINT OF BEGINNING.

AND

THAT LAND LYING IN SECTIONS 9 AND 16, TOWNSHIP 19 SOUTH, RANGE 23 EAST, SUMTER COUNTY, FLORIDA, DESCRIBED AS FOLLOWS:

COMMENCE AT THE INTERSECTION OF THE WESTERLY LINE OF OAK PARK, ACCORDING TO THE PLAT THEREOF AS RECORDED IN PLAT BOOK 4, PAGE 32, PUBLIC RECORDS OF SUMTER COUNTY, FLORIDA AND THE NORTHERLY RIGHT OF WAY OF STATE ROAD NO. 44 PER FLORIDA DEPARTMENT OF TRANSPORTATION RIGHT-OF-WAY MAP, SECTION #18070-2518; THE FOLLOWING (5) FIVE COURSES BEING ALONG THE NORTHEASTERLY RIGHT OF WAY LINE OF STATE ROAD NO. 44 PER FLORIDA DEPARTMENT OF TRANSPORTATION RIGHT OF WAY MAP, SECTION NO. 18070-2518: THENCE N67°34'23"W, 21.54 FEET TO THE POINT OF BEGINNING; SAID POINT BEING ON THE WEST LINE OF AT&T EASEMENT PER OFFICIAL RECORDS BOOK 1895, PAGE 758, PUBLIC RECORDS OF SUMTER COUNTY, FLORIDA; THENCE CONTINUE N67°34'23"W, 250.31 FEET; THENCE N65°48'19"W, 300.48 FEET; THENCE N64°37'01"W, 200.60 FEET; THENCE N65°58'19"W, 285.16 FEET; THENCE DEPARTING SAID NORTHEASTERLY RIGHT OF WAY LINE N24°01'41"E, 65.68 FEET; THENCE N32°23'55"E, 140.60 FEET; THENCE N04°46'45"E, 73.00 FEET; THENCE N01°10'58"W, 52.54 FEET; THENCE N04°23'35"W, 51.25 FEET; THENCE N28°44'18"W, 65.15 FEET; THENCE N01°43'08"E, 42.10 FEET; THENCE N15°39'56"W, 256.37 FEET; THENCE N49°22'14"W, 101.62 FEET; THENCE N76°47'19"W, 45.53 FEET; THENCE N49°51'52"W, 41.97 FEET; THENCE N07°47'15"E, 72.46 FEET; THENCE N02°12'30"E, 75.72 FEET; THENCE N23°11'30"W, 55.27 FEET; THENCE N11°16'59"W, 60.79 FEET; THENCE N10°00'31"W, 148.31 FEET; THENCE N03°42'25"W, 51.55 FEET; THENCE N39°04'10"E, 34.97 FEET; THENCE N50°55'50"W, 56.17 FEET; THENCE N69°01'01"W, 65.50 FEET TO A POINT ON THE EASTERLY RIGHT OF WAY LINE OF BUENA VISTA BOULEVARD PER OFFICIAL RECORDS BOOK 2332, PAGE 395, PUBLIC RECORDS OF SUMTER COUNTY, FLORIDA; THE FOLLOWING (12) TWELVE COURSES BEING ALONG SAID EASTERLY RIGHT OF WAY LINE OF BUENA VISTA BOULEVARD: THENCE N20°59'49"E, 41.76 FEET TO A POINT ON THE ARC OF A NON-TANGENT CURVE CONCAVE SOUTHERLY, HAVING A RADIUS OF 144.00 FEET AND A CHORD BEARING AND DISTANCE OF N71°51'18"W, 26.82 FEET TO WHICH A RADIAL LINE BEARS N23°29'20"E; THENCE WESTERLY ALONG THE ARC OF SAID CURVE, THROUGH A CENTRAL ANGLE OF 10°41'15", AN ARC DISTANCE OF 26.86 FEET TO THE POINT OF REVERSE CURVATURE OF A CURVE CONCAVE EASTERLY AND HAVING A RADIUS OF 2.50 FEET; THENCE NORTHERLY ALONG THE ARC OF SAID CURVE THROUGH A CENTRAL ANGLE OF 116°32'00", AN ARC DISTANCE OF 5.08 FEET TO THE POINT OF REVERSE CURVATURE OF A CURVE CONCAVE NORTHWESTERLY AND HAVING A RADIUS OF 105.00 FEET; THENCE NORTHEASTERLY ALONG THE ARC OF SAID CURVE THROUGH A CENTRAL ANGLE OF 11°50'07", AN ARC DISTANCE OF 21.69 FEET TO THE POINT OF REVERSE CURVATURE OF A CURVE CONCAVE SOUTHERLY AND HAVING A RADIUS OF 2.50 FEET; THENCE EASTERLY ALONG THE ARC OF SAID CURVE THROUGH A CENTRAL ANGLE OF 110°43'59", AN ARC DISTANCE OF 4.83 FEET TO THE POINT OF REVERSE CURVATURE OF A CURVE CONCAVE NORTHEASTERLY AND HAVING A RADIUS OF 99.00 FEET; THENCE SOUTHEASTERLY ALONG THE ARC OF SAID CURVE THROUGH A CENTRAL ANGLE OF 13°09'42", AN ARC

DISTANCE OF 22.74 FEET TO A POINT ON A NON-TANGENT LINE; THENCE N26°58'16"E, 56.68 FEET TO A POINT ON THE ARC OF A NON-TANGENT CURVE CONCAVE EASTERLY, HAVING A RADIUS OF 50.00 FEET AND A CHORD BEARING AND DISTANCE OF N20°50'01"W, 26.61 FEET TO WHICH A RADIAL LINE BEARS S53°44'05"W; THENCE NORTHERLY ALONG THE ARC OF SAID CURVE, THROUGH A CENTRAL ANGLE OF 30°51'46", AN ARC DISTANCE OF 26.93 FEET TO THE POINT OF REVERSE CURVATURE OF A CURVE CONCAVE WESTERLY AND HAVING A RADIUS OF 131.00 FEET; THENCE NORTHERLY ALONG THE ARC OF SAID CURVE THROUGH A CENTRAL ANGLE OF 29°39'32", AN ARC DISTANCE OF 67.81 FEET TO THE POINT OF REVERSE CURVATURE OF A CURVE CONCAVE EASTERLY AND HAVING A RADIUS OF 50.00 FEET; THENCE NORTHERLY ALONG THE ARC OF SAID CURVE THROUGH A CENTRAL ANGLE OF 47°24'18", AN ARC DISTANCE OF 41.37 FEET TO THE POINT OF TANGENCY; THENCE N12°20'37"E, 131.30 FEET TO THE POINT OF CURVATURE OF A CURVE CONCAVE EASTERLY AND HAVING A RADIUS OF 840.00 FEET; THENCE NORTHERLY ALONG THE ARC OF SAID CURVE THROUGH A CENTRAL ANGLE OF 19°08'32", AN ARC DISTANCE OF 280.64 FEET TO A POINT ON A NON-TANGENT LINE; THENCE S62°39'03"E, 146.42 FEET; THENCE S80°10'57"E, 23.25 FEET; THENCE N38°13'27"E, 92.58 FEET TO A POINT ON THE BOUNDARY LINE OF SAID AT&T EASEMENT PER OFFICIAL RECORDS BOOK 1895, PAGE 758; THE FOLLOWING (8) EIGHT COURSES BEING ALONG THE SOUTHERLY AND WESTERLY BOUNDARY LINES OF AT&T EASEMENT: THENCE S49°45'39"E, 151.02 FEET; THENCE S51°46'33"E, 558.34 FEET; THENCE S24°56'33"E, 37.05 FEET; THENCE S00°32'40"W, 525.34 FEET; THENCE S60°44'37"E, 834.76 FEET; THENCE S00°33'26"W, 362.42 FEET; THENCE N89°43'00"W, 401.79 FEET; THENCE S00°37'16"W, 618.11 FEET TO THE POINT OF BEGINNING.

AND

THAT LAND LYING IN SECTION 12, TOWNSHIP 19 SOUTH, RANGE 23 EAST, SUMTER COUNTY, FLORIDA, DESCRIBED AS FOLLOWS:

FROM THE SOUTHWEST CORNER OF THE SOUTHEAST 1/4 OF SAID SECTION 12 RUN N00°35'56"E, ALONG THE WEST LINE THEREOF A DISTANCE OF 880.92 FEET; THENCE DEPARTING SAID WEST LINE, S89°24'04"E, 1,556.91 FEET TO THE POINT OF BEGINNING; THENCE N80°03'32"E, 71.68 FEET; THENCE N83°52'57"E, 66.01 FEET; THENCE S61°32'20"E, 46.18 FEET; THENCE S04°31'14"E, 70.53 FEET; THENCE N68°12'40"W, 196.43 FEET TO THE POINT OF BEGINNING.

AND

THAT LAND LYING IN SECTION 12, TOWNSHIP 19 SOUTH, RANGE 23 EAST, SUMTER COUNTY, FLORIDA, DESCRIBED AS FOLLOWS:

FROM THE SOUTHWEST CORNER OF THE SOUTHEAST 1/4 OF SAID SECTION 12 RUN N00°35'56"E, ALONG THE WEST LINE THEREOF A DISTANCE OF 773.48 FEET; THENCE DEPARTING SAID WEST LINE, S89°24'04"E, 2,051.99 FEET TO THE POINT OF

BEGINNING; THENCE N38°43'19"E, 35.12 FEET; THENCE N00°29'31"W, 270.52 FEET; THENCE N10°09'14"E, 71.20 FEET; THENCE N20°41'45"E, 71.44 FEET; THENCE N17°45'02"E, 92.10 FEET; THENCE N01°31'30"W, 92.18 FEET; THENCE N10°03'33"W, 158.96 FEET; THENCE N06°50'45"E, 67.13 FEET; THENCE N12°33'56"E, 66.94 FEET; THENCE N00°02'41"E, 77.54 FEET; THENCE N10°05'29"W, 193.56 FEET; THENCE N40°58'48"E, 174.73 FEET; THENCE N07°37'20"E, 261.56 FEET; THENCE N09°14'51"E, 286.71 FEET; THENCE N10°36'27"E, 138.30 FEET; THENCE N11°39'20"E, 320.20 FEET; THENCE N51°00'49"W, 381.84 FEET; THENCE N01°46'31"W, 106.49 FEET; THENCE N39°52'52"W, 13.15 FEET; THENCE S70°43'59"E, 299.94 FEET; THENCE S27°57'42"E, 308.82 FEET; THENCE S12°55'17"W, 845.77 FEET; THENCE S06°28'13"W, 336.43 FEET; THENCE S07°40'41"W, 227.19 FEET; THENCE S01°40'01"E, 98.86 FEET; THENCE S12°50'17"E, 235.32 FEET; THENCE S23°30'55"E, 181.38 FEET; THENCE S41°47'04"E, 172.12 FEET; THENCE S48°12'56"W, 233.65 FEET TO THE POINT OF CURVATURE OF A CURVE CONCAVE NORTHWESTERLY AND HAVING A RADIUS OF 474.00 FEET; THENCE SOUTHWESTERLY ALONG THE ARC OF SAID CURVE THROUGH A CENTRAL ANGLE OF 29°47'21", AN ARC DISTANCE OF 246.44 FEET TO THE POINT OF COMPOUND CURVATURE OF A CURVE CONCAVE NORTHERLY AND HAVING A RADIUS OF 600.00 FEET; THENCE WESTERLY ALONG THE ARC OF SAID CURVE THROUGH A CENTRAL ANGLE OF 04°05'37", AN ARC DISTANCE OF 42.87 FEET TO THE POINT OF BEGINNING.

EXHIBIT A

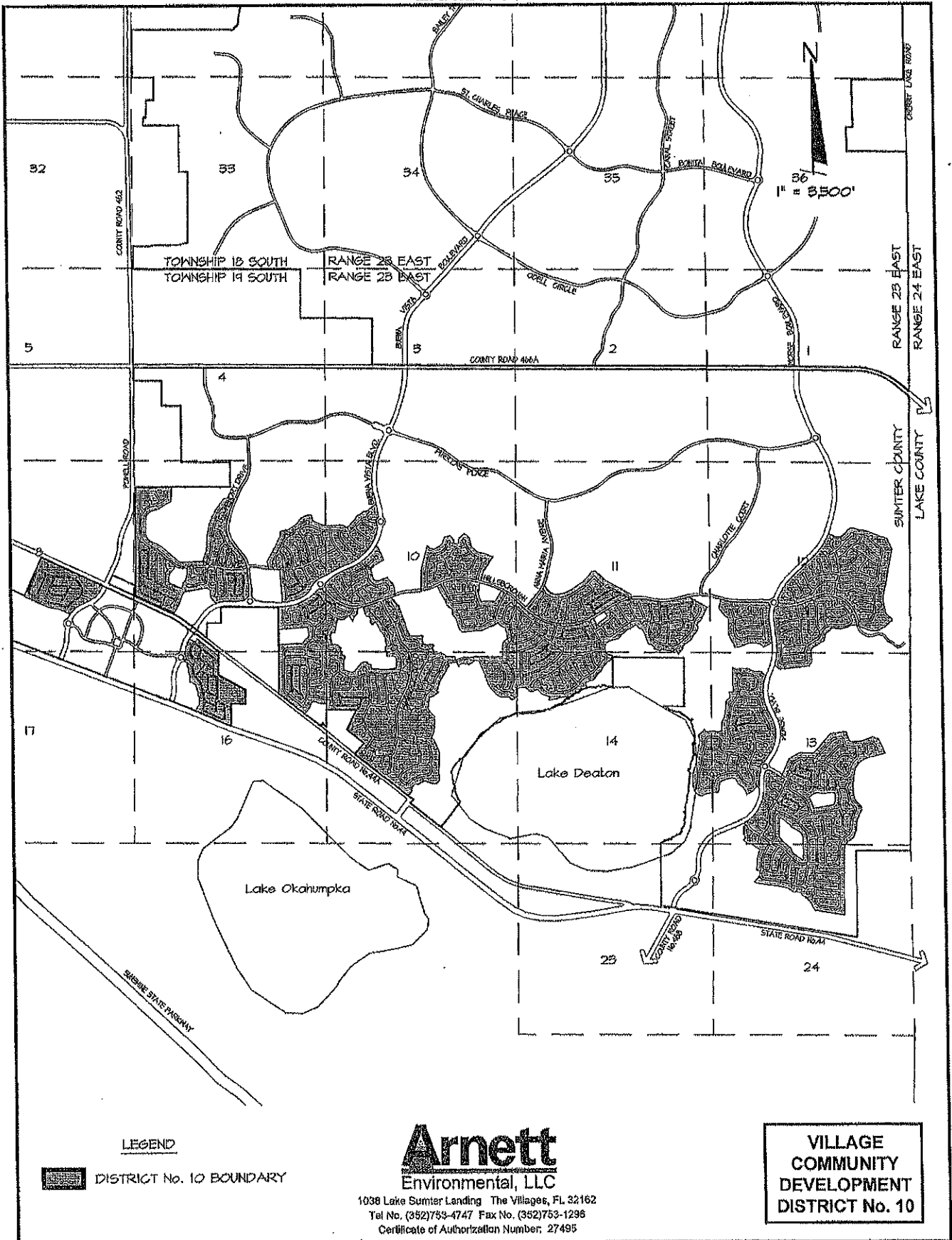

LEGEND



DISTRICT No. 10 BOUNDARY

Arnett
Environmental, LLC

1038 Lake Sumter Landing The Villages, FL 32162
Tel No. (352)753-4747 Fax No. (352)753-1298
Certificate of Authorization Number: 27495

VILLAGE
COMMUNITY
DEVELOPMENT
DISTRICT No. 10

AMENDED VILLAGE COMMUNITY DEVELOPMENT DISTRICT No. 10

EXHIBIT "6"

**DESCRIPTION OF THE AMENDED
VILLAGE COMMUNITY DEVELOPMENT DISTRICT NO. 10
APPROXIMATELY 1588.8 ACRES**

THAT LAND LYING IN SECTIONS 13 AND 14, TOWNSHIP 19 SOUTH, RANGE 23 EAST, SUMTER COUNTY, FLORIDA, DESCRIBED AS FOLLOWS:

FROM THE NORTHWEST CORNER OF THE NORTHWEST 1/4 OF SAID SECTION 13 RUN N89°59'36"E, ALONG THE NORTH LINE THEREOF A DISTANCE OF 685.41 FEET; THENCE DEPARTING SAID NORTH LINE, S00°00'24"E, 276.62 FEET TO THE POINT OF BEGINNING; THENCE S71°38'52"E, 117.18 FEET; THENCE N85°41'58"E, 263.57 FEET; THENCE S71°55'17"E, 231.83 FEET; THENCE S84°56'19"E, 207.88 FEET; THENCE S42°14'37"E, 118.03 FEET; THENCE S68°48'09"E, 45.00 FEET TO A POINT ON THE ARC OF A CURVE CONCAVE EASTERLY, HAVING A RADIUS OF 1,180.00 FEET AND A CHORD BEARING AND DISTANCE OF S02°01'26"E, 930.52 FEET; THENCE SOUTHERLY ALONG THE ARC OF SAID CURVE, THROUGH A CENTRAL ANGLE OF 46°26'35", A DISTANCE OF 956.49 FEET TO THE POINT OF TANGENCY; THENCE S25°14'44"E, 293.76 FEET TO THE POINT OF CURVATURE OF A CURVE CONCAVE WESTERLY AND HAVING A RADIUS OF 965.00 FEET; THENCE SOUTHERLY ALONG THE ARC THEREOF THROUGH A CENTRAL ANGLE OF 58°25'01", A DISTANCE OF 983.88 FEET TO THE POINT OF TANGENCY; THENCE S33°10'17"W, 269.17 FEET TO THE POINT OF CURVATURE OF A CURVE CONCAVE NORTHWESTERLY AND HAVING A RADIUS OF 75.00 FEET; THENCE SOUTHWESTERLY ALONG THE ARC OF SAID CURVE THROUGH A CENTRAL ANGLE OF 43°19'37", AN ARC DISTANCE OF 56.71 FEET TO THE POINT OF REVERSE CURVATURE OF A CURVE CONCAVE SOUTHEASTERLY AND HAVING A RADIUS OF 120.00 FEET; THENCE SOUTHWESTERLY ALONG THE ARC OF SAID CURVE THROUGH A CENTRAL ANGLE OF 100°54'55", AN ARC DISTANCE OF 211.36 FEET TO THE POINT OF REVERSE CURVATURE OF A CURVE CONCAVE WESTERLY AND HAVING A RADIUS OF 75.00 FEET; THENCE SOUTHERLY ALONG THE ARC OF SAID CURVE THROUGH A CENTRAL ANGLE OF 42°09'09", AN ARC DISTANCE OF 55.18 FEET TO THE POINT OF REVERSE CURVATURE OF A CURVE CONCAVE EASTERLY AND HAVING A RADIUS OF 960.00 FEET; THENCE SOUTHERLY ALONG THE ARC OF SAID CURVE THROUGH A CENTRAL ANGLE OF 15°28'35", AN ARC DISTANCE OF 259.31 FEET TO THE POINT OF TANGENCY; THENCE S02°15'33"W, 113.63 FEET; THENCE N87°44'27"W, 15.00 FEET; THENCE S35°44'11"W, 95.78 FEET; THENCE S39°43'04"W, 145.59 FEET; THENCE S60°16'41"W, 135.39 FEET; THENCE S63°44'54"W, 96.43 FEET; THENCE N17°16'18"W, 140.17 FEET; THENCE N33°53'06"W, 83.89 FEET; THENCE N60°55'56"W, 71.15 FEET; THENCE N48°37'44"W, 109.81 FEET; THENCE N12°51'35"W, 47.24 FEET; THENCE N34°12'57"W, 109.78 FEET; THENCE

N75°34'43"W, 74.67 FEET; THENCE S76°25'06"W, 103.42 FEET; THENCE S72°44'39"W, 112.98 FEET; THENCE S74°28'14"W, 79.24 FEET; THENCE S48°27'13"W, 102.14 FEET; THENCE S06°09'29"W, 215.22 FEET; THENCE S44°04'15"W, 47.45 FEET; THENCE S81°00'37"W, 294.88 FEET; THENCE S69°32'37"W, 157.90 FEET; THENCE N71°51'34"W, 90.25 FEET; THENCE N49°44'55"W, 103.23 FEET; THENCE N61°41'15"W, 18.94 FEET; THENCE N15°42'27"W, 120.81 FEET; THENCE N13°34'44"W, 112.11 FEET; THENCE N00°22'32"E, 118.49 FEET; THENCE N00°23'18"E, 122.08 FEET; THENCE N15°27'27"E, 132.06 FEET; THENCE N19°58'42"E, 168.83 FEET; THENCE N09°36'27"E, 550.16 FEET; THENCE N68°35'35"E, 18.77 FEET; THENCE N02°42'14"E, 100.48 FEET; THENCE N05°54'40"W, 60.24 FEET; THENCE N09°16'50"W, 105.66 FEET; THENCE N49°35'48"E, 181.51 FEET; THENCE N32°51'34"E, 52.84 FEET; THENCE S33°21'35"E, 89.12 FEET; THENCE N82°19'48"E, 172.42 FEET; THENCE S86°06'33"E, 68.58 FEET; THENCE S79°54'04"E, 114.12 FEET; THENCE N63°24'32"E, 86.65 FEET; THENCE N06°43'35"W, 105.84 FEET; THENCE N04°00'15"E, 109.06 FEET; THENCE N18°18'20"E, 88.25 FEET; THENCE N29°09'08"E, 71.94 FEET; THENCE N16°14'49"E, 81.21 FEET; THENCE N06°54'52"E, 83.53 FEET; THENCE N06°45'04"E, 239.64 FEET; THENCE N17°35'17"E, 101.72 FEET; THENCE N65°41'57"E, 40.79 FEET; THENCE N56°15'06"E, 72.93 FEET; THENCE N14°26'14"W, 133.21 FEET; THENCE N34°24'40"E, 18.30 FEET; THENCE N87°45'08"E, 99.10 FEET; THENCE N31°16'21"E, 51.69 FEET; THENCE N12°08'35"W, 122.55 FEET; THENCE N00°58'31"W, 500.97 FEET TO THE POINT OF BEGINNING.

AND

THAT LAND LYING IN SECTIONS 13 AND 24, TOWNSHIP 19 SOUTH, RANGE 23 EAST, SUMTER COUNTY, FLORIDA, DESCRIBED AS FOLLOWS:

FROM THE NORTHWEST CORNER OF THE NORTHEAST 1/4 OF SAID SECTION 13 RUN S00°32'59"W, ALONG THE WEST LINE THEREOF A DISTANCE OF 2,085.24 FEET; THENCE DEPARTING SAID WEST LINE, S89°27'01"E, 750.37 FEET TO THE POINT OF BEGINNING; THENCE N81°16'37"E, 422.90 FEET; THENCE S20°52'00"E, 295.98 FEET; THENCE S61°19'33"E, 16.72 FEET; THENCE S85°52'26"E, 67.80 FEET; THENCE S89°52'06"E, 67.79 FEET; THENCE N85°55'31"E, 67.79 FEET; THENCE N81°43'08"E, 67.79 FEET; THENCE N77°30'46"E, 67.79 FEET; THENCE N73°05'44"E, 74.58 FEET; THENCE N68°40'42"E, 67.79 FEET; THENCE N66°02'53"E, 124.73 FEET; THENCE N86°10'37"E, 62.08 FEET; THENCE S71°09'15"E, 143.36 FEET; THENCE S23°37'43"E, 433.58 FEET; THENCE S74°54'59"W, 482.83 FEET; THENCE S70°51'40"W, 97.67 FEET; THENCE S61°04'46"W, 116.04 FEET; THENCE S48°46'53"W, 116.92 FEET; THENCE S34°52'02"W, 117.08 FEET; THENCE S17°41'52"W, 88.22 FEET; THENCE S10°50'19"W, 135.92 FEET; THENCE S08°07'37"W, 143.87 FEET; THENCE S07°49'21"W, 108.77 FEET; THENCE

S02°07'34"W, 83.01 FEET; THENCE S03°20'47"E, 70.01 FEET; THENCE
 S04°28'36"E, 69.36 FEET; THENCE S08°42'45"E, 66.72 FEET; THENCE S14°55'53"E,
 66.72 FEET; THENCE S19°24'30"E, 69.18 FEET; THENCE S25°55'06"E, 62.23 FEET;
 THENCE S41°58'56"E, 63.40 FEET; THENCE S47°43'15"E, 106.18 FEET; THENCE
 S26°39'58"E, 64.83 FEET; THENCE S02°42'16"E, 70.21 FEET; THENCE
 S33°44'46"W, 104.79 FEET; THENCE S25°09'08"W, 70.02 FEET; THENCE
 S22°41'20"W, 70.02 FEET; THENCE S16°28'55"W, 62.19 FEET; THENCE
 S13°35'03"W, 70.20 FEET; THENCE S04°57'10"W, 137.18 FEET; THENCE
 S03°29'25"W, 75.05 FEET; THENCE S20°37'12"W, 92.16 FEET; THENCE
 S21°29'51"W, 124.32 FEET; THENCE S55°27'31"W, 140.75 FEET; THENCE
 S50°27'01"W, 64.17 FEET; THENCE S38°06'33"W, 75.60 FEET; THENCE
 S25°30'44"W, 65.53 FEET; THENCE S11°06'48"W, 67.07 FEET; THENCE
 S05°41'37"W, 71.90 FEET; THENCE S00°42'21"W, 1,765.51 FEET; THENCE
 N80°37'37"W, 831.28 FEET; THENCE N35°44'42"W, 76.51 FEET; THENCE
 N24°29'04"W, 67.35 FEET; THENCE N17°40'47"W, 66.54 FEET; THENCE
 N39°22'09"W, 94.71 FEET; THENCE N32°02'25"W, 90.58 FEET; THENCE
 N46°53'15"W, 63.31 FEET; THENCE N51°18'25"W, 151.90 FEET; THENCE
 N73°12'43"W, 150.49 FEET; THENCE S68°12'31"W, 75.77 FEET; THENCE
 N48°19'40"W, 161.12 FEET; THENCE N69°26'54"W, 66.17 FEET; THENCE
 N74°35'00"W, 66.25 FEET; THENCE N77°54'53"W, 66.39 FEET; THENCE
 N78°50'50"W, 69.56 FEET; THENCE N83°35'26"W, 140.70 FEET; THENCE
 N81°31'48"W, 73.08 FEET; THENCE N81°21'22"W, 391.38 FEET; THENCE
 N72°42'18"W, 104.48 FEET; THENCE N40°19'51"E, 222.65 FEET TO A POINT ON
 THE ARC OF A NON-TANGENT CURVE CONCAVE EASTERLY, HAVING A
 RADIUS OF 114.00 FEET AND A CHORD BEARING AND DISTANCE OF
 N03°00'28"E, 35.71 FEET; THENCE NORTHERLY ALONG THE ARC OF SAID
 CURVE, THROUGH A CENTRAL ANGLE OF 18°01'21", AN ARC DISTANCE OF
 35.86 FEET TO THE POINT OF TANGENCY; THENCE N12°01'08"E, 109.71 FEET;
 THENCE N77°58'52"W, 120.00 FEET; THENCE N11°07'17"E, 134.84 FEET;
 THENCE N00°02'24"W, 121.56 FEET; THENCE N06°32'41"E, 107.52 FEET;
 THENCE N18°02'41"E, 82.99 FEET; THENCE N21°15'01"E, 130.19 FEET; THENCE
 N57°21'32"W, 273.76 FEET; THENCE N78°39'03"W, 162.67 FEET; THENCE
 N34°46'52"W, 111.20 FEET; THENCE N37°11'13"E, 72.71 FEET; THENCE
 N14°31'46"W, 57.85 FEET; THENCE N26°35'17"W, 67.08 FEET; THENCE
 N10°14'17"E, 88.35 FEET; THENCE N08°30'15"W, 85.70 FEET; THENCE
 N45°23'38"E, 85.51 FEET; THENCE N29°31'47"W, 30.19 FEET TO THE POINT OF
 CURVATURE OF A CURVE CONCAVE SOUTHERLY AND HAVING A RADIUS
 OF 35.00 FEET; THENCE WESTERLY ALONG THE ARC OF SAID CURVE
 THROUGH A CENTRAL ANGLE OF 87°28'12", AN ARC DISTANCE OF 53.43
 FEET TO A POINT OF CUSP OF A CURVE CONCAVE NORTHWESTERLY,
 HAVING A RADIUS OF 1,060.00 FEET AND A CHORD BEARING AND
 DISTANCE OF N32°37'47"E, 1,071.85 FEET; THENCE NORTHEASTERLY ALONG
 THE ARC OF SAID CURVE, THROUGH A CENTRAL ANGLE OF 60°44'28", AN
 ARC DISTANCE OF 1,123.74 FEET TO THE POINT OF TANGENCY; THENCE
 N02°15'33"E, 309.25 FEET TO THE POINT OF CURVATURE OF A CURVE

CONCAVE EASTERLY AND HAVING A RADIUS OF 840.00 FEET; THENCE NORTHERLY ALONG THE ARC OF SAID CURVE THROUGH A CENTRAL ANGLE OF 14°06'33", AN ARC DISTANCE OF 206.85 FEET TO THE POINT OF COMPOUND CURVATURE OF A CURVE CONCAVE SOUTHEASTERLY AND HAVING A RADIUS OF 75.00 FEET; THENCE NORTHEASTERLY ALONG THE ARC OF SAID CURVE THROUGH A CENTRAL ANGLE OF 51°14'55", AN ARC DISTANCE OF 67.08 FEET TO THE POINT OF REVERSE CURVATURE OF A CURVE CONCAVE NORTHWESTERLY AND HAVING A RADIUS OF 120.00 FEET; THENCE NORTHEASTERLY ALONG THE ARC OF SAID CURVE THROUGH A CENTRAL ANGLE OF 08°08'52", AN ARC DISTANCE OF 17.06 FEET TO THE POINT OF REVERSE CURVATURE OF A CURVE CONCAVE SOUTHERLY AND HAVING A RADIUS OF 75.00 FEET; THENCE EASTERLY ALONG THE ARC OF SAID CURVE THROUGH A CENTRAL ANGLE OF 52°16'59", AN ARC DISTANCE OF 68.44 FEET TO THE POINT OF COMPOUND CURVATURE OF A CURVE CONCAVE SOUTHWESTERLY AND HAVING A RADIUS OF 904.90 FEET; THENCE SOUTHEASTERLY ALONG THE ARC OF SAID CURVE THROUGH A CENTRAL ANGLE OF 17°13'09", AN ARC DISTANCE OF 271.95 FEET TO THE POINT OF TANGENCY; THENCE S53°12'08"E, 79.42 FEET TO A POINT ON THE ARC OF A NON-TANGENT CURVE CONCAVE NORTHEASTERLY, HAVING A RADIUS OF 270.00 FEET AND A CHORD BEARING AND DISTANCE OF S55°20'39"E, 18.65 FEET; THENCE SOUTHEASTERLY ALONG THE ARC OF SAID CURVE, THROUGH A CENTRAL ANGLE OF 03°57'27", AN ARC DISTANCE OF 18.65 FEET TO A NON-TANGENT LINE; THENCE N32°46'33"E, 70.26 FEET; THENCE N23°32'59"E, 373.81 FEET; THENCE N23°55'34"E, 108.75 FEET; THENCE N60°15'21"E, 338.01 FEET; THENCE S88°21'24"E, 225.12 FEET; THENCE S86°20'12"E, 154.62 FEET; THENCE N44°09'39"E, 283.40 FEET; THENCE N41°21'17"E, 455.96 FEET TO THE POINT OF BEGINNING.

LESS

THAT LAND LYING IN SECTION 13, TOWNSHIP 19 SOUTH, RANGE 23 EAST, SUMTER COUNTY, FLORIDA, DESCRIBED AS FOLLOWS:

FROM THE NORTHWEST CORNER OF THE NORTHEAST 1/4 OF SAID SECTION 13 RUN S00°32'59"W, ALONG THE WEST LINE THEREOF A DISTANCE OF 3,848.21 FEET; THENCE DEPARTING SAID WEST LINE, S89°27'01"E, 133.51 FEET TO THE POINT OF BEGINNING; THENCE N55°28'46"E, 133.48 FEET; THENCE N59°56'30"E, 85.74 FEET; THENCE S89°28'42"E, 71.54 FEET; THENCE S80°59'11"E, 110.88 FEET; THENCE N89°10'58"E, 74.03 FEET; THENCE N82°45'00"E, 187.42 FEET; THENCE N86°41'57"E, 70.04 FEET; THENCE S24°50'07"E, 69.19 FEET; THENCE S06°59'32"E, 60.64 FEET; THENCE S07°05'36"W, 73.71 FEET; THENCE S07°48'35"W, 70.29 FEET; THENCE S07°20'03"W, 76.22 FEET; THENCE S80°27'40"W, 575.96 FEET; THENCE N19°54'32"W, 211.18 FEET; THENCE N30°08'32"W, 125.97 FEET TO THE POINT OF BEGINNING.

ALSO LESS

THAT LAND LYING IN SECTIONS 13 AND 24, TOWNSHIP 19 SOUTH, RANGE 23 EAST, SUMTER COUNTY, FLORIDA, DESCRIBED AS FOLLOWS:

FROM THE NORTHWEST CORNER OF THE NORTHEAST 1/4 OF SAID SECTION 13 RUN S00°32'59"W, ALONG THE WEST LINE THEREOF A DISTANCE OF 4,887.27 FEET; THENCE DEPARTING SAID WEST LINE, N89°27'01"W, 53.44 FEET TO THE POINT OF BEGINNING; THENCE S17°18'17"E, 45.75 FEET; THENCE S03°59'24"W, 26.83 FEET; THENCE S00°09'19"E, 61.33 FEET; THENCE S04°17'50"E, 52.98 FEET; THENCE S00°07'19"E, 157.28 FEET; THENCE S05°35'11"E, 201.59 FEET; THENCE S48°58'03"W, 32.42 FEET; THENCE S08°52'51"E, 119.45 FEET; THENCE S54°30'43"W, 34.56 FEET; THENCE N53°47'59"W, 318.37 FEET; THENCE N25°27'17"W, 103.65 FEET; THENCE N29°47'43"W, 80.27 FEET; THENCE N49°46'07"W, 171.33 FEET; THENCE N56°16'41"W, 69.53 FEET; THENCE N31°40'04"W, 53.75 FEET; THENCE N42°52'01"W, 120.75 FEET; THENCE N00°56'19"E, 535.79 FEET; THENCE S79°32'13"E, 85.11 FEET; THENCE S51°31'58"E, 91.24 FEET; THENCE S47°20'13"E, 68.71 FEET; THENCE S52°56'00"E, 108.10 FEET; THENCE S29°50'26"E, 85.29 FEET; THENCE S66°28'45"E, 73.32 FEET; THENCE S63°56'25"E, 65.40 FEET; THENCE S50°36'43"E, 67.65 FEET; THENCE S54°21'09"E, 82.74 FEET; THENCE S39°05'30"E, 79.33 FEET TO THE POINT OF BEGINNING.

AND

THAT LAND LYING IN SECTION 12, TOWNSHIP 19 SOUTH, RANGE 23 EAST, SUMTER COUNTY, FLORIDA, DESCRIBED AS FOLLOWS:

FROM THE SOUTHWEST CORNER OF THE SOUTHWEST 1/4 OF SAID SECTION 12 RUN N00°36'40"E, ALONG THE WEST LINE THEREOF A DISTANCE OF 745.05 FEET; THENCE DEPARTING SAID WEST LINE, S89°23'20"E, 568.49 FEET TO THE POINT OF BEGINNING; THENCE N07°44'55"E, 269.20 FEET; THENCE N19°31'55"W, 110.04 FEET; THENCE N53°22'29"W, 117.42 FEET; THENCE N36°50'34"W, 254.12 FEET; THENCE N15°35'13"E, 245.23 FEET; THENCE S75°00'58"E, 131.24 FEET TO THE POINT OF CURVATURE OF A CURVE CONCAVE NORTH AND HAVING A RADIUS OF 1,230.00 FEET; THENCE EASTERLY ALONG THE ARC OF SAID CURVE THROUGH A CENTRAL ANGLE OF 14°25'28", AN ARC DISTANCE OF 309.66 FEET TO THE POINT OF TANGENCY; THENCE S89°26'26"E, 716.10 FEET TO THE POINT OF CURVATURE OF A CURVE CONCAVE SOUTH AND HAVING A RADIUS OF 35.00 FEET; THENCE EASTERLY ALONG THE ARC OF SAID CURVE THROUGH A CENTRAL ANGLE OF 30°47'39", AN ARC DISTANCE OF 18.81 FEET TO THE POINT OF REVERSE CURVATURE OF A CURVE CONCAVE NORTH AND HAVING A RADIUS OF 52.00 FEET; THENCE EASTERLY ALONG THE ARC OF SAID CURVE THROUGH A CENTRAL ANGLE OF 63°35'32", AN ARC DISTANCE

OF 57.71 FEET TO THE POINT OF REVERSE CURVATURE OF A CURVE CONCAVE SOUTH AND HAVING A RADIUS OF 18.00 FEET; THENCE EASTERLY ALONG THE ARC OF SAID CURVE THROUGH A CENTRAL ANGLE OF $36^{\circ}49'33''$, AN ARC DISTANCE OF 11.57 FEET TO THE POINT OF COMPOUND CURVATURE OF A CURVE CONCAVE SOUTH AND HAVING A RADIUS OF 871.00 FEET; THENCE EASTERLY ALONG THE ARC OF SAID CURVE THROUGH A CENTRAL ANGLE OF $04^{\circ}12'21''$, AN ARC DISTANCE OF 63.94 FEET TO THE POINT OF COMPOUND CURVATURE OF A CURVE CONCAVE SOUTHWEST AND HAVING A RADIUS OF 50.00 FEET; THENCE SOUTHEASTERLY ALONG THE ARC OF SAID CURVE THROUGH A CENTRAL ANGLE OF $67^{\circ}37'38''$, AN ARC DISTANCE OF 59.02 FEET TO THE POINT OF REVERSE CURVATURE OF A CURVE CONCAVE NORTHEAST AND HAVING A RADIUS OF 131.00 FEET; THENCE SOUTHEASTERLY ALONG THE ARC OF SAID CURVE THROUGH A CENTRAL ANGLE OF $19^{\circ}37'45''$, AN ARC DISTANCE OF 44.88 FEET TO THE POINT OF REVERSE CURVATURE OF A CURVE CONCAVE WEST AND HAVING A RADIUS OF 50.00 FEET; THENCE SOUTHERLY ALONG THE ARC OF SAID CURVE THROUGH A CENTRAL ANGLE OF $48^{\circ}40'28''$, AN ARC DISTANCE OF 42.48 FEET TO THE POINT OF REVERSE CURVATURE OF A CURVE CONCAVE EAST AND HAVING A RADIUS OF 1,035.00 FEET; THENCE SOUTHERLY ALONG THE ARC OF SAID CURVE THROUGH A CENTRAL ANGLE OF $22^{\circ}24'52''$, AN ARC DISTANCE OF 404.90 FEET TO THE POINT OF TANGENCY; THENCE $S06^{\circ}56'54''E$, 544.34 FEET TO THE POINT OF CURVATURE OF A CURVE CONCAVE WEST AND HAVING A RADIUS OF 1,545.00 FEET; THENCE SOUTHERLY ALONG THE ARC OF SAID CURVE THROUGH A CENTRAL ANGLE OF $02^{\circ}32'48''$, AN ARC DISTANCE OF 68.67 FEET TO A NON-TANGENT LINE; THENCE $S85^{\circ}35'54''W$, 45.00 FEET; THENCE $S62^{\circ}59'18''W$, 152.18 FEET; THENCE $N71^{\circ}55'54''W$, 267.65 FEET; THENCE $N89^{\circ}22'47''W$, 179.79 FEET; THENCE $S76^{\circ}18'52''W$, 424.63 FEET; THENCE $N29^{\circ}53'57''W$, 208.73 FEET; THENCE $N20^{\circ}11'12''W$, 264.68 FEET TO THE POINT OF BEGINNING.

AND

THAT LAND LYING IN SECTIONS 12 AND 13, TOWNSHIP 19 SOUTH, RANGE 23 EAST, SUMTER COUNTY, FLORIDA, DESCRIBED AS FOLLOWS:

FROM THE SOUTHWEST CORNER OF THE SOUTHEAST $1/4$ OF SAID SECTION 12 RUN $N00^{\circ}35'56''E$, ALONG THE WEST LINE THEREOF A DISTANCE OF 476.94 FEET; THENCE DEPARTING SAID WEST LINE, $S89^{\circ}24'04''E$, 589.10 FEET TO THE POINT OF BEGINNING; THENCE $S58^{\circ}49'35''W$, 292.97 FEET; THENCE $S58^{\circ}48'19''W$, 72.14 FEET; THENCE $S43^{\circ}21'10''W$, 63.97 FEET; THENCE $S17^{\circ}46'02''W$, 62.84 FEET; THENCE $S04^{\circ}21'25''E$, 69.62 FEET; THENCE $S05^{\circ}39'12''E$, 223.76 FEET; THENCE $S34^{\circ}32'53''W$, 127.82 FEET; THENCE $S82^{\circ}40'40''W$, 468.80 FEET; THENCE $S84^{\circ}58'32''W$, 363.54 FEET; THENCE $N51^{\circ}44'32''W$, 165.27 FEET; THENCE $N73^{\circ}02'31''W$, 15.00 FEET TO A POINT ON

THE ARC OF A CURVE CONCAVE WESTERLY, HAVING A RADIUS OF 1,665.00 FEET AND A CHORD BEARING AND DISTANCE OF N05°00'17"E, 689.69 FEET; THENCE NORTHERLY ALONG THE ARC OF SAID CURVE, THROUGH A CENTRAL ANGLE OF 23°54'23", A DISTANCE OF 694.71 FEET TO THE POINT OF TANGENCY; THENCE N06°56'54"W, 544.34 FEET TO THE POINT OF CURVATURE OF A CURVE CONCAVE EASTERLY AND HAVING A RADIUS OF 915.00 FEET; THENCE NORTHERLY ALONG THE ARC THEREOF THROUGH A CENTRAL ANGLE OF 21°27'04", A DISTANCE OF 342.57 FEET TO THE POINT OF COMPOUND CURVATURE OF A CURVE CONCAVE SOUTHEASTERLY AND HAVING A RADIUS OF 50.00 FEET; THENCE NORTHEASTERLY ALONG THE ARC OF SAID CURVE THROUGH A CENTRAL ANGLE OF 57°11'49", A DISTANCE OF 49.91 FEET TO THE POINT OF REVERSE CURVATURE OF A CURVE CONCAVE NORTHWESTERLY AND HAVING A RADIUS OF 131.00 FEET; THENCE NORTHEASTERLY AND NORTHWESTERLY ALONG THE ARC OF SAID CURVE THROUGH A CENTRAL ANGLE OF 99°55'42", A DISTANCE OF 228.47 FEET TO THE POINT OF REVERSE CURVATURE OF A CURVE CONCAVE EASTERLY AND HAVING A RADIUS OF 50.00 FEET; THENCE NORTHERLY ALONG THE ARC OF SAID CURVE THROUGH A CENTRAL ANGLE OF 52°37'25", A DISTANCE OF 45.92 FEET TO THE POINT OF TANGENCY; THENCE N24°23'42"E, 125.50 FEET TO THE POINT OF CURVATURE OF A CURVE CONCAVE SOUTHEASTERLY AND HAVING A RADIUS OF 1,515.00 FEET; THENCE NORTHEASTERLY ALONG THE ARC THEREOF THROUGH A CENTRAL ANGLE OF 21°44'11", A DISTANCE OF 574.75 FEET TO THE POINT OF TANGENCY; THENCE N46°07'53"E, 902.91 FEET TO THE POINT OF CURVATURE OF A CURVE CONCAVE NORTHWESTERLY AND HAVING A RADIUS OF 1,665.00 FEET; THENCE NORTHEASTERLY ALONG THE ARC THEREOF THROUGH A CENTRAL ANGLE OF 25°26'35", A DISTANCE OF 739.37 FEET TO A NON-TANGENT LINE; THENCE S69°18'42"E, 15.00 FEET; THENCE S60°23'00"E, 171.84 FEET; THENCE S81°16'42"E, 70.64 FEET; THENCE N83°48'51"E, 114.45 FEET; THENCE N53°47'01"E, 130.77 FEET; THENCE N37°55'06"E, 72.19 FEET; THENCE N40°18'09"E, 46.52 FEET; THENCE N46°18'17"E, 96.08 FEET; THENCE S85°17'01"E, 90.89 FEET; THENCE S71°44'55"E, 142.63 FEET; THENCE S82°46'08"E, 210.00 FEET; THENCE S84°18'10"E, 216.64 FEET; THENCE S39°52'52"E, 128.12 FEET; THENCE S01°46'31"E, 106.49 FEET; THENCE S51°00'49"E, 381.84 FEET; THENCE S11°39'20"W, 320.20 FEET; THENCE S10°36'27"W, 138.30 FEET; THENCE S09°14'51"W, 286.71 FEET; THENCE S07°37'20"W, 261.56 FEET; THENCE S40°58'48"W, 174.73 FEET; THENCE S10°05'29"E, 193.56 FEET; THENCE S00°02'41"W, 77.54 FEET; THENCE S12°33'56"W, 66.94 FEET; THENCE S06°50'45"W, 67.13 FEET; THENCE S10°03'33"E, 158.96 FEET; THENCE S01°31'30"E, 92.18 FEET; THENCE S17°45'02"W, 92.10 FEET; THENCE S20°41'45"W, 71.44 FEET; THENCE S10°09'14"W, 71.20 FEET; THENCE S00°29'31"E, 270.53 FEET; THENCE S38°43'19"W, 169.92 FEET TO A POINT ON THE ARC OF A CURVE CONCAVE NORTHERLY, HAVING A RADIUS OF 250.00 FEET AND A CHORD BEARING AND DISTANCE OF S74°56'01"W, 74.22 FEET;

THENCE WESTERLY ALONG THE ARC OF SAID CURVE, THROUGH A CENTRAL ANGLE OF 17°04'21", AN ARC DISTANCE OF 74.49 FEET TO THE POINT OF COMPOUND CURVATURE OF A CURVE CONCAVE NORTHERLY AND HAVING A RADIUS OF 325.00 FEET; THENCE WESTERLY ALONG THE ARC OF SAID CURVE THROUGH A CENTRAL ANGLE OF 25°43'38", AN ARC DISTANCE OF 145.93 FEET TO A NON-TANGENT LINE; THENCE N04°31'14"W, 219.19 FEET; THENCE N61°32'20"W, 46.18 FEET; THENCE S83°52'57"W, 66.01 FEET; THENCE S80°03'32"W, 80.94 FEET; THENCE S87°58'35"W, 54.13; THENCE N85°07'48"W, 283.15 FEET; THENCE S87°52'41"W, 61.85 FEET; THENCE S62°03'22"W, 70.42 FEET; THENCE S50°32'20"W, 71.28 FEET; THENCE S30°36'15"W, 70.66 FEET; THENCE S06°00'09"W, 55.83 FEET; THENCE S16°20'16"W, 96.49 FEET TO THE POINT OF BEGINNING.

AND

THAT LAND LYING IN SECTIONS 9, 10, 11, 12, 14, 15 AND 16, TOWNSHIP 19 SOUTH, RANGE 23 EAST, SUMTER COUNTY, FLORIDA, DESCRIBED AS FOLLOWS:

FROM THE SOUTHEAST CORNER OF THE SOUTHWEST 1/4 OF SAID SECTION 11 RUN N00°35'25"E, ALONG THE EAST LINE THEREOF A DISTANCE OF 45.37 FEET; THENCE DEPARTING SAID EAST LINE, N89°24'35"W, 13.35 FEET TO THE POINT OF BEGINNING; THENCE S22°44'15"W, 156.06 FEET; THENCE S61°37'20"W, 104.64 FEET; THENCE S41°37'31"W, 109.38 FEET; THENCE S29°46'13"W, 152.95 FEET; THENCE S46°18'11"W, 159.89 FEET; THENCE S32°51'36"W, 114.69 FEET; THENCE S63°26'44"W, 292.14 FEET; THENCE S17°03'25"E, 129.00 FEET; THENCE S71°04'16"W, 194.72 FEET; THENCE S32°09'31"W, 64.87 FEET; THENCE S67°48'07"W, 142.86 FEET; THENCE S54°08'44"W, 128.90 FEET; THENCE S84°18'31"W, 293.92 FEET; THENCE S77°06'26"W, 307.21 FEET; THENCE N05°51'03"E, 83.40 FEET; THENCE N69°56'47"W, 210.30 FEET; THENCE N44°32'14"W, 201.43 FEET; THENCE S56°58'45"W, 124.42 FEET; THENCE N84°44'29"W, 110.41 FEET; THENCE N44°35'47"W, 152.99 FEET; THENCE S82°19'45"W, 239.45 FEET; THENCE S00°35'41"W, 219.25 FEET; THENCE S82°41'11"W, 61.73 FEET; THENCE S16°56'33"W, 52.09 FEET; THENCE S75°04'01"W, 94.45 FEET; THENCE N32°23'35"W, 87.60 FEET; THENCE N72°09'54"W, 141.48 FEET; THENCE S68°33'23"W, 82.36 FEET; THENCE N73°07'27"W, 109.23 FEET; THENCE N48°49'49"W, 107.83 FEET; THENCE N41°52'00"W, 75.64 FEET; THENCE N39°15'00"W, 231.45 FEET; THENCE N18°58'33"W, 413.10 FEET; THENCE N24°05'29"W, 215.61 FEET; THENCE N35°06'16"W, 73.32 FEET; THENCE S81°27'38"W, 128.62 FEET; THENCE S57°06'54"W, 102.00 FEET; THENCE N89°26'50"W, 92.95 FEET; THENCE N82°33'56"W, 75.54 FEET; THENCE S83°16'39"W, 57.76 FEET; THENCE S67°04'25"W, 141.18 FEET; THENCE N23°01'28"W, 106.48 FEET TO A POINT ON THE ARC OF A NON-TANGENT CURVE CONCAVE NORTHERLY, HAVING A RADIUS OF 205.00 FEET AND A

CHORD BEARING AND DISTANCE OF S76°46'40"W, 69.80 FEET; THENCE WESTERLY ALONG THE ARC OF SAID CURVE, THROUGH A CENTRAL ANGLE OF 19°36'15", AN ARC DISTANCE OF 70.14 FEET TO THE POINT OF TANGENCY; THENCE S86°34'48"W, 170.39 FEET TO THE POINT OF CURVATURE OF A CURVE CONCAVE NORTHERLY AND HAVING A RADIUS OF 205.00 FEET; THENCE WESTERLY ALONG THE ARC OF SAID CURVE THROUGH A CENTRAL ANGLE OF 03°01'12", AN ARC DISTANCE OF 10.81 FEET TO A NON-TANGENT LINE; THENCE S15°14'57"E, 94.67 FEET; THENCE S50°21'32"W, 56.88 FEET; THENCE S25°29'20"W, 173.91 FEET; THENCE S33°58'25"W, 80.12 FEET; THENCE S30°54'02"W, 150.00 FEET; THENCE S27°52'22"W, 63.26 FEET; THENCE S16°25'31"W, 251.31 FEET; THENCE S48°06'08"W, 171.32 FEET; THENCE S54°29'10"W, 93.34 FEET; THENCE S14°58'35"W, 134.81 FEET; THENCE S10°49'29"W, 108.67 FEET; THENCE S07°36'11"E, 48.92 FEET; THENCE S29°50'04"E, 162.58 FEET; THENCE S44°29'27"E, 131.46 FEET; THENCE S05°27'32"W, 248.07 FEET; THENCE S09°54'40"W, 100.04 FEET; THENCE S07°13'43"W, 244.17 FEET; THENCE S36°49'11"E, 38.41 FEET; THENCE S25°06'19"E, 143.86 FEET; THENCE S11°38'38"E, 113.99 FEET; THENCE S11°59'10"E, 128.94 FEET; THENCE S04°22'02"E, 138.96 FEET; THENCE S11°01'23"W, 107.66 FEET; THENCE S03°36'32"W, 158.41 FEET; THENCE S30°19'46"E, 81.19 FEET; THENCE S00°28'23"W, 93.79 FEET; THENCE S03°34'15"E, 238.17 FEET; THENCE S38°08'23"W, 78.25 FEET; THENCE S78°22'55"W, 11.45 FEET; THENCE N77°44'00"W, 354.38 FEET; THENCE S69°00'34"W, 111.59 FEET; THENCE S51°31'59"E, 10.17 FEET; THENCE S28°03'05"W, 43.86 FEET; THENCE S61°48'15"W, 29.59 FEET; THENCE N87°02'07"W, 46.89 FEET; THENCE N81°48'57"W, 61.64 FEET; THENCE S37°07'08"W, 49.20 FEET; THENCE S47°02'34"W, 83.85 FEET; THENCE S00°57'17"E, 102.17 FEET; THENCE S38°29'44"W, 159.82 FEET TO THE NORTHERLY RIGHT OF WAY LINE OF COUNTY ROAD 44-A; (THE FOLLOWING 3 COURSES BEING ALONG SAID NORTHERLY RIGHT OF WAY LINE OF COUNTY ROAD 44-A); THENCE N51°30'16"W, 839.64 FEET; THENCE S38°29'44"W, 10.95 FEET; THENCE N51°31'59"W, 1,009.67 FEET TO A POINT ON THE WESTERLY LINE OF PROPERTY DESCRIBED IN OFFICIAL RECORDS BOOK 450, PAGE 628, PUBLIC RECORDS OF SUMTER COUNTY, FLORIDA; THENCE ALONG SAID WESTERLY LINE RUN N38°28'15"E, 397.15 FEET TO THE NORTHEAST CORNER OF A FIVE (5)-ACRE PARCEL AS DESCRIBED IN O.R. BOOK 2453, PAGE 196, PUBLIC RECORDS OF SUMTER COUNTY, FLORIDA; THENCE ALONG THE NORTHERLY BOUNDARY OF SAID PARCEL, RUN N51°33'06"W A DISTANCE OF 601.12 FEET, MORE OR LESS, TO THE NORTHWEST CORNER OF SAID FIVE (5)-ACRE PARCEL AND A POINT ON THE EASTERLY LINE OF PROPERTY DESCRIBED IN OFFICIAL RECORDS BOOK 1106, PAGE 84, PUBLIC RECORDS OF SUMTER COUNTY, FLORIDA; THENCE ALONG THE EASTERLY LINE OF AFORESAID PROPERTY RUN N27°04'17"E A DISTANCE OF 608.73 FEET TO A CONCRETE MONUMENT AT THE NORTHEAST CORNER OF AFORESAID PROPERTY; THENCE RUN N89°24'11"W, ALONG THE NORTH LINE OF

AFORESAID PROPERTY AND THE NORTH LINE OF PROPERTY DESCRIBED IN OFFICIAL RECORDS BOOK 1106, PAGE 60, PUBLIC RECORDS OF SUMTER COUNTY, FLORIDA A DISTANCE OF 840.28 FEET TO A POINT ON THE WEST LINE OF THE NORTHWEST 1/4 OF SAID SECTION 15; THENCE N00°34'50"E, ALONG SAID WEST LINE A DISTANCE OF 162.91 FEET; THENCE DEPARTING SAID WEST LINE N88°06'37"W, 64.96 FEET; THENCE N82°23'33"W, 25.70 FEET; THENCE S89°19'26"W, 82.69 FEET; THENCE N67°41'17"W, 128.21 FEET; THENCE N87°23'08"W, 65.24 FEET; THENCE S61°35'59"W, 29.56 FEET; THENCE S58°25'59"W, 52.51 FEET; THENCE S09°06'25"W, 83.13 FEET; THENCE S31°11'44"W, 87.63 FEET; THENCE S39°12'06"W, 169.84 FEET TO A POINT ON THE NORTH RIGHT OF WAY LINE OF COUNTY ROAD NO. 44A, MAINTENANCE ONLY, RECORDED IN RIGHT OF WAY MAP BOOK 4, PAGES 117 THROUGH 124, PUBLIC RECORDS OF SUMTER COUNTY, FLORIDA; (THE FOLLOWING 5 COURSES BEING ALONG SAID NORTH RIGHT OF WAY LINE OF COUNTY ROAD NO. 44A); THENCE N52°00'04"W, 210.02 FEET; THENCE N52°08'21"W, 384.83 FEET; THENCE N51°21'05"W, 50.58 FEET; THENCE N52°14'51"W, 162.73 FEET; THENCE N51°58'45"W, 100.32 FEET TO A POINT ON THE WEST LINE OF THE NORTHEAST 1/4 OF THE NORTHEAST 1/4 OF SAID SECTION 16; THENCE N00°35'25"E, ALONG SAID WEST LINE A DISTANCE OF 1,048.93 FEET TO THE SOUTHWEST CORNER OF SOUTHEAST 1/4 OF THE SOUTHEAST 1/4 OF SAID SECTION 9; THENCE N00°31'22"E, ALONG THE WEST LINE THEREOF A DISTANCE OF 290.29 FEET; THENCE DEPARTING SAID WEST LINE N84°53'36"E, 516.06 FEET; THENCE S88°20'11"E, 150.28 FEET; THENCE N38°13'36"E, 96.82 FEET; THENCE N44°40'37"E, 37.79 FEET; THENCE N51°35'50"E, 42.02 FEET; THENCE N54°18'28"E, 55.14 FEET; THENCE N22°50'34"E, 41.06 FEET; THENCE N06°34'37"W, 188.74 FEET; THENCE N22°09'55"W, 56.93 FEET; THENCE N86°07'53"W, 59.27 FEET; THENCE S85°45'04"W, 740.23 FEET TO SAID WEST LINE; THENCE N00°31'22"E, ALONG SAID WEST LINE A DISTANCE OF 624.35 FEET; THENCE DEPARTING SAID WEST LINE S89°36'29"E, 73.50 FEET TO THE POINT OF CURVATURE OF A CURVE CONCAVE NORTHWESTERLY AND HAVING A RADIUS OF 1,340.00 FEET; THENCE NORTHEASTERLY ALONG THE ARC OF SAID CURVE THROUGH A CENTRAL ANGLE OF 49°55'13", AN ARC DISTANCE OF 1,167.50 FEET TO THE POINT OF REVERSE CURVATURE OF A CURVE CONCAVE SOUTHERLY AND HAVING A RADIUS OF 49.00 FEET; THENCE EASTERLY ALONG THE ARC OF SAID CURVE THROUGH A CENTRAL ANGLE OF 57°21'35", AN ARC DISTANCE OF 49.05 FEET TO THE POINT OF REVERSE CURVATURE OF A CURVE CONCAVE NORTHWESTERLY AND HAVING A RADIUS OF 131.00 FEET; THENCE NORTHEASTERLY ALONG THE ARC OF SAID CURVE THROUGH A CENTRAL ANGLE OF 94°47'52", AN ARC DISTANCE OF 216.74 FEET TO THE POINT OF REVERSE CURVATURE OF A CURVE CONCAVE SOUTHEASTERLY AND HAVING A RADIUS OF 94.00 FEET; THENCE NORTHEASTERLY ALONG THE ARC OF SAID CURVE THROUGH A CENTRAL ANGLE OF 46°48'29", AN ARC DISTANCE OF 76.79 FEET TO THE POINT OF TANGENCY; THENCE N49°50'30"E, 137.13 FEET TO THE POINT OF

CURVATURE OF A CURVE CONCAVE SOUTHEASTERLY AND HAVING A RADIUS OF 1,450.00 FEET; THENCE NORTHEASTERLY ALONG THE ARC OF SAID CURVE THROUGH A CENTRAL ANGLE OF 22°01'14", AN ARC DISTANCE OF 557.28 FEET TO THE POINT OF REVERSE CURVATURE OF A CURVE CONCAVE NORTHWESTERLY AND HAVING A RADIUS OF 1,460.00 FEET; THENCE NORTHEASTERLY ALONG THE ARC OF SAID CURVE THROUGH A CENTRAL ANGLE OF 41°00'07", AN ARC DISTANCE OF 1,044.81 FEET TO A NON-TANGENT LINE; THENCE S59°08'23"E, 84.35 FEET; THENCE S22°28'26"E, 57.09 FEET; THENCE S22°11'04"E, 97.35 FEET; THENCE S23°15'13"E, 202.42 FEET; THENCE S20°01'16"E, 25.13 FEET; THENCE S63°44'08"W, 259.71 FEET; THENCE S47°00'21"W, 147.01 FEET; THENCE S65°34'15"W, 25.92 FEET; THENCE S11°43'15"E, 88.34 FEET; THENCE S13°37'17"E, 169.00 FEET; THENCE S24°23'32"E, 65.71 FEET; THENCE S60°34'11"E, 62.54 FEET; THENCE S87°43'07"E, 54.95 FEET; THENCE N70°41'54"E, 288.94 FEET; THENCE S08°09'53"E, 29.80 FEET; THENCE S41°56'49"E, 186.34 FEET; THENCE S23°06'11"E, 120.19 FEET; THENCE S03°08'54"E, 152.95 FEET; THENCE S19°31'21"E, 84.82 FEET; THENCE S70°28'39"W, 131.54 FEET; THENCE S40°21'51"E, 317.90 FEET; THENCE S19°31'21"E, 868.75 FEET; THENCE N88°46'58"E, 361.64 FEET; THENCE S08°14'16"W, 47.92 FEET; THENCE S06°38'15"W, 94.43 FEET; THENCE S17°15'31"E, 101.06 FEET; THENCE S73°54'23"E, 109.77 FEET; THENCE N80°45'01"E, 97.88 FEET; THENCE S80°56'14"E, 65.43 FEET; THENCE S36°58'02"E, 16.49 FEET; THENCE S23°37'26"W, 80.48 FEET; THENCE S27°45'33"E, 95.60 FEET; THENCE S11°50'21"W, 73.32 FEET; THENCE N85°07'15"E, 91.30 FEET; THENCE N79°18'45"E, 120.66 FEET; THENCE S66°27'40"E, 90.17 FEET; THENCE S37°00'10"E, 86.86 FEET TO THE SOUTH LINE OF THE SOUTHEAST 1/4 OF SAID SECTION 10; THENCE S89°28'25"E, ALONG SAID SOUTH LINE A DISTANCE OF 260.25 FEET; THENCE DEPARTING SAID SOUTH LINE S03°25'12"E, 107.34 FEET TO A POINT ON THE ARC OF A NON-TANGENT CURVE CONCAVE NORTHERLY, HAVING A RADIUS OF 155.00 FEET AND A CHORD BEARING AND DISTANCE OF N69°14'30"E, 27.36 FEET; THENCE EASTERLY ALONG THE ARC OF SAID CURVE, THROUGH A CENTRAL ANGLE OF 10°07'30", AN ARC DISTANCE OF 27.39 FEET TO THE POINT OF TANGENCY; THENCE N64°10'45"E, 114.80 FEET TO THE POINT OF CURVATURE OF A CURVE CONCAVE SOUTHERLY AND HAVING A RADIUS OF 275.00 FEET; THENCE EASTERLY ALONG THE ARC OF SAID CURVE THROUGH A CENTRAL ANGLE OF 26°22'25", AN ARC DISTANCE OF 126.58 FEET TO THE POINT OF TANGENCY; THENCE S89°26'50"E, 224.67 FEET TO THE POINT OF CURVATURE OF A CURVE CONCAVE SOUTHERLY AND HAVING A RADIUS OF 50.00 FEET; THENCE EASTERLY ALONG THE ARC OF SAID CURVE THROUGH A CENTRAL ANGLE OF 35°01'18", AN ARC DISTANCE OF 30.56 FEET TO A NON-TANGENT LINE; THENCE N35°34'28"E, 32.75 FEET TO A POINT ON SAID SOUTH LINE; THENCE S89°28'25"E, ALONG SAID SOUTH LINE A DISTANCE OF 803.43 FEET; THENCE DEPARTING SAID SOUTH LINE N00°00'00"E, 332.08 FEET; THENCE N24°20'31"E, 90.62 FEET; THENCE N46°47'32"E, 65.26 FEET; THENCE N57°47'48"E, 89.46 FEET; THENCE

N20°09'34"W, 84.16 FEET; THENCE N12°53'17"W, 210.76 FEET; THENCE
 N63°23'06"W, 77.59 FEET; THENCE N60°36'00"W, 101.19 FEET; THENCE
 N31°28'01"W, 83.30 FEET; THENCE S44°44'19"W, 47.66 FEET; THENCE
 S63°40'58"W, 116.19 FEET; THENCE S75°06'22"W, 64.60 FEET; THENCE
 S64°43'36"W, 63.56 FEET; THENCE S60°31'30"W, 70.00 FEET; THENCE
 S65°12'13"W, 122.60 FEET; THENCE S85°27'02"W, 568.83 FEET; THENCE
 N44°16'28"W, 151.80 FEET; THENCE N13°37'54"W, 130.70 FEET; THENCE
 N13°45'30"W, 73.29 FEET; THENCE N18°06'38"W, 72.87 FEET; THENCE
 N40°11'04"W, 151.52 FEET; THENCE N01°47'04"W, 139.11 FEET; THENCE
 N57°33'25"W, 161.80 FEET; THENCE N26°21'53"W, 626.45 FEET; THENCE
 S65°42'28"W, 128.17 FEET TO THE POINT OF CURVATURE OF A CURVE
 CONCAVE NORTHERLY AND HAVING A RADIUS OF 1,280.00 FEET; THENCE
 WESTERLY ALONG THE ARC OF SAID CURVE THROUGH A CENTRAL ANGLE
 OF 15°30'23", AN ARC DISTANCE OF 346.42 FEET TO A NON-TANGENT LINE;
 THENCE N08°47'09"W, 60.00 FEET; THENCE N02°29'11"E, 556.42 FEET; THENCE
 N14°07'01"E, 677.54 FEET; THENCE S46°32'24"E, 99.36 FEET; THENCE
 S72°59'44"E, 128.64 FEET; THENCE N64°45'07"E, 126.92 FEET; THENCE
 N50°35'09"E, 129.41 FEET; THENCE N21°26'58"E, 73.87 FEET; THENCE
 N19°36'47"E, 72.09 FEET; THENCE N25°22'53"E, 69.13 FEET; THENCE
 N79°16'57"E, 65.44 FEET; THENCE N67°26'10"E, 98.23 FEET; THENCE
 S38°03'28"E, 153.75 FEET; THENCE S15°05'32"E, 61.59 FEET; THENCE
 S04°57'47"W, 42.78 FEET; THENCE S89°22'51"E, 144.67 FEET; THENCE
 N07°58'19"W, 79.85 FEET; THENCE N18°55'46"E, 78.57 FEET; THENCE
 N50°42'19"E, 177.92 FEET; THENCE S59°47'45"E, 57.89 FEET; THENCE
 S47°22'10"E, 117.34 FEET; THENCE S10°01'34"E, 184.87 FEET; THENCE
 S30°52'25"E, 102.47 FEET; THENCE S46°46'31"E, 177.93 FEET; THENCE
 S77°43'02"E, 177.45 FEET; THENCE S71°25'51"E, 112.77 FEET; THENCE
 S60°52'47"E, 84.25 FEET; THENCE S82°58'08"E, 92.71 FEET; THENCE
 S32°47'36"W, 439.51 FEET; THENCE S31°55'32"W, 60.02 FEET; THENCE
 S21°06'14"W, 59.97 FEET; THENCE S18°40'59"W, 59.20 FEET; THENCE
 S12°36'30"W, 59.94 FEET; THENCE S12°17'59"W, 88.76 FEET TO A POINT ON
 THE ARC OF A NON-TANGENT CURVE CONCAVE SOUTHWESTERLY,
 HAVING A RADIUS OF 2,841.98 FEET AND A CHORD BEARING AND
 DISTANCE OF S66°49'04"E, 846.36 FEET; THENCE SOUTHEASTERLY ALONG
 THE ARC OF SAID CURVE, THROUGH A CENTRAL ANGLE OF 17°07'36", AN
 ARC DISTANCE OF 849.52 FEET TO THE POINT OF COMPOUND CURVATURE
 OF A CURVE CONCAVE SOUTHWESTERLY AND HAVING A RADIUS OF
 1,130.00 FEET; THENCE SOUTHEASTERLY ALONG THE ARC OF SAID CURVE
 THROUGH A CENTRAL ANGLE OF 10°32'43", AN ARC DISTANCE OF 207.98
 FEET TO THE POINT OF TANGENCY; THENCE S47°42'33"E, 388.21 FEET TO
 THE POINT OF CURVATURE OF A CURVE CONCAVE NORTHERLY AND
 HAVING A RADIUS OF 20.00 FEET; THENCE EASTERLY ALONG THE ARC OF
 SAID CURVE THROUGH A CENTRAL ANGLE OF 92°11'55", AN ARC DISTANCE
 OF 32.18 FEET TO THE POINT OF TANGENCY; THENCE N40°05'32"E, 402.38
 FEET TO THE POINT OF CURVATURE OF A CURVE CONCAVE

NORTHWESTERLY AND HAVING A RADIUS OF 1,370.00 FEET; THENCE
 NORTHEASTERLY ALONG THE ARC OF SAID CURVE THROUGH A CENTRAL
 ANGLE OF 14°41'57", AN ARC DISTANCE OF 351.47 FEET TO A NON-TANGENT
 LINE; THENCE S64°36'25"E, 60.00 FEET; THENCE S38°15'14"E, 118.83 FEET;
 THENCE S34°10'54"E, 86.47 FEET; THENCE S59°48'05"E, 82.33 FEET; THENCE
 S63°07'40"E, 74.93 FEET; THENCE S80°19'26"E, 72.26 FEET; THENCE
 N84°59'18"E, 67.88 FEET; THENCE N81°46'16"E, 68.54 FEET; THENCE
 N76°45'39"E, 68.22 FEET; THENCE N71°14'49"E, 80.88 FEET; THENCE
 N65°18'02"E, 79.91 FEET; THENCE N59°49'21"E, 68.22 FEET; THENCE
 N56°17'10"E, 69.60 FEET; THENCE N56°33'35"E, 71.58 FEET; THENCE
 N57°46'45"E, 140.77 FEET; THENCE N57°49'28"E, 70.00 FEET; THENCE
 N53°08'44"E, 66.52 FEET; THENCE N44°32'16"E, 79.50 FEET; THENCE
 N43°47'00"E, 70.00 FEET; THENCE N36°13'29"E, 287.37 FEET; THENCE
 S46°43'20"E, 472.38 FEET; THENCE S60°52'42"E, 769.61 FEET; THENCE
 S25°38'42"E, 86.09 FEET; THENCE S07°08'26"E, 60.00 FEET TO A POINT ON THE
 ARC OF A NON-TANGENT CURVE CONCAVE SOUTHERLY, HAVING A
 RADIUS OF 1,370.00 FEET AND A CHORD BEARING AND DISTANCE OF
 S88°08'01"E, 428.96 FEET; THENCE EASTERLY ALONG THE ARC OF SAID
 CURVE, THROUGH A CENTRAL ANGLE OF 18°00'50", AN ARC DISTANCE OF
 430.73 FEET TO THE POINT OF TANGENCY; THENCE S79°07'36"E, 221.27 FEET
 TO THE POINT OF CURVATURE OF A CURVE CONCAVE NORTHERLY AND
 HAVING A RADIUS OF 1,230.00 FEET; THENCE EASTERLY ALONG THE ARC
 OF SAID CURVE THROUGH A CENTRAL ANGLE OF 24°26'45", AN ARC
 DISTANCE OF 524.79 FEET TO THE POINT OF TANGENCY; THENCE
 N76°25'39"E, 386.10 FEET TO THE POINT OF CURVATURE OF A CURVE
 CONCAVE SOUTHERLY AND HAVING A RADIUS OF 1,470.00 FEET; THENCE
 EASTERLY ALONG THE ARC OF SAID CURVE THROUGH A CENTRAL ANGLE
 OF 01°07'59", AN ARC DISTANCE OF 29.07 FEET TO THE POINT OF
 TANGENCY; THENCE S62°29'33"E, 175.12 FEET; THENCE S59°23'48"E, 101.38
 FEET; THENCE S64°58'10"E, 102.98 FEET; THENCE S59°23'48"E, 208.09 FEET;
 THENCE S25°43'18"W, 403.86 FEET; THENCE S49°44'33"W, 91.60 FEET; THENCE
 S24°01'00"W, 73.59 FEET; THENCE S10°14'40"W, 219.84 FEET; THENCE
 S45°42'19"W, 104.12 FEET; THENCE S28°52'51"W, 143.80 FEET; THENCE
 S57°50'32"W, 42.33 FEET; THENCE S58°02'45"W, 71.41 FEET; THENCE
 S58°41'03"W, 102.72 FEET; THENCE S43°02'33"W, 175.43 FEET; THENCE
 S80°17'14"W, 297.92 FEET; THENCE N86°19'47"W, 117.28 FEET; THENCE
 N73°05'49"W, 124.07 FEET; THENCE N70°42'40"W, 224.68 FEET; THENCE
 N54°39'22"W, 83.38 FEET; THENCE N71°26'05"W, 87.42 FEET; THENCE
 S34°48'26"W, 161.44 FEET; THENCE S81°57'54"W, 86.17 FEET; THENCE
 N52°49'14"W, 94.78 FEET; THENCE N38°40'58"W, 77.49 FEET; THENCE
 N25°43'02"E, 89.60 FEET; THENCE N52°44'57"E, 72.56 FEET; THENCE
 N51°51'43"E, 88.45 FEET TO THE POINT OF CURVATURE OF A CURVE
 CONCAVE SOUTHEASTERLY AND HAVING A RADIUS OF 114.00 FEET;
 THENCE NORTHEASTERLY ALONG THE ARC OF SAID CURVE THROUGH A
 CENTRAL ANGLE OF 12°24'46", AN ARC DISTANCE OF 24.70 FEET TO A NON-

TANGENT LINE; THENCE N10°34'01"E, 94.57 FEET; THENCE N22°15'01"W, 132.63 FEET; THENCE N55°44'24"W, 50.35 FEET; THENCE N89°39'25"W, 53.80 FEET; THENCE N26°43'08"W, 113.15 FEET; THENCE N86°58'36"W, 68.05 FEET; THENCE S61°18'46"W, 245.19 FEET; THENCE S50°37'13"W, 230.41 FEET; THENCE S33°26'08"W, 119.48 FEET; THENCE S70°18'39"W, 72.43 FEET; THENCE S78°55'29"W, 87.92 FEET; THENCE S72°46'04"W, 132.11 FEET; THENCE S59°41'38"W, 57.07 FEET; THENCE S32°47'07"W, 96.39 FEET; THENCE S06°18'19"W, 78.07 FEET; THENCE S02°58'38"E, 63.74 FEET; THENCE S25°52'47"E, 68.57 FEET; THENCE S47°03'25"E, 66.52 FEET; THENCE S74°22'11"E, 120.44 FEET TO THE POINT OF BEGINNING.

LESS

THAT LAND LYING IN SECTION 11, TOWNSHIP 19 SOUTH, RANGE 23 EAST, SUMTER COUNTY, FLORIDA, DESCRIBED AS FOLLOWS:

FROM THE SOUTHEAST CORNER OF THE SOUTHWEST 1/4 OF SAID SECTION 11 RUN N00°35'25"E, ALONG THE EAST LINE THEREOF A DISTANCE OF 1126.40 FEET; THENCE DEPARTING SAID EAST LINE, N89°24'35"W, 137.88 FEET TO THE POINT OF BEGINNING; THENCE S50°05'24"W, 283.40 FEET; THENCE S50°57'42"W, 75.35 FEET; THENCE S61°11'35"W, 23.39 FEET; THENCE N25°22'26"W, 203.64 FEET TO A POINT ON THE ARC OF A NON-TANGENT CURVE CONCAVE NORTHWESTERLY, HAVING A RADIUS OF 1,534.81 FEET AND A CHORD BEARING AND DISTANCE OF N58°42'08"E, 47.02 FEET; THENCE NORTHEASTERLY ALONG THE ARC OF SAID CURVE, THROUGH A CENTRAL ANGLE OF 01°45'20", AN ARC DISTANCE OF 47.03 FEET TO THE POINT OF TANGENCY; THENCE N57°49'28"E, 299.37 FEET; THENCE S35°17'28"E, 155.95 FEET TO THE POINT OF BEGINNING.

ALSO LESS

THAT LAND LYING IN SECTION 10, TOWNSHIP 19 SOUTH, RANGE 23 EAST, SUMTER COUNTY, FLORIDA, DESCRIBED AS FOLLOWS:

FROM THE SOUTHEAST CORNER OF THE SOUTHEAST 1/4 OF SAID SECTION 10 RUN N00°33'20"E, ALONG THE EAST LINE THEREOF A DISTANCE OF 1825.31 FEET; THENCE DEPARTING SAID EAST LINE, N89°26'40"W, 424.79 FEET TO THE POINT OF BEGINNING; THENCE S30°19'49"W, 354.75 FEET; THENCE N80°05'03"W, 103.81 FEET; THENCE N86°00'25"W, 65.90 FEET; THENCE N89°47'02"W, 65.90 FEET; THENCE S86°31'19"W, 74.32 FEET; THENCE S72°12'46"W, 73.87 FEET; THENCE N19°04'57"W, 233.36 FEET; THENCE N06°24'16"E, 318.16 FEET TO A POINT ON THE ARC OF A NON-TANGENT CURVE CONCAVE SOUTHERLY, HAVING A RADIUS OF 2,781.98 FEET AND A CHORD BEARING AND DISTANCE OF S69°17'46"E, 639.69 FEET; THENCE EASTERLY ALONG THE ARC OF SAID CURVE, THROUGH A CENTRAL ANGLE OF 13°12'13", AN ARC DISTANCE OF 641.10 FEET TO THE POINT OF BEGINNING.

ALSO LESS

THAT LAND LYING IN SECTIONS 10 AND 15, TOWNSHIP 19 SOUTH, RANGE 23 EAST, SUMTER COUNTY, FLORIDA, DESCRIBED AS FOLLOWS:

FROM THE NORTHWEST CORNER OF THE NORTHWEST 1/4 OF SAID SECTION 15 RUN S00°34'50"W, ALONG THE WEST LINE THEREOF A DISTANCE OF 385.13 FEET; THENCE DEPARTING SAID WEST LINE, S89°25'10"E, 485.09 FEET TO THE POINT OF BEGINNING; THENCE N01°19'30"W, 246.59 FEET; THENCE N18°37'49"W, 146.87 FEET; THENCE N01°59'36"W, 51.00 FEET; THENCE N15°33'12"W, 117.07 FEET; THENCE N21°20'25"E, 57.29 FEET; THENCE N55°27'52"W, 139.56 FEET; THENCE N76°50'16"W, 43.55 FEET; THENCE N88°24'55"W, 50.63 FEET; THENCE S70°55'19"W, 44.74 FEET; THENCE N09°34'21"W, 81.01 FEET; THENCE N13°44'32"W, 60.42 FEET; THENCE N12°46'57"W, 25.00 FEET; THENCE N10°57'14"W, 63.81 FEET; THENCE N09°04'04"E, 62.70 FEET; THENCE N29°07'49"E, 62.71 FEET; THENCE S88°56'35"E, 82.99 FEET; THENCE N11°59'05"E, 131.26 FEET; THENCE N09°17'14"E, 106.44 FEET; THENCE N14°27'25"E, 79.17 FEET; THENCE N25°20'05"E, 83.57 FEET TO A POINT ON THE ARC OF A NON-TANGENT CURVE CONCAVE NORTHEASTERLY, HAVING A RADIUS OF 1,768.81 FEET AND A CHORD BEARING AND DISTANCE OF S67°02'11"E, 58.02 FEET; THENCE SOUTHEASTERLY ALONG THE ARC OF SAID CURVE, THROUGH A CENTRAL ANGLE OF 01°52'46", AN ARC DISTANCE OF 58.02 FEET TO THE POINT OF COMPOUND CURVATURE OF A CURVE CONCAVE NORTHERLY AND HAVING A RADIUS OF 125.00 FEET; THENCE EASTERLY ALONG THE ARC OF SAID CURVE THROUGH A CENTRAL ANGLE OF 64°29'06", AN ARC DISTANCE OF 140.68 FEET TO THE POINT OF TANGENCY; THENCE N47°32'20"E, 25.52 FEET TO THE POINT OF CURVATURE OF A CURVE CONCAVE SOUTHEASTERLY AND HAVING A RADIUS OF 475.00 FEET; THENCE NORTHEASTERLY ALONG THE ARC OF SAID CURVE THROUGH A CENTRAL ANGLE OF 08°59'00", AN ARC DISTANCE OF 74.47 FEET TO THE POINT OF TANGENCY; THENCE N56°31'20"E, 46.42 FEET; THENCE S33°28'40"E, 179.66 FEET; THENCE N07°55'42"E, 10.66 FEET; THENCE N25°05'20"E, 79.08 FEET; THENCE N41°02'48"E, 154.09 FEET; THENCE N06°16'16"W, 60.92 FEET; THENCE N21°52'39"E, 65.15 FEET; THENCE N07°04'50"W, 30.21 FEET TO A POINT ON THE ARC OF A NON-TANGENT CURVE CONCAVE NORTHERLY, HAVING A RADIUS OF 730.00 FEET AND A CHORD BEARING AND DISTANCE OF N82°00'55"E, 23.04 FEET; THENCE EASTERLY ALONG THE ARC OF SAID CURVE, THROUGH A CENTRAL ANGLE OF 01°48'30", AN ARC DISTANCE OF 23.04 FEET TO THE POINT OF COMPOUND CURVATURE OF A CURVE CONCAVE NORTHERLY AND HAVING A RADIUS OF 1,530.00 FEET; THENCE EASTERLY ALONG THE ARC OF SAID CURVE THROUGH A CENTRAL ANGLE OF 05°27'29", AN ARC DISTANCE OF 145.75 FEET TO A NON-TANGENT LINE; THENCE S14°20'49"E, 38.24 FEET; THENCE S10°59'23"E, 139.33 FEET; THENCE S20°58'23"E, 81.69 FEET; THENCE S78°18'40"E, 82.50 FEET; THENCE S34°26'14"E,

75.04 FEET; THENCE S01°21'06"W, 107.72 FEET; THENCE S42°15'43"E, 78.71 FEET; THENCE N47°11'25"E, 116.70 FEET; THENCE S31°52'58"E, 99.58 FEET; THENCE S22°30'55"E, 76.71 FEET; THENCE S29°15'27"E, 76.88 FEET; THENCE S41°43'36"E, 73.50 FEET; THENCE S35°37'58"E, 66.78 FEET; THENCE S28°15'03"E, 63.26 FEET; THENCE S21°01'10"E, 67.81 FEET; THENCE S12°58'50"E, 71.84 FEET; THENCE S03°33'35"E, 80.07 FEET; THENCE S19°50'33"E, 51.19 FEET; THENCE S25°58'12"W, 107.99 FEET; THENCE S30°45'39"E, 111.20 FEET; THENCE S06°30'53"W, 97.62 FEET; THENCE S89°25'15"E, 198.71 FEET; THENCE S44°10'59"E, 53.30 FEET; THENCE S30°18'47"E, 49.89 FEET; THENCE S07°27'56"E, 56.07 FEET; THENCE S00°48'19"E, 66.96 FEET; THENCE S02°40'03"W, 66.96 FEET; THENCE S06°08'24"W, 59.58 FEET; THENCE S80°55'02"W, 85.31 FEET; THENCE S80°44'26"W, 25.00 FEET; THENCE S80°19'41"W, 70.00 FEET; THENCE S82°40'06"W, 66.20 FEET; THENCE S88°51'21"W, 65.63 FEET; THENCE N85°53'09"W, 68.09 FEET; THENCE N85°18'37"W, 227.70 FEET; THENCE N87°40'44"W, 76.79 FEET; THENCE N37°52'15"W, 154.64 FEET; THENCE N22°43'02"W, 58.40 FEET; THENCE N82°17'59"W, 66.34 FEET; THENCE S73°44'09"W, 78.84 FEET; THENCE S44°15'10"W, 198.85 FEET; THENCE S36°03'47"W, 67.91 FEET; THENCE S56°27'03"W, 114.27 FEET; THENCE N81°30'22"W, 122.51 FEET; THENCE N68°01'02"W, 136.22 FEET TO THE POINT OF BEGINNING.

AND

THAT LAND LYING IN SECTIONS 9 AND 10, TOWNSHIP 19 SOUTH, RANGE 23 EAST, SUMTER COUNTY, FLORIDA, DESCRIBED AS FOLLOWS:

FROM THE NORTHEAST CORNER OF THE SOUTHEAST 1/4 OF SAID SECTION 9 RUN N89°36'47"W, ALONG THE NORTH LINE THEREOF A DISTANCE OF 1,279.70 FEET; THENCE DEPARTING SAID NORTH LINE, S00°23'13"W, 290.30 FEET TO THE POINT OF BEGINNING; THENCE N87°49'28"W, 222.23 FEET TO THE POINT OF CURVATURE OF A CURVE CONCAVE NORTHERLY AND HAVING A RADIUS OF 1,530.00 FEET; THENCE WESTERLY ALONG THE ARC THEREOF THROUGH A CENTRAL ANGLE OF 02°58'07", A DISTANCE OF 79.27 FEET TO A NON-TANGENT LINE; THENCE N05°08'39"E, 60.00 FEET; THENCE N13°05'05"W, 162.41 FEET; THENCE N28°28'27"E, 527.23 FEET; THENCE N24°33'42"E, 206.74 FEET; THENCE N18°39'19"E, 101.55 FEET; THENCE N03°05'42"E, 86.59 FEET; THENCE N76°27'37"E, 123.98 FEET; THENCE N80°53'48"E, 99.83 FEET; THENCE N56°34'24"E, 136.51 FEET; THENCE N57°11'52"E, 125.20 FEET; THENCE N38°28'49"E, 108.28 FEET; THENCE N38°53'10"E, 103.73 FEET; THENCE N65°16'34"E, 122.51 FEET; THENCE N72°41'10"E, 144.98 FEET; THENCE S81°19'19"E, 38.26 FEET; THENCE S13°57'05"E, 147.92 FEET; THENCE S21°17'16"E, 16.99 FEET; THENCE S66°52'20"E, 80.33 FEET; THENCE S67°33'39"E, 140.00 FEET; THENCE S70°37'06"E, 75.05 FEET; THENCE S77°41'26"E, 74.61 FEET; THENCE S84°20'07"E, 65.63 FEET; THENCE N89°43'49"E, 67.03 FEET; THENCE N88°18'48"E, 139.43

FEET; THENCE N89°15'01"E, 25.00 FEET; THENCE S84°43'49"E, 85.72 FEET;
 THENCE N09°44'01"E, 33.63 FEET; THENCE S59°30'10"E, 28.31 FEET; THENCE
 S81°00'28"E, 73.20 FEET; THENCE S53°56'25"E, 79.65 FEET; THENCE S88°12'03"E,
 54.93 FEET; THENCE N50°32'03"E, 91.35 FEET; THENCE N24°36'35"E, 42.73
 FEET; THENCE N45°41'30"E, 119.84 FEET; THENCE N45°23'24"E, 79.19 FEET;
 THENCE N33°06'15"E, 63.02 FEET; THENCE N43°54'08"E, 48.52 FEET; THENCE
 N62°05'50"E, 130.64 FEET; THENCE N47°46'14"E, 53.28 FEET; THENCE
 N76°03'38"E, 68.18 FEET; THENCE N71°46'06"E, 46.43 FEET; THENCE
 N58°11'16"E, 66.29 FEET; THENCE N39°31'07"E, 65.69 FEET; THENCE
 N56°22'43"E, 54.68 FEET; THENCE N59°23'27"E, 100.77 FEET; THENCE
 N76°15'21"E, 15.00 FEET; THENCE S13°44'39"E, 79.01 FEET TO THE POINT OF
 CURVATURE OF A CURVE CONCAVE WESTERLY AND HAVING A RADIUS
 OF 1,340.00 FEET; THENCE SOUTHERLY ALONG THE ARC THEREOF
 THROUGH A CENTRAL ANGLE OF 10°40'23", A DISTANCE OF 249.62 FEET TO
 THE POINT OF COMPOUND CURVATURE OF A CURVE CONCAVE
 NORTHWESTERLY AND HAVING A RADIUS OF 49.00 FEET; THENCE
 SOUTHWESTERLY ALONG THE ARC OF SAID CURVE THROUGH A CENTRAL
 ANGLE OF 55°50'49", A DISTANCE OF 47.76 FEET TO THE POINT OF REVERSE
 CURVATURE OF A CURVE CONCAVE EASTERLY AND HAVING A RADIUS OF
 131.00 FEET; THENCE SOUTHERLY ALONG THE ARC OF SAID CURVE
 THROUGH A CENTRAL ANGLE OF 93°05'26", A DISTANCE OF 212.84 FEET TO
 THE POINT OF REVERSE CURVATURE OF A CURVE CONCAVE WESTERLY
 AND HAVING A RADIUS OF 94.00 FEET; THENCE SOUTHERLY ALONG THE
 ARC OF SAID CURVE THROUGH A CENTRAL ANGLE OF 50°28'20", A
 DISTANCE OF 82.81 FEET TO THE POINT OF COMPOUND CURVATURE OF A
 CURVE CONCAVE NORTHWESTERLY AND HAVING A RADIUS OF 1,340.00
 FEET; THENCE SOUTHWESTERLY ALONG THE ARC OF SAID CURVE
 THROUGH A CENTRAL ANGLE OF 61°42'17", A DISTANCE OF 1,443.12 FEET
 TO THE POINT OF REVERSE CURVATURE OF A CURVE CONCAVE
 SOUTHEASTERLY AND HAVING A RADIUS OF 1,570.00 FEET; THENCE
 SOUTHWESTERLY ALONG THE ARC OF SAID CURVE THROUGH A CENTRAL
 ANGLE OF 15°53'08", A DISTANCE OF 435.29 FEET TO THE POINT OF REVERSE
 CURVATURE OF A CURVE CONCAVE NORTHWESTERLY AND HAVING A
 RADIUS OF 1,500.00 FEET; THENCE SOUTHWESTERLY ALONG THE ARC OF
 SAID CURVE THROUGH A CENTRAL ANGLE OF 12°01'02", A DISTANCE OF
 314.61 FEET TO THE POINT OF REVERSE CURVATURE OF A CURVE
 CONCAVE SOUTHEASTERLY AND HAVING A RADIUS OF 542.54 FEET;
 THENCE SOUTHWESTERLY ALONG THE ARC OF SAID CURVE THROUGH A
 CENTRAL ANGLE OF 44°16'55", A DISTANCE OF 419.31 FEET TO THE POINT
 OF REVERSE CURVATURE OF A CURVE CONCAVE NORTHWESTERLY AND
 HAVING A RADIUS OF 593.00 FEET; THENCE SOUTHWESTERLY ALONG THE
 ARC OF SAID CURVE THROUGH A CENTRAL ANGLE OF 14°21'42", A
 DISTANCE OF 148.64 FEET TO THE POINT OF COMPOUND CURVATURE OF A
 CURVE CONCAVE NORTHWESTERLY AND HAVING A RADIUS OF 300.00
 FEET; THENCE SOUTHWESTERLY ALONG THE ARC OF SAID CURVE

THROUGH A CENTRAL ANGLE OF 17°13'39", A DISTANCE OF 90.20 FEET TO THE POINT OF COMPOUND CURVATURE OF A CURVE CONCAVE NORTHERLY AND HAVING A RADIUS OF 1,220.00 FEET; THENCE WESTERLY ALONG THE ARC OF SAID CURVE THROUGH A CENTRAL ANGLE OF 33°22'21", A DISTANCE OF 710.60 FEET TO A NON-TANGENT LINE; THENCE N01°19'34"W, 45.00 FEET; THENCE N04°25'44"W, 860.56 FEET TO THE POINT OF BEGINNING.

AND

THAT LAND LYING IN SECTION 9, TOWNSHIP 19 SOUTH, RANGE 23 EAST, SUMTER COUNTY, FLORIDA, DESCRIBED AS FOLLOWS:

FROM THE NORTHEAST CORNER OF THE NORTHWEST 1/4 OF SAID SECTION 9 RUN S00°30'05"W, ALONG THE EAST LINE THEREOF A DISTANCE OF 667.38 FEET TO THE SOUTH LINE OF THE NORTH 1/4 OF THE NORTHWEST 1/4 OF SAID SECTION 9; THENCE DEPARTING SAID EAST LINE, N89°35'38"W, ALONG SAID SOUTH LINE A DISTANCE OF 1,591.70 FEET TO THE POINT OF BEGINNING; THENCE CONTINUE ALONG SAID SOUTH LINE N89°35'39"W, 423.11 FEET; THENCE DEPARTING SAID SOUTH LINE, S00°06'44"W, 28.71 FEET; THENCE N89°35'19"W, 568.89 FEET; THENCE S00°27'24"W, 163.64 FEET TO A POINT ON THE ARC OF A NON-TANGENT CURVE CONCAVE WESTERLY, HAVING A RADIUS OF 1599.55 FEET AND A CHORD BEARING AND DISTANCE OF S05°21'49"W, 297.20 FEET; THENCE SOUTHERLY ALONG THE ARC OF SAID CURVE, THROUGH A CENTRAL ANGLE OF 10°39'40", A DISTANCE OF 297.63 FEET TO A POINT ON A NON-TANGENT LINE; THENCE S00°25'07"W, 1,511.83 FEET; THENCE S00°57'59"W, 987.31 FEET; THENCE S65°02'56"E, 808.32 FEET; THENCE S65°24'33"E, 365.88 FEET TO A POINT ON THE ARC OF A NON-TANGENT CURVE CONCAVE SOUTHWESTERLY, HAVING A RADIUS OF 1,500.00 FEET AND A CHORD BEARING AND DISTANCE OF S62°48'07"E, 29.99 FEET; THENCE SOUTHEASTERLY ALONG THE ARC OF SAID CURVE, THROUGH A CENTRAL ANGLE OF 01°08'44", A DISTANCE OF 29.99 FEET TO A POINT ON A NON-TANGENT LINE; THENCE N26°45'48"E, 313.94 FEET; THENCE N18°39'04"E, 250.94 FEET; THENCE N29°15'35"E, 62.41 FEET; THENCE N81°00'51"E, 163.56 FEET; THENCE N70°22'01"E, 71.49 FEET; THENCE N80°55'06"E, 391.86 FEET; THENCE S58°29'58"E, 107.82 FEET; THENCE S04°43'18"E, 210.31 FEET; THENCE S41°58'24"E, 224.28 FEET TO A POINT ON THE ARC OF A NON-TANGENT CURVE CONCAVE SOUTHEASTERLY, HAVING A RADIUS OF 960.00 FEET AND A CHORD BEARING AND DISTANCE OF N80°55'57"E, 378.68 FEET; THENCE NORTHEASTERLY ALONG THE ARC OF SAID CURVE, THROUGH A CENTRAL ANGLE OF 22°45'00", A DISTANCE OF 381.18 FEET TO THE POINT OF TANGENCY; THENCE S87°41'32"E, 137.04 FEET TO THE POINT OF CURVATURE OF A CURVE CONCAVE NORTHERLY AND HAVING A RADIUS OF 840.00 FEET; THENCE EASTERLY ALONG THE ARC THEREOF THROUGH A

CENTRAL ANGLE OF 17°13'08", A DISTANCE OF 252.44 FEET TO THE POINT OF COMPOUND CURVATURE OF A CURVE CONCAVE NORTHWESTERLY AND HAVING A RADIUS OF 94.00 FEET; THENCE NORTHEASTERLY ALONG THE ARC OF SAID CURVE THROUGH A CENTRAL ANGLE OF 42°09'16", A DISTANCE OF 69.16 FEET TO THE POINT OF REVERSE CURVATURE OF A CURVE CONCAVE SOUTHEASTERLY AND HAVING A RADIUS OF 131.00 FEET; THENCE NORTHEASTERLY ALONG THE ARC OF SAID CURVE THROUGH A CENTRAL ANGLE OF 25°53'32", A DISTANCE OF 59.20 FEET TO THE POINT OF REVERSE CURVATURE OF A CURVE CONCAVE NORTHWESTERLY AND HAVING A RADIUS OF 80.00 FEET; THENCE NORTHEASTERLY ALONG THE ARC OF SAID CURVE THROUGH A CENTRAL ANGLE OF 57°56'24", A DISTANCE OF 80.90 FEET TO THE POINT OF TANGENCY; THENCE N00°53'11"E, 55.55 FEET TO THE POINT OF CURVATURE OF A CURVE CONCAVE WESTERLY AND HAVING A RADIUS OF 15.00 FEET; THENCE NORTHERLY ALONG THE ARC THEREOF THROUGH A CENTRAL ANGLE OF 35°29'00", A DISTANCE OF 9.29 FEET TO THE POINT OF REVERSE CURVATURE OF A CURVE CONCAVE EASTERLY AND HAVING A RADIUS OF 55.00 FEET; THENCE NORTHERLY ALONG THE ARC OF SAID CURVE THROUGH A CENTRAL ANGLE OF 70°57'59", A DISTANCE OF 68.12 FEET TO THE POINT OF REVERSE CURVATURE OF A CURVE CONCAVE WESTERLY AND HAVING A RADIUS OF 15.00 FEET; THENCE NORTHERLY ALONG THE ARC OF SAID CURVE THROUGH A CENTRAL ANGLE OF 35°29'00", A DISTANCE OF 9.29 FEET TO THE POINT OF TANGENCY; THENCE N00°53'11"E, 110.33 FEET TO THE POINT OF CURVATURE OF A CURVE CONCAVE WESTERLY AND HAVING A RADIUS OF 670.00 FEET; THENCE NORTHERLY ALONG THE ARC THEREOF THROUGH A CENTRAL ANGLE OF 06°12'22", A DISTANCE OF 72.57 FEET TO THE POINT OF TANGENCY; THENCE N05°19'11"W, 409.61 FEET TO THE POINT OF CURVATURE OF A CURVE CONCAVE WESTERLY AND HAVING A RADIUS OF 670.00 FEET; THENCE NORTHERLY ALONG THE ARC THEREOF THROUGH A CENTRAL ANGLE OF 32°38'16", A DISTANCE OF 381.66 FEET TO THE POINT OF TANGENCY; THENCE N37°57'27"W, 424.50 FEET TO THE POINT OF CURVATURE OF A CURVE CONCAVE EASTERLY AND HAVING A RADIUS OF 730.00 FEET; THENCE NORTHERLY ALONG THE ARC THEREOF THROUGH A CENTRAL ANGLE OF 53°22'50", A DISTANCE OF 680.11 FEET TO THE POINT OF TANGENCY; THENCE N15°25'23"E, 278.83 FEET TO THE POINT OF CURVATURE OF A CURVE CONCAVE EASTERLY AND HAVING A RADIUS OF 1,230.00 FEET; THENCE NORTHERLY ALONG THE ARC THEREOF THROUGH A CENTRAL ANGLE OF 08°01'49", A DISTANCE OF 172.39 FEET TO THE POINT OF TANGENCY; THENCE N23°27'12"E, 167.54 FEET; THENCE N66°32'48"W, 155.42 FEET; THENCE S74°49'09"W, 100.76 FEET; THENCE S60°26'27"W, 70.61 FEET; THENCE S36°11'06"W, 229.74 FEET; THENCE S35°23'40"W, 80.07 FEET; THENCE S31°02'50"W, 80.82 FEET; THENCE S29°58'52"W, 70.00 FEET; THENCE S28°56'39"W, 74.02 FEET; THENCE S25°48'13"W, 75.04 FEET; THENCE S22°26'41"W, 81.47 FEET; THENCE S25°55'09"W, 82.38 FEET; THENCE

S15°35'19"W, 75.60 FEET; THENCE S12°22'04"W, 75.60 FEET; THENCE S09°08'37"W, 75.60 FEET; THENCE S06°31'41"W, 72.21 FEET; THENCE S06°15'56"W, 140.00 FEET; THENCE S02°10'48"W, 140.36 FEET; THENCE S06°15'56"W, 116.80 FEET; THENCE S08°15'10"W, 23.22 FEET; THENCE S10°14'59"W, 64.75 FEET; THENCE S18°33'06"W, 68.58 FEET; THENCE S18°56'28"W, 140.00 FEET; THENCE S29°43'35"W, 72.96 FEET; THENCE S88°03'29"W, 574.91 FEET; THENCE N64°03'28"W, 54.82 FEET; THENCE N49°18'10"W, 689.66 FEET; THENCE N65°50'05"W, 128.44 FEET; THENCE N73°57'53"W, 70.71 FEET; THENCE N65°00'39"W, 80.90 FEET; THENCE N51°18'44"W, 76.65 FEET; THENCE N36°39'16"W, 61.03 FEET; THENCE N23°29'03"W, 60.26 FEET; THENCE N10°40'18"W, 59.64 FEET; THENCE N00°09'23"W, 76.75 FEET; THENCE N00°26'56"E, 289.00 FEET; THENCE N05°17'40"E, 73.07 FEET; THENCE N20°29'12"E, 65.50 FEET; THENCE N36°21'16"E, 73.46 FEET; THENCE N50°07'41"E, 71.90 FEET; THENCE N64°30'21"E, 62.94 FEET; THENCE N74°29'48"E, 175.88 FEET; THENCE N60°02'31"E, 412.86 FEET; THENCE N03°39'17"E, 407.97 FEET TO THE POINT OF BEGINNING.

LESS

THAT LAND LYING IN SECTION 9, TOWNSHIP 19 SOUTH, RANGE 23 EAST, SUMTER COUNTY, FLORIDA, DESCRIBED AS FOLLOWS:

FROM THE NORTHEAST CORNER OF THE NORTHWEST 1/4 OF SAID SECTION 9 RUN S00°30'05"W, ALONG THE EAST LINE THEREOF A DISTANCE OF 2914.33 FEET; THENCE DEPARTING SAID EAST LINE, N89°29'55"W, 1185.96 FEET TO THE POINT OF BEGINNING; THENCE S01°56'31"E, 90.00 FEET; THENCE S06°00'15"W, 120.00 FEET; THENCE S10°12'04"W, 111.91 FEET; THENCE S40°09'10"W, 133.68 FEET; THENCE S05°46'35"W, 95.80 FEET; THENCE S28°21'31"W, 56.92 FEET; THENCE N65°02'56"W, 313.38 FEET; THENCE N55°56'45"W, 70.89 FEET; THENCE N00°57'59"E, 147.04 FEET; THENCE N14°21'28"E, 63.47 FEET; THENCE N29°31'39"E, 71.92 FEET; THENCE N34°08'25"E, 126.15 FEET; THENCE N40°41'50"E, 90.00 FEET TO A POINT ON THE ARC OF A CURVE CONCAVE NORTHERLY, HAVING A RADIUS OF 225.00 FEET AND A CHORD BEARING AND DISTANCE OF S70°41'00"E, 163.16 FEET; THENCE EASTERLY ALONG THE ARC OF SAID CURVE, THROUGH A CENTRAL ANGLE OF 42°31'01", AN ARC DISTANCE OF 166.96 FEET TO THE POINT OF TANGENCY; THENCE N88°03'29"E, 158.04 FEET TO THE POINT OF BEGINNING.

AND

THAT LAND LYING IN SECTION 8, TOWNSHIP 19 SOUTH, RANGE 23 EAST, SUMTER COUNTY, FLORIDA, DESCRIBED AS FOLLOWS:

BEGIN AT THE INTERSECTION OF THE EASTERLY LINE OF KERL AND

MILLERS SUBDIVISION FIRST ADDITION TO WILDWOOD, ACCORDING TO THE PLAT THEREOF AS RECORDED IN PLAT BOOK 2, PAGE 55, PUBLIC RECORDS OF SUMTER COUNTY, FLORIDA AND THE SOUTHERLY RIGHT OF WAY OF THE CSX RAILWAY; THENCE N24°48'19"E, ALONG THE NORTHEASTERLY EXTENSION THEREOF A DISTANCE OF 30.33 FEET TO THE SOUTHWESTERLY RIGHT OF WAY LINE OF COUNTY ROAD NO. 44A PER OFFICIAL RECORDS BOOK 2173, PAGE 643, PUBLIC RECORDS OF SUMTER COUNTY, FLORIDA; THENCE S65°10'12"E, ALONG SAID SOUTHWESTERLY RIGHT OF WAY LINE A DISTANCE OF 1,834.89 FEET TO THE POINT OF CURVATURE OF A CURVE CONCAVE WESTERLY AND HAVING A RADIUS OF 50.00 FEET; SAID POINT ALSO BEING ON THE WESTERLY RIGHT OF WAY LINE OF POWELL ROAD PER OFFICIAL RECORDS BOOK 2088, PAGE 199, PUBLIC RECORDS OF SUMTER COUNTY, FLORIDA; THE FOLLOWING (5) FIVE COURSES BEING ALONG SAID WESTERLY RIGHT OF WAY LINE OF POWELL ROAD: THENCE SOUTHERLY ALONG THE ARC OF SAID CURVE THROUGH A CENTRAL ANGLE OF 90°14'54", AN ARC DISTANCE OF 78.76 FEET TO THE POINT OF TANGENCY; THENCE S25°04'43"W, 30.65 FEET TO THE POINT OF CURVATURE OF A CURVE CONCAVE NORTHWESTERLY AND HAVING A RADIUS OF 690.00 FEET; THENCE SOUTHWESTERLY ALONG THE ARC OF SAID CURVE THROUGH A CENTRAL ANGLE OF 38°11'57", AN ARC DISTANCE OF 460.02 FEET TO THE POINT OF TANGENCY; THENCE S63°16'39"W, 330.88 FEET TO THE POINT OF CURVATURE OF A CURVE CONCAVE SOUTHEASTERLY AND HAVING A RADIUS OF 760.00 FEET; THENCE SOUTHWESTERLY ALONG THE ARC OF SAID CURVE THROUGH A CENTRAL ANGLE OF 27°47'37", AN ARC DISTANCE OF 368.67 FEET TO A POINT ON A NON-TANGENT LINE; THENCE DEPARTING SAID WESTERLY RIGHT OF WAY LINE RUN N66°22'30"W, 309.36 FEET; THENCE N69°21'04"W, 40.55 FEET; THENCE N75°37'23"W, 40.55 FEET; THENCE N82°26'11"W, 47.51 FEET; THENCE N86°19'02"W, 51.75 FEET; THENCE N81°27'56"W, 61.87 FEET; THENCE N75°49'16"W, 61.91 FEET; THENCE N70°02'15"W, 57.09 FEET; THENCE N65°11'41"W, 716.85 FEET TO A POINT ON THE SOUTHWESTERLY EXTENSION OF SAID EASTERLY LINE OF KERL AND MILLER SUBDIVISION; THENCE N24°48'19"E, ALONG SAID SOUTHWESTERLY EXTENSION AND EASTERLY LINE A DISTANCE OF 1,151.34 FEET TO THE POINT OF BEGINNING.

AND

THAT LAND LYING IN SECTIONS 9 AND 16, TOWNSHIP 19 SOUTH, RANGE 23 EAST, SUMTER COUNTY, FLORIDA, DESCRIBED AS FOLLOWS:

COMMENCE AT THE INTERSECTION OF THE WESTERLY LINE OF OAK PARK, ACCORDING TO THE PLAT THEREOF AS RECORDED IN PLAT BOOK 4, PAGE 32, PUBLIC RECORDS OF SUMTER COUNTY, FLORIDA AND THE NORTHERLY RIGHT OF WAY OF STATE ROAD NO. 44 PER FLORIDA DEPARTMENT OF TRANSPORTATION RIGHT-OF-WAY MAP, SECTION #18070-2518; THE

FOLLOWING (5) FIVE COURSES BEING ALONG THE NORTHEASTERLY RIGHT OF WAY LINE OF STATE ROAD NO. 44 PER FLORIDA DEPARTMENT OF TRANSPORTATION RIGHT OF WAY MAP, SECTION NO. 18070-2518: THENCE N67°34'23"W, 21.54 FEET TO THE POINT OF BEGINNING; SAID POINT BEING ON THE WEST LINE OF AT&T EASEMENT PER OFFICIAL RECORDS BOOK 1895, PAGE 758, PUBLIC RECORDS OF SUMTER COUNTY, FLORIDA; THENCE CONTINUE N67°34'23"W, 250.31 FEET; THENCE N65°48'19"W, 300.48 FEET; THENCE N64°37'01"W, 200.60 FEET; THENCE N65°58'19"W, 285.16 FEET; THENCE DEPARTING SAID NORTHEASTERLY RIGHT OF WAY LINE N24°01'41"E, 65.68 FEET; THENCE N32°23'55"E, 140.60 FEET; THENCE N04°46'45"E, 73.00 FEET; THENCE N01°10'58"W, 52.54 FEET; THENCE N04°23'35"W, 51.25 FEET; THENCE N28°44'18"W, 65.15 FEET; THENCE N01°43'08"E, 42.10 FEET; THENCE N15°39'56"W, 256.37 FEET; THENCE N49°22'14"W, 101.62 FEET; THENCE N76°47'19"W, 45.53 FEET; THENCE N49°51'52"W, 41.97 FEET; THENCE N07°47'15"E, 72.46 FEET; THENCE N02°12'30"E, 75.72 FEET; THENCE N23°11'30"W, 55.27 FEET; THENCE N11°16'59"W, 60.79 FEET; THENCE N10°00'31"W, 148.31 FEET; THENCE N03°42'25"W, 51.55 FEET; THENCE N39°04'10"E, 34.97 FEET; THENCE N50°55'50"W, 56.17 FEET; THENCE N69°01'01"W, 65.50 FEET TO A POINT ON THE EASTERLY RIGHT OF WAY LINE OF BUENA VISTA BOULEVARD PER OFFICIAL RECORDS BOOK 2332, PAGE 395, PUBLIC RECORDS OF SUMTER COUNTY, FLORIDA; THE FOLLOWING (12) TWELVE COURSES BEING ALONG SAID EASTERLY RIGHT OF WAY LINE OF BUENA VISTA BOULEVARD: THENCE N20°59'49"E, 41.76 FEET TO A POINT ON THE ARC OF A NON-TANGENT CURVE CONCAVE SOUTHERLY, HAVING A RADIUS OF 144.00 FEET AND A CHORD BEARING AND DISTANCE OF N71°51'18"W, 26.82 FEET TO WHICH A RADIAL LINE BEARS N23°29'20"E; THENCE WESTERLY ALONG THE ARC OF SAID CURVE, THROUGH A CENTRAL ANGLE OF 10°41'15", AN ARC DISTANCE OF 26.86 FEET TO THE POINT OF REVERSE CURVATURE OF A CURVE CONCAVE EASTERLY AND HAVING A RADIUS OF 2.50 FEET; THENCE NORTHERLY ALONG THE ARC OF SAID CURVE THROUGH A CENTRAL ANGLE OF 116°32'00", AN ARC DISTANCE OF 5.08 FEET TO THE POINT OF REVERSE CURVATURE OF A CURVE CONCAVE NORTHWESTERLY AND HAVING A RADIUS OF 105.00 FEET; THENCE NORTHEASTERLY ALONG THE ARC OF SAID CURVE THROUGH A CENTRAL ANGLE OF 11°50'07", AN ARC DISTANCE OF 21.69 FEET TO THE POINT OF REVERSE CURVATURE OF A CURVE CONCAVE SOUTHERLY AND HAVING A RADIUS OF 2.50 FEET; THENCE EASTERLY ALONG THE ARC OF SAID CURVE THROUGH A CENTRAL ANGLE OF 110°43'59", AN ARC DISTANCE OF 4.83 FEET TO THE POINT OF REVERSE CURVATURE OF A CURVE CONCAVE NORTHEASTERLY AND HAVING A RADIUS OF 99.00 FEET; THENCE SOUTHEASTERLY ALONG THE ARC OF SAID CURVE THROUGH A CENTRAL ANGLE OF 13°09'42", AN ARC DISTANCE OF 22.74 FEET TO A POINT ON A NON-TANGENT LINE; THENCE N26°58'16"E, 56.68 FEET TO A POINT ON THE ARC OF A NON-TANGENT CURVE CONCAVE EASTERLY, HAVING A RADIUS OF 50.00 FEET

AND A CHORD BEARING AND DISTANCE OF N20°50'01"W, 26.61 FEET TO WHICH A RADIAL LINE BEARS S53°44'05"W; THENCE NORTHERLY ALONG THE ARC OF SAID CURVE, THROUGH A CENTRAL ANGLE OF 30°51'46", AN ARC DISTANCE OF 26.93 FEET TO THE POINT OF REVERSE CURVATURE OF A CURVE CONCAVE WESTERLY AND HAVING A RADIUS OF 131.00 FEET; THENCE NORTHERLY ALONG THE ARC OF SAID CURVE THROUGH A CENTRAL ANGLE OF 29°39'32", AN ARC DISTANCE OF 67.81 FEET TO THE POINT OF REVERSE CURVATURE OF A CURVE CONCAVE EASTERLY AND HAVING A RADIUS OF 50.00 FEET; THENCE NORTHERLY ALONG THE ARC OF SAID CURVE THROUGH A CENTRAL ANGLE OF 47°24'18", AN ARC DISTANCE OF 41.37 FEET TO THE POINT OF TANGENCY; THENCE N12°20'37"E, 131.30 FEET TO THE POINT OF CURVATURE OF A CURVE CONCAVE EASTERLY AND HAVING A RADIUS OF 840.00 FEET; THENCE NORTHERLY ALONG THE ARC OF SAID CURVE THROUGH A CENTRAL ANGLE OF 19°08'32", AN ARC DISTANCE OF 280.64 FEET TO A POINT ON A NON-TANGENT LINE; THENCE S62°39'03"E, 146.42 FEET; THENCE S80°10'57"E, 23.25 FEET; THENCE N38°13'27"E, 92.58 FEET TO A POINT ON THE BOUNDARY LINE OF SAID AT&T EASEMENT PER OFFICIAL RECORDS BOOK 1895, PAGE 758; THE FOLLOWING (8) EIGHT COURSES BEING ALONG THE SOUTHERLY AND WESTERLY BOUNDARY LINES OF AT&T EASEMENT: THENCE S49°45'39"E, 151.02 FEET; THENCE S51°46'33"E, 558.34 FEET; THENCE S24°56'33"E, 37.05 FEET; THENCE S00°32'40"W, 525.34 FEET; THENCE S60°44'37"E, 834.76 FEET; THENCE S00°33'26"W, 362.42 FEET; THENCE N89°43'00"W, 401.79 FEET; THENCE S00°37'16"W, 618.11 FEET TO THE POINT OF BEGINNING.

AND

THAT LAND LYING IN SECTION 12, TOWNSHIP 19 SOUTH, RANGE 23 EAST, SUMTER COUNTY, FLORIDA, DESCRIBED AS FOLLOWS:

FROM THE SOUTHWEST CORNER OF THE SOUTHEAST 1/4 OF SAID SECTION 12 RUN N00°35'56"E, ALONG THE WEST LINE THEREOF A DISTANCE OF 880.92 FEET; THENCE DEPARTING SAID WEST LINE, S89°24'04"E, 1,556.91 FEET TO THE POINT OF BEGINNING; THENCE N80°03'32"E, 71.68 FEET; THENCE N83°52'57"E, 66.01 FEET; THENCE S61°32'20"E, 46.18 FEET; THENCE S04°31'14"E, 70.53 FEET; THENCE N68°12'40"W, 196.43 FEET TO THE POINT OF BEGINNING.

AND

THAT LAND LYING IN SECTION 12, TOWNSHIP 19 SOUTH, RANGE 23 EAST, SUMTER COUNTY, FLORIDA, DESCRIBED AS FOLLOWS:

FROM THE SOUTHWEST CORNER OF THE SOUTHEAST 1/4 OF SAID SECTION

12 RUN N00°35'56"E, ALONG THE WEST LINE THEREOF A DISTANCE OF 773.48 FEET; THENCE DEPARTING SAID WEST LINE, S89°24'04"E, 2,051.99 FEET TO THE POINT OF BEGINNING; THENCE N38°43'19"E, 35.12 FEET; THENCE N00°29'31"W, 270.52 FEET; THENCE N10°09'14"E, 71.20 FEET; THENCE N20°41'45"E, 71.44 FEET; THENCE N17°45'02"E, 92.10 FEET; THENCE N01°31'30"W, 92.18 FEET; THENCE N10°03'33"W, 158.96 FEET; THENCE N06°50'45"E, 67.13 FEET; THENCE N12°33'56"E, 66.94 FEET; THENCE N00°02'41"E, 77.54 FEET; THENCE N10°05'29"W, 193.56 FEET; THENCE N40°58'48"E, 174.73 FEET; THENCE N07°37'20"E, 261.56 FEET; THENCE N09°14'51"E, 286.71 FEET; THENCE N10°36'27"E, 138.30 FEET; THENCE N11°39'20"E, 320.20 FEET; THENCE N51°00'49"W, 381.84 FEET; THENCE N01°46'31"W, 106.49 FEET; THENCE N39°52'52"W, 13.15 FEET; THENCE S70°43'59"E, 299.94 FEET; THENCE S27°57'42"E, 308.82 FEET; THENCE S12°55'17"W, 845.77 FEET; THENCE S06°28'13"W, 336.43 FEET; THENCE S07°40'41"W, 227.19 FEET; THENCE S01°40'01"E, 98.86 FEET; THENCE S12°50'17"E, 235.32 FEET; THENCE S23°30'55"E, 181.38 FEET; THENCE S41°47'04"E, 172.12 FEET; THENCE S48°12'56"W, 233.65 FEET TO THE POINT OF CURVATURE OF A CURVE CONCAVE NORTHWESTERLY AND HAVING A RADIUS OF 474.00 FEET; THENCE SOUTHWESTERLY ALONG THE ARC OF SAID CURVE THROUGH A CENTRAL ANGLE OF 29°47'21", AN ARC DISTANCE OF 246.44 FEET TO THE POINT OF COMPOUND CURVATURE OF A CURVE CONCAVE NORTHERLY AND HAVING A RADIUS OF 600.00 FEET; THENCE WESTERLY ALONG THE ARC OF SAID CURVE THROUGH A CENTRAL ANGLE OF 04°05'37", AN ARC DISTANCE OF 42.87 FEET TO THE POINT OF BEGINNING.

42PPP-1.002 Boundary of the Amended District.

The boundaries of the district are those set forth in Exhibit "6" dated July 2013 and entered into the record during the August 14, 2013, administrative hearing conducted by the Division of Administrative Hearings (DOAH). The legal description of the boundaries of the amended district described in Exhibit "6" is hereby incorporated by reference, and available at <https://www.flrules.org/Gateway/reference.asp?No=Ref-03358>, and copies of which are available by contacting the Clerk of the Florida Land and Water Adjudicatory Commission at Office of the Governor, Room 1801, The Capitol, Tallahassee, Florida 32399-0001.

The total Village Community Development District No. 10 area = 1,588.8 acres, more or less.

Rulemaking Authority 190.005 FS, Law Implemented 190.004, 190.005, 190.046 FS, History—New 1-5-14.

NOTICE OF LOCAL PUBLIC HEARING

IN RE: PETITION TO EXPAND THE
VILLAGE COMMUNITY DEVELOPMENT
DISTRICT NO. 10

DOAH Case No. 13-1254

A local public hearing will be held at 1894 Laurel Manor Drive, The Villages, Florida, on Wednesday, August 14, 2013, at 10 a.m., at which an administrative law judge will receive testimony, evidence, and oral and written comments pertaining to the proposed expansion of the Village Community Development District No. 10. The area to be included in the district, if expanded, is as follows:

DESCRIPTION OF THE AREA TO BE ADDED VILLAGE COMMUNITY DEVELOPMENT DISTRICT NO. 10 APPROXIMATELY 99.3 ACRES

THAT LAND LYING IN SECTION 8, TOWNSHIP 19 SOUTH, RANGE 23 EAST, SUMTER COUNTY, FLORIDA, DESCRIBED AS FOLLOWS:

BEGIN AT THE INTERSECTION OF THE EASTERLY LINE OF KERL AND MILLERS SUBDIVISION FIRST ADDITION TO WILDWOOD, ACCORDING TO THE PLAT THEREOF AS RECORDED IN PLAT BOOK 2, PAGE 55, PUBLIC RECORDS OF SUMTER COUNTY, FLORIDA AND THE SOUTHERLY RIGHT OF WAY OF THE CSX RAILWAY; THENCE N24°48'19"E, ALONG THE NORTHEASTERLY EXTENSION THEREOF A DISTANCE OF 30.33 FEET TO THE SOUTHWESTERLY RIGHT OF WAY LINE OF COUNTY ROAD NO. 44A PER OFFICIAL RECORDS BOOK 2173, PAGE 643, PUBLIC RECORDS OF SUMTER COUNTY, FLORIDA; THENCE S65°10'12"E, ALONG SAID SOUTHWESTERLY RIGHT OF WAY LINE A DISTANCE OF 1,834.89 FEET TO THE POINT OF CURVATURE OF A CURVE CONCAVE WESTERLY AND HAVING A RADIUS OF 50.00 FEET; SAID POINT ALSO BEING ON THE WESTERLY RIGHT OF WAY LINE OF POWELL ROAD PER OFFICIAL RECORDS BOOK 2088, PAGE 199, PUBLIC RECORDS OF SUMTER COUNTY, FLORIDA; THE FOLLOWING (5) FIVE COURSES BEING ALONG SAID WESTERLY RIGHT OF WAY LINE OF POWELL ROAD: THENCE SOUTHERLY ALONG THE ARC OF SAID CURVE THROUGH A CENTRAL ANGLE OF 90°14'54", AN ARC DISTANCE OF 78.76 FEET TO THE POINT OF TANGENCY; THENCE S25°04'43"W, 30.65 FEET TO THE POINT OF CURVATURE OF A CURVE CONCAVE NORTHWESTERLY AND HAVING A RADIUS OF 690.00 FEET; THENCE SOUTHWESTERLY ALONG THE ARC OF SAID CURVE THROUGH A CENTRAL ANGLE OF 38°11'57", AN ARC DISTANCE OF 460.02 FEET TO THE POINT OF TANGENCY; THENCE S63°16'39"W, 330.88 FEET TO THE POINT OF CURVATURE OF A CURVE CONCAVE SOUTHEASTERLY AND HAVING A RADIUS OF 760.00 FEET; THENCE SOUTHWESTERLY ALONG THE ARC OF SAID CURVE THROUGH A CENTRAL ANGLE OF 27°47'37", AN ARC DISTANCE OF 368.67 FEET TO A POINT ON A NON-TANGENT LINE; THENCE DEPARTING SAID WESTERLY RIGHT OF WAY LINE RUN N66°22'30"W, 309.36 FEET; THENCE N69°21'04"W, 40.55 FEET; THENCE N75°37'23"W, 40.55 FEET; THENCE N82°26'11"W, 47.51 FEET; THENCE N86°19'02"W, 51.75 FEET; THENCE N81°27'56"W, 61.87 FEET; THENCE N75°49'16"W, 61.91 FEET; THENCE N70°02'15"W, 57.09 FEET; THENCE N65°11'41"W, 716.85 FEET TO A POINT ON THE SOUTHWESTERLY EXTENSION OF SAID EASTERLY LINE OF KERL AND MILLER SUBDIVISION; THENCE N24°48'19"E, ALONG SAID SOUTHWESTERLY EXTENSION AND EASTERLY LINE A DISTANCE OF 1,151.34 FEET TO THE POINT OF BEGINNING.

AND

THAT LAND LYING IN SECTIONS 9 AND 16, TOWNSHIP 19 SOUTH, RANGE 23 EAST, SUMTER COUNTY, FLORIDA, DESCRIBED AS FOLLOWS:

COMMENCE AT THE INTERSECTION OF THE WESTERLY LINE OF OAK PARK, ACCORDING TO THE PLAT THEREOF AS RECORDED IN PLAT BOOK 4, PAGE 32, PUBLIC RECORDS OF SUMTER COUNTY, FLORIDA AND THE NORTHERLY RIGHT OF WAY OF STATE ROAD NO. 44 PER FLORIDA DEPARTMENT OF TRANSPORTATION RIGHT-OF-WAY MAP, SECTION #18070-2518; THE FOLLOWING (5) FIVE COURSES BEING ALONG THE NORTHEASTERLY RIGHT OF WAY LINE OF STATE ROAD NO. 44 PER FLORIDA DEPARTMENT OF TRANSPORTATION RIGHT OF WAY MAP, SECTION NO. 18070-2518: THENCE N67°34'23"W, 21.54 FEET TO THE POINT OF BEGINNING; SAID POINT BEING ON THE WEST LINE OF AT&T EASEMENT PER OFFICIAL RECORDS BOOK 1895, PAGE 758, PUBLIC RECORDS OF SUMTER COUNTY, FLORIDA; THENCE CONTINUE N67°34'23"W, 250.31 FEET; THENCE N65°48'19"W, 300.48 FEET; THENCE N64°37'01"W, 200.60 FEET; THENCE N65°58'19"W, 285.16 FEET; THENCE DEPARTING SAID NORTHEASTERLY RIGHT OF WAY LINE N24°01'41"E, 65.68 FEET; THENCE N32°23'55"E, 140.60 FEET; THENCE N04°46'45"E, 73.00 FEET; THENCE N01°10'58"W, 52.54 FEET; THENCE N04°23'35"W, 51.25 FEET; THENCE N28°44'18"W, 65.15 FEET; THENCE N01°43'08"E, 42.10 FEET; THENCE N15°39'56"W, 256.37 FEET; THENCE N49°22'14"W, 101.62 FEET; THENCE N76°47'19"W, 45.53 FEET; THENCE N49°51'52"W, 41.97 FEET; THENCE N07°47'15"E, 72.46 FEET; THENCE N02°12'30"E, 75.72 FEET; THENCE N23°11'30"W, 55.27 FEET; THENCE N11°16'59"W, 60.79 FEET; THENCE N10°00'31"W, 148.31 FEET; THENCE N03°42'25"W, 51.55 FEET; THENCE N39°04'10"E, 34.97 FEET; THENCE N50°55'50"W, 56.17 FEET; THENCE N69°01'01"W, 65.50 FEET TO A POINT ON THE EASTERLY RIGHT OF WAY LINE OF BUENA VISTA BOULEVARD PER OFFICIAL RECORDS BOOK 2332, PAGE 395, PUBLIC RECORDS OF SUMTER COUNTY, FLORIDA; THE FOLLOWING (12) TWELVE COURSES BEING ALONG SAID EASTERLY RIGHT OF WAY LINE OF BUENA VISTA BOULEVARD: THENCE N20°59'49"E, 41.76 FEET TO A POINT ON THE ARC OF A NON-TANGENT CURVE CONCAVE SOUTHERLY, HAVING A RADIUS OF 144.00 FEET AND A CHORD BEARING AND DISTANCE OF N71°51'18"W, 26.82 FEET TO WHICH A RADIAL LINE BEARS N23°29'20"E; THENCE WESTERLY ALONG THE ARC OF SAID CURVE, THROUGH A CENTRAL ANGLE OF 10°41'15", AN ARC DISTANCE OF 26.86 FEET TO THE POINT OF REVERSE CURVATURE OF A CURVE CONCAVE EASTERLY AND HAVING A RADIUS OF 2.50 FEET; THENCE NORTHERLY ALONG THE ARC OF SAID CURVE THROUGH A CENTRAL ANGLE OF 116°32'00", AN ARC DISTANCE OF 5.08 FEET TO THE POINT OF REVERSE CURVATURE OF A CURVE CONCAVE NORTHWESTERLY AND HAVING A RADIUS OF 105.00 FEET; THENCE NORTHEASTERLY ALONG THE ARC OF SAID CURVE THROUGH A CENTRAL ANGLE OF 11°50'07", AN ARC DISTANCE OF 21.69 FEET TO THE POINT OF REVERSE CURVATURE OF A CURVE CONCAVE SOUTHERLY AND HAVING A RADIUS OF 2.50 FEET; THENCE EASTERLY ALONG

ERLY, HAVING A RADIUS OF 50.00 FEET AND A CHORD BEARING AND DISTANCE OF N20°30'01"W, 28.01 FEET TO WHICH A RADIAL LINE BEARS S63°44'05"W; THENCE NORTHERLY ALONG THE ARC OF SAID CURVE, THROUGH A CENTRAL ANGLE OF 30°51'46", AN ARC DISTANCE OF 26.93 FEET TO THE POINT OF REVERSE CURVATURE OF A CURVE CONCAVE WESTERLY AND HAVING A RADIUS OF 131.00 FEET; THENCE NORTHERLY ALONG THE ARC OF SAID CURVE THROUGH A CENTRAL ANGLE OF 29°39'32", AN ARC DISTANCE OF 67.81 FEET TO THE POINT OF REVERSE CURVATURE OF A CURVE CONCAVE EASTERLY AND HAVING A RADIUS OF 50.00 FEET; THENCE NORTHERLY ALONG THE ARC OF SAID CURVE THROUGH A CENTRAL ANGLE OF 47°24'18", AN ARC DISTANCE OF 41.37 FEET TO THE POINT OF TANGENCY; THENCE N12°20'37"E, 131.30 FEET TO THE POINT OF CURVATURE OF A CURVE CONCAVE EASTERLY AND HAVING A RADIUS OF 840.00 FEET; THENCE NORTHERLY ALONG THE ARC OF SAID CURVE THROUGH A CENTRAL ANGLE OF 19°08'32", AN ARC DISTANCE OF 280.64 FEET TO A POINT ON A NON-TANGENT LINE; THENCE S62°39'03"E, 146.42 FEET; THENCE S80°10'57"E, 23.25 FEET; THENCE N38°13'27"E, 92.58 FEET TO A POINT ON THE BOUNDARY LINE OF SAID AT&T EASEMENT PER OFFICIAL RECORDS BOOK 1895, PAGE 758; THE FOLLOWING (8) EIGHT COURSES BEING ALONG THE SOUTHERLY AND WESTERLY BOUNDARY LINES OF AT&T EASEMENT: THENCE S49°45'39"E, 151.02 FEET; THENCE S51°46'33"E, 558.34 FEET; THENCE S24°56'33"E, 37.05 FEET; THENCE S00°32'40"W, 525.34 FEET; THENCE S60°44'37"E, 834.76 FEET; THENCE S00°33'26"W, 362.42 FEET; THENCE N89°43'00"W, 401.79 FEET; THENCE S00°37'16"W, 618.11 FEET TO THE POINT OF BEGINNING.

AND

THAT LAND LYING IN SECTION 12, TOWNSHIP 19 SOUTH, RANGE 23 EAST, SUMTER COUNTY, FLORIDA, DESCRIBED AS FOLLOWS:

FROM THE SOUTHWEST CORNER OF THE SOUTHEAST 1/4 OF SAID SECTION 12 RUN N00°35'56"E, ALONG THE WEST LINE THEREOF A DISTANCE OF 880.92 FEET; THENCE DEPARTING SAID WEST LINE, S89°24'04"E, 1,556.91 FEET TO THE POINT OF BEGINNING; THENCE N80°03'32"E, 71.68 FEET; THENCE N83°52'57"E, 66.01 FEET; THENCE S61°32'20"E, 46.18 FEET; THENCE S04°31'14"E, 70.53 FEET; THENCE N68°12'40"W, 196.43 FEET TO THE POINT OF BEGINNING.

AND

THAT LAND LYING IN SECTION 12, TOWNSHIP 19 SOUTH, RANGE 23 EAST, SUMTER COUNTY, FLORIDA, DESCRIBED AS FOLLOWS:

FROM THE SOUTHWEST CORNER OF THE SOUTHEAST 1/4 OF SAID SECTION 12 RUN N00°35'56"E, ALONG THE WEST LINE THEREOF A DISTANCE OF 773.48 FEET; THENCE DEPARTING SAID WEST LINE, S89°24'04"E, 2,051.99 FEET TO THE POINT OF BEGINNING; THENCE N38°43'19"E, 35.12 FEET; THENCE N00°29'31"W, 270.52 FEET; THENCE N10°09'14"E, 71.20 FEET; THENCE N20°41'45"E, 71.44 FEET; THENCE N17°45'02"E, 92.10 FEET; THENCE N01°31'30"W, 92.18 FEET; THENCE N10°03'33"W, 158.96 FEET; THENCE N06°50'45"E, 67.13 FEET; THENCE N12°33'56"E, 66.94 FEET; THENCE N00°02'41"E, 77.54 FEET; THENCE N10°05'29"W, 193.56 FEET; THENCE N40°58'48"E, 174.73 FEET; THENCE N07°37'20"E, 261.56 FEET; THENCE N09°14'51"E, 286.71 FEET; THENCE N10°36'27"E, 138.30 FEET; THENCE N11°39'20"E, 320.20 FEET; THENCE N51°00'49"W, 381.84 FEET; THENCE N01°46'31"W, 106.49 FEET; THENCE N39°52'52"W, 13.15 FEET; THENCE S70°43'59"E, 299.94 FEET; THENCE S27°57'42"E, 308.82 FEET; THENCE S12°55'17"W, 846.77 FEET; THENCE S06°28'13"W, 336.43 FEET; THENCE S07°40'41"W, 227.19 FEET; THENCE S01°40'01"E, 98.86 FEET; THENCE S12°50'17"E, 235.32 FEET; THENCE S23°30'55"E, 181.38 FEET; THENCE S41°47'04"E, 172.12 FEET; THENCE S48°12'56"W, 233.65 FEET TO THE POINT OF CURVATURE OF A CURVE CONCAVE NORTHWESTERLY AND HAVING A RADIUS OF 474.00 FEET; THENCE SOUTHWESTERLY ALONG THE ARC OF SAID CURVE THROUGH A CENTRAL ANGLE OF 29°47'21", AN ARC DISTANCE OF 246.44 FEET TO THE POINT OF COMPOUND CURVATURE OF A CURVE CONCAVE NORTHERLY AND HAVING A RADIUS OF 600.00 FEET; THENCE WESTERLY ALONG THE ARC OF SAID CURVE THROUGH A CENTRAL ANGLE OF 04°05'37", AN ARC DISTANCE OF 42.87 FEET TO THE POINT OF BEGINNING.

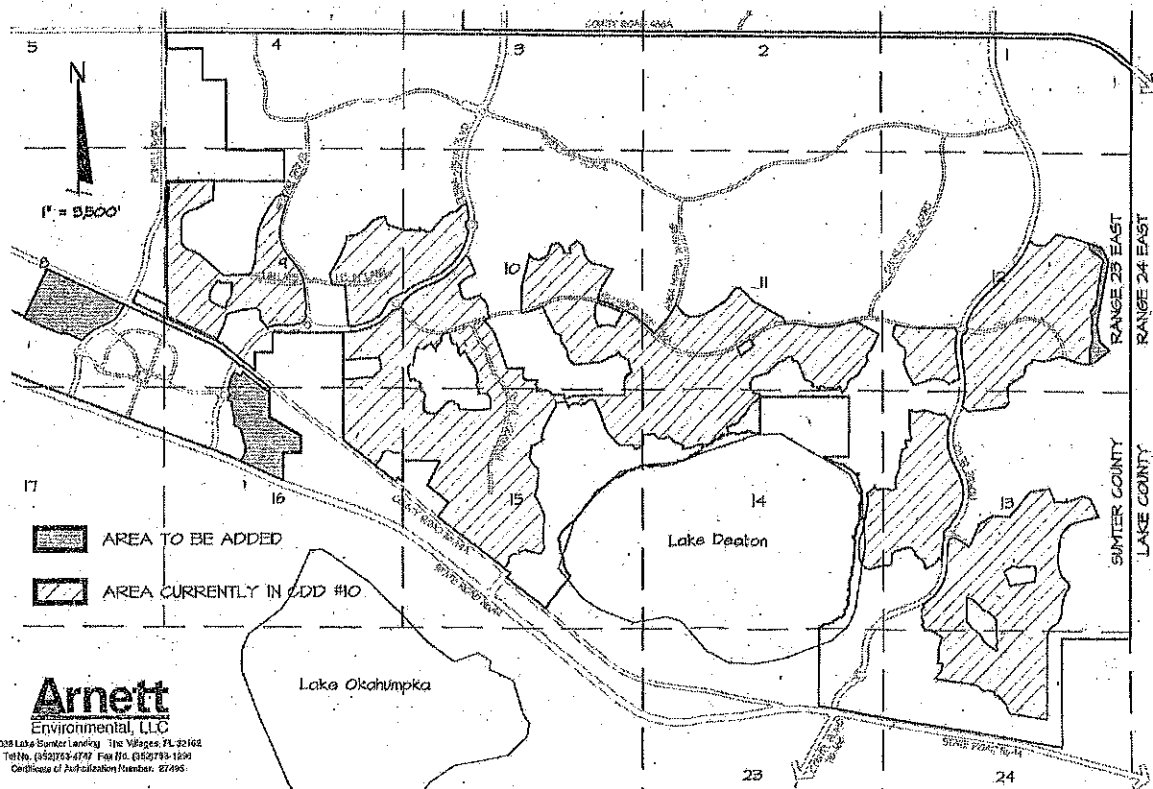

NOTICE OF LOCAL PUBLIC HEARING

IN RE: PETITION TO EXPAND THE
VILLAGE COMMUNITY DEVELOPMENT
DISTRICT NO. 10

DOAH Case No. 13-1254

A local public hearing will be held at 1894 Laurel Manor Drive, The Villages, Florida, on Wednesday, August 14, 2013, at 10 a.m., at which an administrative law judge will receive testimony, evidence, and oral and written comments pertaining to the proposed expansion of the Village Community Development District No. 10. The area to be included in the district, if expanded, is as follows:

DESCRIPTION OF THE AREA TO BE ADDED VILLAGE COMMUNITY DEVELOPMENT DISTRICT NO. 10 APPROXIMATELY 89.5 ACRES

THAT LAND LYING IN SECTION 8, TOWNSHIP 19 SOUTH, RANGE 23 EAST, SUMTER COUNTY, FLORIDA, DESCRIBED AS FOLLOWS:

BEGIN AT THE INTERSECTION OF THE EASTERLY LINE OF KERL AND MILLERS SUBDIVISION FIRST ADDITION TO WILDWOOD, ACCORDING TO THE PLAT THEREOF AS RECORDED IN PLAT BOOK 2, PAGE 55, PUBLIC RECORDS OF SUMTER COUNTY, FLORIDA AND THE SOUTHERLY RIGHT OF WAY OF THE CSX RAILWAY; THENCE N24°48'19"E, ALONG THE NORTHEASTERLY EXTENSION THEREOF A DISTANCE OF 30.33 FEET TO THE SOUTHWESTERLY RIGHT OF WAY LINE OF COUNTY ROAD NO. 44A PER OFFICIAL RECORDS BOOK 2173, PAGE 643, PUBLIC RECORDS OF SUMTER COUNTY, FLORIDA; THENCE S65°10'12"E, ALONG SAID SOUTHWESTERLY RIGHT OF WAY LINE A DISTANCE OF 1,834.89 FEET TO THE POINT OF CURVATURE OF A CURVE CONCAVE WESTERLY AND HAVING A RADIUS OF 50.00 FEET; SAID POINT ALSO BEING ON THE WESTERLY RIGHT OF WAY LINE OF POWELL ROAD PER OFFICIAL RECORDS BOOK 2088, PAGE 199, PUBLIC RECORDS OF SUMTER COUNTY, FLORIDA; THE FOLLOWING (5) FIVE COURSES BEING ALONG SAID WESTERLY RIGHT OF WAY LINE OF POWELL ROAD: THENCE SOUTHERLY ALONG THE ARC OF SAID CURVE THROUGH A CENTRAL ANGLE OF 90°14'54", AN ARC DISTANCE OF 78.76 FEET TO THE POINT OF TANGENCY; THENCE S25°04'43"W, 30.65 FEET TO THE POINT OF CURVATURE OF A CURVE CONCAVE NORTHWESTERLY AND HAVING A RADIUS OF 690.00 FEET; THENCE SOUTHWESTERLY ALONG THE ARC OF SAID CURVE THROUGH A CENTRAL ANGLE OF 38°11'57", AN ARC DISTANCE OF 460.02 FEET TO THE POINT OF TANGENCY; THENCE S63°16'39"W, 330.88 FEET TO THE POINT OF CURVATURE OF A CURVE CONCAVE SOUTHEASTERLY AND HAVING A RADIUS OF 760.00 FEET; THENCE SOUTHWESTERLY ALONG THE ARC OF SAID CURVE THROUGH A CENTRAL ANGLE OF 27°47'37", AN ARC DISTANCE OF 368.67 FEET TO A POINT ON A NON-TANGENT LINE; THENCE DEPARTING SAID WESTERLY RIGHT OF WAY LINE RUN N66°22'30"W, 309.36 FEET; THENCE N69°21'04"W, 40.55 FEET; THENCE N75°37'23"W, 40.55 FEET; THENCE N82°26'11"W, 47.51 FEET; THENCE N86°19'02"W, 51.75 FEET; THENCE N81°27'56"W, 61.87 FEET; THENCE N75°49'16"W, 61.91 FEET; THENCE N70°02'15"W, 57.09 FEET; THENCE N65°11'41"W, 716.85 FEET TO A POINT ON THE SOUTHWESTERLY EXTENSION OF SAID EASTERLY LIEN OF KERL AND MILLER SUBDIVISION; THEN N24°48'19"E, ALONG SAID

SOUTHWESTERLY EXTENSION AND EASTERLY LINE A DISTANCE OF 1,151.34 FEET TO THE POINT OF BEGINNING.

AND

THAT LAND LYING IN SECTIONS 9 AND 16, TOWNSHIP 19 SOUTH, RANGE 23 EAST, SUMTER COUNTY, FLORIDA, DESCRIBED AS FOLLOWS:

COMMENCE AT THE INTERSECTION OF THE WESTERLY LINE OF OAK PARK, ACCORDING TO THE PLAT THEREOF AS RECORDED IN PLAT BOOK 4, PAGE 32, PUBLIC RECORDS OF SUMTER COUNTY, FLORIDA AND THE NORTHERLY RIGHT OF WAY OF STATE ROAD NO. 44 PER FLORIDA DEPARTMENT OF TRANSPORTATION RIGHT-OF-WAY MAP, SECTION #18070-2518; THE FOLLOWING (5) FIVE COURSES BEING ALONG THE NORTHEASTERLY RIGHT OF WAY LINE OF STATE ROAD NO. 44 PER FLORIDA DEPARTMENT OF TRANSPORTATION RIGHT OF WAY MAP, SECTION NO. 18070-2518: THENCE N67°34'23"W, 21.54 FEET TO THE POINT OF BEGINNING; SAID POINT BEING ON THE WEST LINE OF AT&T EASEMENT PER OFFICIAL RECORDS BOOK 1895, PAGE 758, PUBLIC RECORDS OF SUMTER COUNTY, FLORIDA; THENCE CONTINUE N67°34'23"W, 250.31 FEET; THENCE N65°48'19"W, 300.48 FEET; THENCE N64°37'01"W, 200.60 FEET; THENCE N65°58'19"W, 285.16 FEET; THENCE N64°37'01"W, 200.60 FEET; THENCE N65°58'19"W, 285.16 FEET; THENCE DEPARTING SAID NORTHEASTERLY RIGHT OF WAY LINE N24°01'41"E, 65.68 FEET; THENCE N32°23'55"E, 140.60 FEET; THENCE N04°46'45"E, 73.00 FEET; THENCE N01°10'58"W, 52.54 FEET; THENCE N04°23'35"W, 51.25 FEET; THENCE N28°44'18"W, 65.15 FEET; THENCE N01°43'08"E, 42.10 FEET; THENCE N15°39'56"W, 256.37 FEET; THENCE N49°22'14"W, 101.62 FEET; THENCE N76°47'19"W, 45.53 FEET; THENCE N49°51'52"W, 41.97 FEET; THENCE N07°47'15"E, 72.46 FEET; THENCE N02°12'30"E, 75.72 FEET; THENCE N23°11'30"W, 55.27 FEET; THENCE N11°16'59"W, 60.79 FEET; THENCE N10°00'31"W, 148.31 FEET; THENCE N03°42'25"W, 51.55 FEET; THENCE N39°04'10"E, 34.97 FEET; THENCE N50°55'50"W, 56.17 FEET; THENCE N69°01'01"W, 65.50 FEET TO A POINT ON THE EASTERLY RIGHT OF WAY LINE OF BUENA VISTA BOULEVARD PER OFFICIAL RECORDS BOOK 2332, PAGE 395, PUBLIC RECORDS OF SUMTER COUNTY, FLORIDA; THE FOLLOWING (12) TWELVE COURSES BEING ALONG SAID EASTERLY RIGHT OF WAY LINE OF BUENA VISTA BOULEVARD: THENCE N20°59'49"E, 41.76 FEET TO A POINT ON THE ARC OF A NON-TANGENT CURVE CONCAVE SOUTHERLY, HAVING A RADIUS OF 144.00 FEET AND A CHORD BEARING AND DISTANCE OF N71°51'18"W, 26.82 FEET TO WHICH A RADIAL LINE BEARS N23°29'20"E; THENCE WESTERLY ALONG THE ARC OF SAID CURVE, THROUGH A CENTRAL ANGLE OF 10°41'15", AN ARC DISTANCE OF 26.86 FEET TO THE POINT OF REVERSE CURVATURE OF A CURVE CONCAVE EASTERLY AND HAVING A RADIUS OF 2.50 FEET; THENCE NORTHERLY ALONG THE ARC OF SAID CURVE THROUGH A CENTRAL ANGLE OF 116°32'00", AN ARC DISTANCE OF 5.08 FEET TO THE POINT OF REVERSE CURVATURE OF A CURVE CONCAVE NORTHWESTERLY AND HAVING A RADIUS OF 105.00 FEET; THEN NORTHEASTERLY ALONG THE ARC OF SAID CURVE THROUGH A CENTRAL ANGLE OF 11°50'07", AN ARC DISTANCE OF 21.69 FEET TO THE POINT OF REVERSE CURVATURE OF A CURVE CONCAVE SOUTHERLY AND HAVING A RADIUS OF 2.50 FEET; THENCE EASTERLY ALONG THE ARC OF SAID CURVE THROUGH A CENTRAL ANGLE OF 110°43'59", AN ARC DISTANCE OF 4.83 FEET TO THE POINT OF REVERSE CURVATURE OF A CURVE CONCAVE NORTHEASTERLY AND HAVING A RADIUS OF 9900 FEET; THENCE SOUTHEASTERLY ALONG THE ARC OF SAID CURVE THROUGH A CENTRAL ANGLE OF 13°09'42", AN ARC DISTANCE OF 22.74 FEET TO A POINT ON A NON-TANGENT LINE; THENCE N26°58'16"E, 56.68 FEET TO A POINT ON THE ARC OF A

NON-TANGENT CURVE CONCAVE EASTERLY, HAVING A RADIUS OF 50.00 FEET AND A CHORD BEARING AND DISTANCE OF N20°50'01"W, 26.61 FEET TO WHICH A RADIAL LINE BEARS S53°44'05"W; THENCE NORTHERLY ALONG THE ARC OF SAID CURVE, THROUGH A CENTRAL ANGLE OF 30°51'46", AN ARC DISTANCE OF 26.93 FEET TO THE POINT OF REVERSE CURVATURE OF A CURVE CONCAVE WESTERLY AND HAVING A RADIUS OF 131.00 FEET; THENCE NORTHERLY ALONG THE ARC OF SAID CURVE THROUGH A CENTRAL ANGLE OF 29°39'32", AN ARC DISTANCE OF 67.81 FEET TO THE POINT OF REVERSE CURVATURE OF A CURVE CONCAVE EASTERLY AND HAVING A RADIUS OF 50.00 FEET; THENCE NORTHERLY ALONG THE ARC OF SAID CURVE THROUGH A CENTRAL ANGLE OF 47°24'18", AN ARC DISTANCE OF 41.37 FEET TO THE POINT OF TANGENCY; THENCE N12°20'37"E, 131.30 FEET TO THE POINT OF CURVATURE OF A CURVE CONCAVE EASTERLY AND HAVING A RADIUS OF 840.00 FEET; THENCE NORTHERLY ALONG THE ARC OF SAID CURVE THROUGH A CENTRAL ANGLE OF 19°08'32", AN ARC DISTANCE OF 280.64 FEET TO A POINT ON A NON-TANGENT LINE; THENCE S62°39'03"E, 146.42 FEET; THENCE S80°10'57"E, 23.25 FEET; THENCE N38°13'27"E, 92.58 FEET TO A POINT ON THE BOUNDARY LINE OF SAID AT&T EASEMENT PER OFFICIAL RECORDS BOOK 1895, PAGE 758; THE FOLLOWING (8) EIGHT COURSES BEING ALONG THE SOUTHERLY AND WESTERLY BOUNARY LINES OF AT&T EASEMENT: THENCE S49°45'39"E, 151.02 FEET; THENCE S51°46'33"E, 558.34 FEET; THENCE S24°56'33"E, 37.05 FEET; THENCE S00°32'40"W, 525.34 FEET; THENCE S60°44'37"E, 834.76 FEET; THENCE S00°33'26"W, 362.42 FEET; THENCE N89°43'00"W, 401.79 FEET; THENCE S00°37'16"W, 618.11 FEET TO THE POINT OF BEGINNING.

[Map of the Expanded District]



Area to be added



Area currently in CDD #10

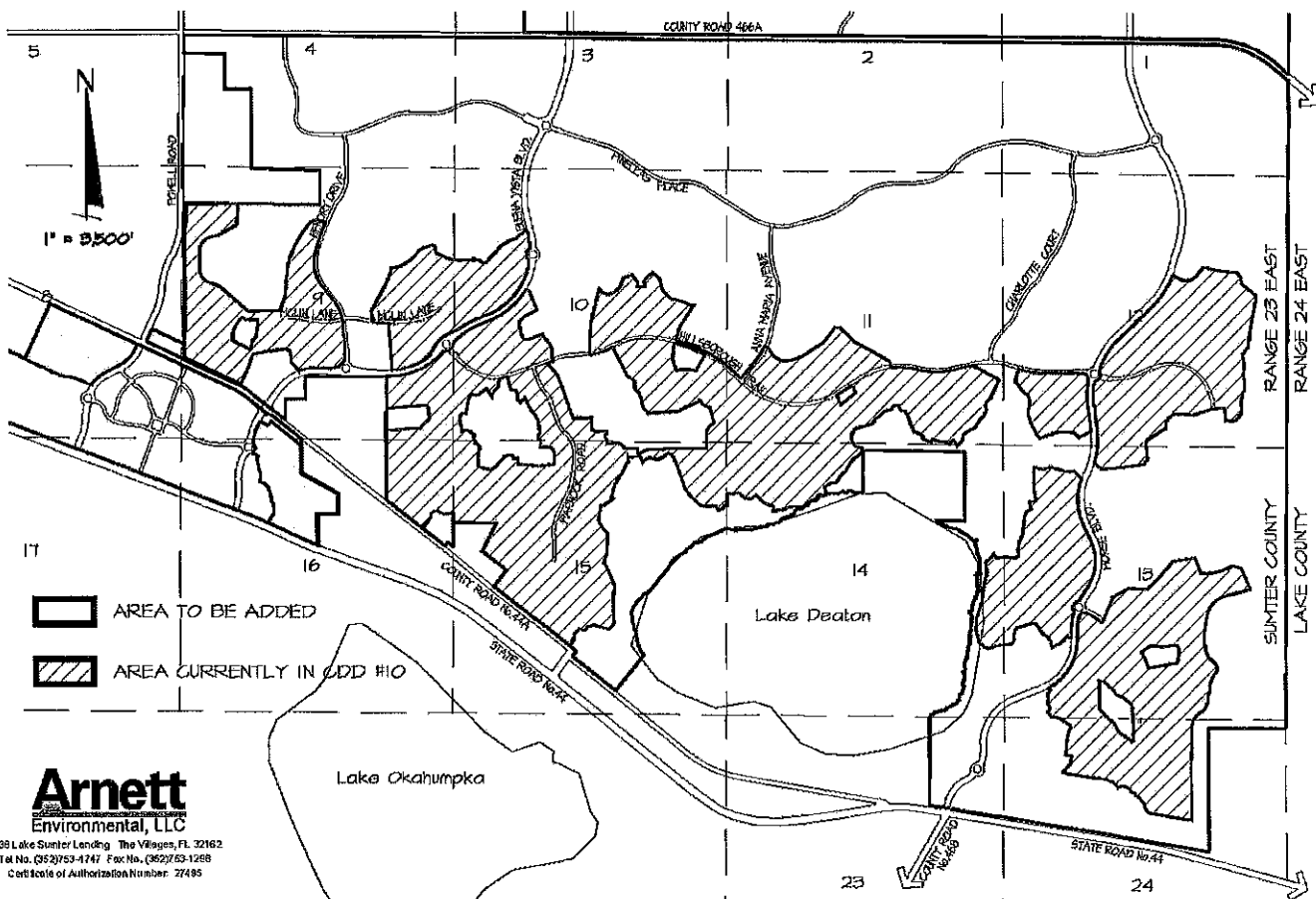

Arnett
Environmental, LLC

1038 Lake Sumter Landing The Villages, FL 32162
Tel No. (352) 753-4747 Fax No. (352) 753-1268
Certificate of Authorization Number: 27495