

ORDINANCE NO. 2010- 09

AN ORDINANCE OF THE BOARD OF COUNTY COMMISSIONERS OF SUMTER COUNTY, FLORIDA, AMENDING ORDINANCE 04-38 TO AMEND THE BOUNDARY OF THE VILLAGE COMMUNITY DEVELOPMENT DISTRICT NO. 10; PROVIDING FOR SEVERABILITY; AND PROVIDING FOR AN EFFECTIVE DATE.

WHEREAS, the Board of County Commissioners established the Village Community Development District No. 10 ("District") by Ordinance 04-38; and

WHEREAS, in the process of going forward with development activities it has come to the attention of the developer that additional changes are necessary in the boundary to reconfigure and add 399.01 acres.

NOW THEREFORE, BE IT ORDAINED by the Board of County Commissioners of Sumter County, Florida, as follows:

Section 1. Ordinance 04-38 is hereby amended so that the external boundary of the District shall be as per Exhibit "A" attached hereto.

Section 2. All ordinances or parts of ordinances in conflict herewith be and the same are hereby repealed to the extent of such conflict.

Section 3. If any section, sentence, clause, or phrase of this ordinance is held to be invalid or unconstitutional by a court of competent jurisdiction, then said holding shall in no way affect the validity of the remaining portions of this ordinance.

Section 4. This ordinance shall become effective in accordance with law.

PASSED this 11 day of May, 2010.

ATTEST: GLORIA HAYWARD
CLERK OF CIRCUIT COURT

**BOARD OF COUNTY COMMISSIONERS
SUMTER COUNTY, FLORIDA**



[Signature]

DEPUTY CLERK

[Signature]
DOUG GILPIN, CHAIRMAN



STATE OF FLORIDA, COUNTY OF SUMTER
I HEREBY CERTIFY, that the above and foregoing is a true copy of the original.
By *[Signature]* Clerk of Circuit Court
Deputy Clerk

Dated 5-13-10

EXHIBIT A

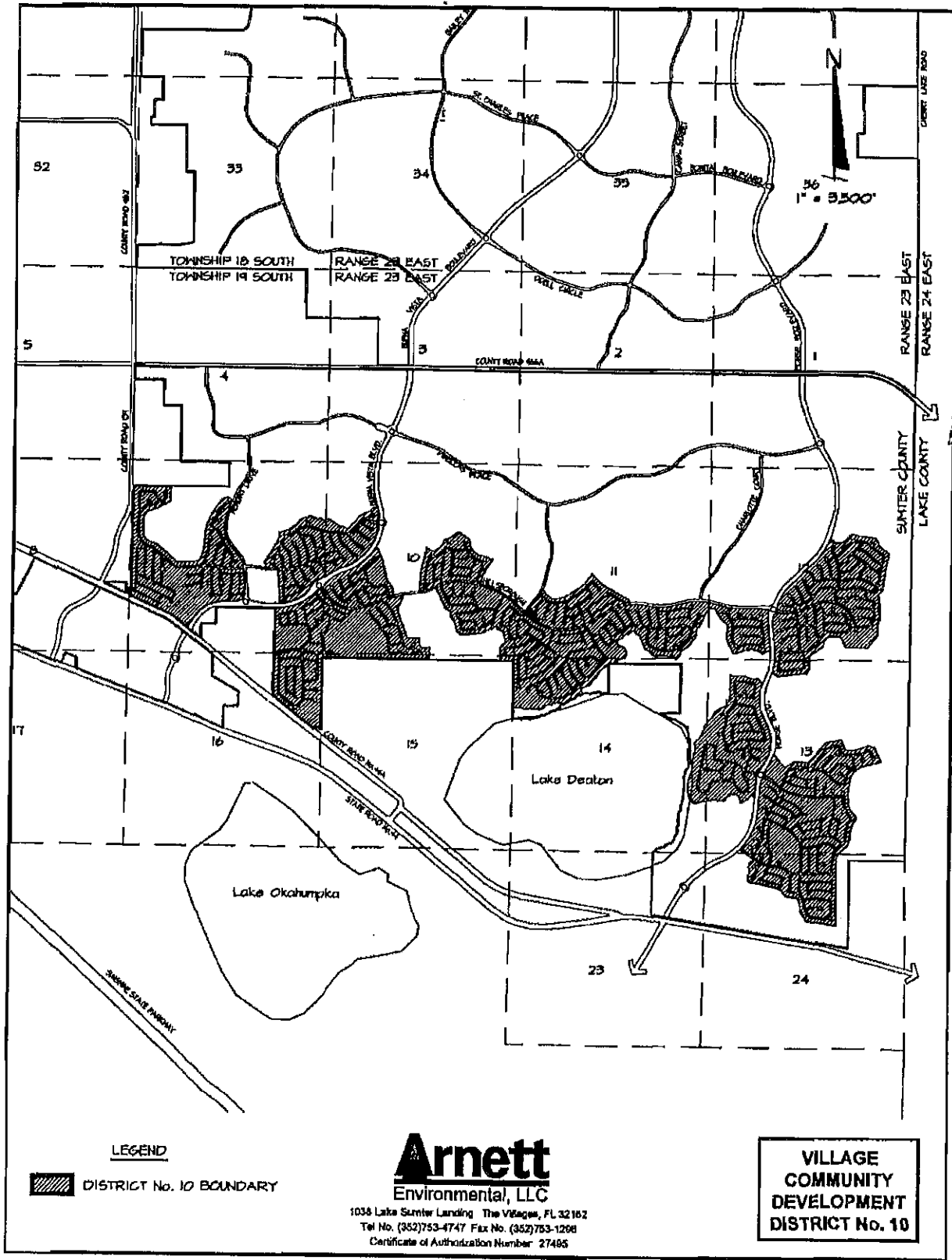

AMENDED VILLAGE COMMUNITY DEVELOPMENT DISTRICT No. 10

EXHIBIT "A"

DESCRIPTION OF THE AMENDED VILLAGE COMMUNITY DEVELOPMENT DISTRICT NO. 10 APPROXIMATELY 1397.81 ACRES

THAT LAND LYING IN SECTIONS 13 AND 14, TOWNSHIP 19 SOUTH, RANGE 23 EAST, SUMTER COUNTY, FLORIDA, DESCRIBED AS FOLLOWS:

FROM THE NORTHWEST CORNER OF THE NORTHWEST 1/4 OF SAID SECTION 13 RUN N89°59'36"E, ALONG THE NORTH LINE THEREOF A DISTANCE OF 685.41 FEET; THENCE DEPARTING SAID NORTH LINE, S00°00'24"E, 276.62 FEET TO THE POINT OF BEGINNING; THENCE S80°25'08"E, 36.20 FEET; THENCE S67°46'10"E, 81.60 FEET; THENCE N85°41'58"E, 78.87 FEET; THENCE N74°47'17"E, 43.93 FEET; THENCE N79°58'31"E, 45.29 FEET; THENCE N85°46'04"E, 56.05 FEET; THENCE S80°18'02"E, 68.54 FEET; THENCE S74°00'37"E, 54.75 FEET; THENCE S55°44'18"E, 30.11 FEET; THENCE S71°55'17"E, 70.81 FEET; THENCE S76°16'44"E, 77.56 FEET; THENCE S84°56'19"E, 70.47 FEET; THENCE N84°42'06"E, 53.13 FEET; THENCE N74°31'50"E, 36.93 FEET; THENCE S42°14'37"E, 151.22 FEET; THENCE S68°48'09"E, 45.00 FEET TO A POINT ON THE ARC OF A CURVE CONCAVE EASTERLY, HAVING A RADIUS OF 1,180.00 FEET AND A CHORD BEARING AND DISTANCE OF S02°01'26"E, 930.52 FEET; THENCE SOUTHERLY ALONG THE ARC OF SAID CURVE, THROUGH A CENTRAL ANGLE OF 46°26'35", A DISTANCE OF 956.49 FEET; THENCE S25°14'44"E, 293.76 FEET TO THE POINT OF CURVATURE OF A CURVE CONCAVE WESTERLY AND HAVING A RADIUS OF 965.00 FEET; THENCE SOUTHERLY ALONG THE ARC THEREOF THROUGH A CENTRAL ANGLE OF 63°39'24", A DISTANCE OF 1,072.13 FEET TO THE POINT OF REVERSE CURVATURE OF A CURVE CONCAVE SOUTHEASTERLY AND HAVING A RADIUS OF 1,060.00 FEET; THENCE SOUTHWESTERLY ALONG THE ARC OF SAID CURVE THROUGH A CENTRAL ANGLE OF 10°06'48", A DISTANCE OF 187.10 FEET TO THE POINT OF REVERSE CURVATURE OF A CURVE CONCAVE NORTHWESTERLY AND HAVING A RADIUS OF 75.00 FEET; THENCE SOUTHWESTERLY ALONG THE ARC OF SAID CURVE THROUGH A CENTRAL ANGLE OF 42°31'13", A DISTANCE OF 55.66 FEET TO THE POINT OF REVERSE CURVATURE OF A CURVE CONCAVE EASTERLY AND HAVING A RADIUS OF 120.00 FEET; THENCE SOUTHERLY ALONG THE ARC OF SAID CURVE THROUGH A CENTRAL ANGLE OF 100°11'12", A DISTANCE OF 209.83 FEET TO THE POINT OF REVERSE CURVATURE OF A CURVE CONCAVE WESTERLY AND HAVING A RADIUS OF 75.00 FEET; THENCE SOUTHERLY ALONG THE ARC OF SAID CURVE THROUGH A CENTRAL ANGLE OF 42°31'13", A DISTANCE OF 55.66 FEET TO THE POINT OF REVERSE CURVATURE OF A CURVE CONCAVE EASTERLY AND HAVING A RADIUS OF 1,060.00 FEET; THENCE SOUTHERLY ALONG THE ARC OF SAID CURVE THROUGH A CENTRAL ANGLE OF 08°33'50", A DISTANCE OF 158.43 FEET; THENCE S04°35'16"W, 320.23 FEET; THENCE N85°24'44"W, 45.00 FEET; THENCE N48°12'17"W, 57.50 FEET; THENCE S39°43'04"W, 145.59 FEET; THENCE S60°16'41"W, 135.39 FEET; THENCE S63°44'54"W, 96.43 FEET; THENCE N17°16'18"W, 140.17 FEET;

THENCE N33°53'06"W, 83.89 FEET; THENCE N60°55'56"W, 71.15 FEET; THENCE S87°47'59"W, 133.75 FEET; THENCE S49°40'29"W, 139.62 FEET; THENCE S39°10'24"W, 76.36 FEET; THENCE S69°58'38"W, 84.97 FEET; THENCE N83°22'43"W, 139.43 FEET; THENCE N89°37'53"W, 137.62 FEET; THENCE S81°00'37"W, 294.88 FEET; THENCE S69°32'37"W, 157.90 FEET; THENCE N71°51'34"W, 90.25 FEET; THENCE N49°44'55"W, 103.23 FEET; THENCE N61°41'15"W, 18.94 FEET; THENCE N15°42'27"W, 120.81 FEET; THENCE N13°34'44"W, 112.11 FEET; THENCE N00°22'32"E, 118.49 FEET; THENCE N00°23'18"E, 122.08 FEET; THENCE N15°27'27"E, 132.06 FEET; THENCE N19°58'42"E, 168.83 FEET; THENCE N09°36'27"E, 550.16 FEET; THENCE N68°35'35"E, 18.77 FEET; THENCE N02°42'14"E, 100.48 FEET; THENCE N05°54'40"W, 60.24 FEET; THENCE N09°16'50"W, 105.66 FEET; THENCE N49°35'48"E, 181.51 FEET; THENCE N32°51'34"E, 112.30 FEET; THENCE N20°15'45"E, 279.57 FEET; THENCE N40°06'22"E, 307.67 FEET; THENCE N24°42'59"E, 141.30 FEET; THENCE N20°52'10"E, 2.89 FEET; THENCE N64°29'59"E, 24.57 FEET; THENCE N47°40'49"E, 34.60 FEET; THENCE N52°51'55"E, 96.34 FEET; THENCE N67°40'53"E, 102.23 FEET; THENCE N65°41'57"E, 64.13 FEET; THENCE N56°15'06"E, 72.93 FEET; THENCE N17°14'25"W, 49.29 FEET; THENCE N12°47'36"W, 84.01 FEET; THENCE N34°24'40"E, 18.30 FEET; THENCE N87°45'17"E, 46.55 FEET; THENCE N87°45'00"E, 52.55 FEET; THENCE N31°16'21"E, 51.69 FEET; THENCE N49°38'42"W, 29.51 FEET; THENCE N04°12'53"E, 36.88 FEET; THENCE N05°18'57"W, 53.88 FEET; THENCE N11°34'34"W, 78.41 FEET; THENCE N06°00'53"E, 40.61 FEET; THENCE N07°03'53"W, 79.10 FEET; THENCE N05°19'09"E, 55.98 FEET; THENCE N06°08'53"E, 87.94 FEET; THENCE N09°47'01"W, 72.48 FEET; THENCE N03°34'57"E, 51.84 FEET; THENCE N07°07'48"E, 49.50 FEET TO THE POINT OF BEGINNING.

AND

THAT LAND LYING IN SECTIONS 13 AND 24, TOWNSHIP 19 SOUTH, RANGE 23 EAST, SUMTER COUNTY, FLORIDA, DESCRIBED AS FOLLOWS:

FROM THE NORTHWEST CORNER OF THE NORTHEAST 1/4 OF SAID SECTION 13 RUN S00°32'59"W, ALONG THE WEST LINE THEREOF A DISTANCE OF 2,097.04 FEET; THENCE DEPARTING SAID WEST LINE, S89°27'01"E, 740.19 FEET TO THE POINT OF BEGINNING; THENCE N81°16'37"E, 437.00 FEET; THENCE S20°52'00"E, 285.75 FEET; THENCE S61°19'33"E, 16.72 FEET; THENCE S85°52'26"E, 67.80 FEET; THENCE S89°52'06"E, 67.79 FEET; THENCE N85°55'31"E, 67.79 FEET; THENCE N81°43'08"E, 67.79 FEET; THENCE N77°30'46"E, 67.79 FEET; THENCE N73°05'44"E, 74.58 FEET; THENCE N68°40'42"E, 67.79 FEET; THENCE N66°02'53"E, 124.73 FEET; THENCE N86°10'37"E, 62.08 FEET; THENCE S71°09'15"E, 143.36 FEET; THENCE S23°37'43"E, 433.58 FEET; THENCE S74°54'59"W, 482.83 FEET; THENCE S70°51'40"W, 97.67 FEET; THENCE S61°04'46"W, 116.04 FEET; THENCE S48°46'53"W, 116.92 FEET; THENCE S34°52'02"W, 117.08 FEET; THENCE S17°41'52"W, 88.22 FEET; THENCE S10°50'19"W, 135.92 FEET; THENCE S08°07'37"W, 143.87 FEET; THENCE S07°49'21"W, 108.77 FEET; THENCE S02°07'34"W, 83.01 FEET; THENCE S03°20'47"E, 70.01 FEET; THENCE S04°28'36"E, 69.36 FEET; THENCE S08°42'45"E, 66.72 FEET; THENCE S14°55'53"E, 66.72 FEET; THENCE S19°24'30"E, 69.18 FEET; THENCE S25°55'06"E, 62.23 FEET; THENCE S41°58'56"E, 63.40 FEET; THENCE S47°43'15"E, 106.18 FEET; THENCE S26°39'58"E, 64.83 FEET; THENCE

S02°42'16"E, 70.21 FEET; THENCE S33°44'46"W, 104.79 FEET; THENCE S25°09'08"W, 70.02 FEET; THENCE S22°41'20"W, 70.02 FEET; THENCE S16°28'55"W, 62.19 FEET; THENCE S13°35'03"W, 70.20 FEET; THENCE S04°57'10"W, 137.18 FEET; THENCE S03°29'25"W, 75.05 FEET; THENCE S20°37'12"W, 92.16 FEET; THENCE S21°29'51"W, 124.32 FEET; THENCE S55°27'31"W, 140.75 FEET; THENCE S50°27'01"W, 64.17 FEET; THENCE S38°06'33"W, 75.60 FEET; THENCE S25°30'44"W, 65.53 FEET; THENCE S11°06'48"W, 67.07 FEET; THENCE S05°41'37"W, 71.90 FEET; THENCE S00°42'21"W, 1,765.51 FEET; THENCE N80°37'37"W, 831.28 FEET; THENCE N35°44'42"W, 76.51 FEET; THENCE N24°29'04"W, 67.35 FEET; THENCE N17°40'47"W, 66.54 FEET; THENCE N39°22'09"W, 19.60 FEET; THENCE CONTINUE N39°22'09"W, 75.11 FEET; THENCE CONTINUE N39°22'09"W, 38.01 FEET; THENCE N02°45'10"E, 109.50 FEET; THENCE N12°41'56"W, 72.33 FEET; THENCE N15°16'09"W, 63.19 FEET; THENCE N28°20'55"W, 114.08 FEET; THENCE N83°27'04"W, 178.31 FEET; THENCE N78°09'34"W, 104.59 FEET; THENCE N43°40'11"W, 228.98 FEET; THENCE N67°25'31"W, 137.70 FEET; THENCE N76°41'25"W, 417.56 FEET; THENCE N80°14'30"W, 122.74 FEET; THENCE N82°46'20"W, 187.93 FEET; THENCE N57°22'44"W, 86.44 FEET; THENCE N00°16'27"W, 153.69 FEET; THENCE N26°51'17"E, 126.07 FEET; THENCE N23°09'10"W, 130.55 FEET; THENCE N19°17'13"E, 135.60 FEET; THENCE N68°36'58"E, 152.08 FEET; THENCE N59°32'32"W, 110.34 FEET; THENCE N56°56'43"W, 297.16 FEET TO THE POINT OF CURVATURE OF A CURVE CONCAVE NORTHEASTERLY AND HAVING A RADIUS OF 530.00 FEET; THENCE NORTHWESTERLY ALONG THE ARC THEREOF THROUGH A CENTRAL ANGLE OF 09°29'59", A DISTANCE OF 87.87 FEET TO THE POINT OF REVERSE CURVATURE OF A CURVE CONCAVE SOUTHERLY AND HAVING A RADIUS OF 25.00 FEET; THENCE WESTERLY ALONG THE ARC OF SAID CURVE THROUGH A CENTRAL ANGLE OF 86°42'55", A DISTANCE OF 37.84 FEET TO A POINT ON THE ARC OF A CURVE CONCAVE NORTHWESTERLY, HAVING A RADIUS OF 1,625.00 FEET AND A CHORD BEARING AND DISTANCE OF N34°21'07"E, 647.25 FEET; THENCE NORTHEASTERLY ALONG THE ARC OF SAID CURVE, THROUGH A CENTRAL ANGLE OF 22°58'29", A DISTANCE OF 651.60 FEET TO THE POINT OF COMPOUND CURVATURE OF A CURVE CONCAVE WESTERLY AND HAVING A RADIUS OF 1,630.00 FEET; THENCE NORTHERLY ALONG THE ARC OF SAID CURVE THROUGH A CENTRAL ANGLE OF 18°16'37", A DISTANCE OF 519.96 FEET; THENCE N04°35'16"E, 736.85 FEET TO THE POINT OF CURVATURE OF A CURVE CONCAVE EASTERLY AND HAVING A RADIUS OF 940.00 FEET; THENCE NORTHERLY ALONG THE ARC THEREOF THROUGH A CENTRAL ANGLE OF 07°27'36", A DISTANCE OF 122.39 FEET TO THE POINT OF COMPOUND CURVATURE OF A CURVE CONCAVE SOUTHEASTERLY AND HAVING A RADIUS OF 75.00 FEET; THENCE NORTHEASTERLY ALONG THE ARC OF SAID CURVE THROUGH A CENTRAL ANGLE OF 50°40'58", A DISTANCE OF 66.34 FEET TO THE POINT OF REVERSE CURVATURE OF A CURVE CONCAVE WESTERLY AND HAVING A RADIUS OF 120.00 FEET; THENCE NORTHERLY ALONG THE ARC OF SAID CURVE THROUGH A CENTRAL ANGLE OF 84°00'42", A DISTANCE OF 175.95 FEET TO THE POINT OF REVERSE CURVATURE OF A CURVE CONCAVE EASTERLY AND HAVING A RADIUS OF 75.00 FEET; THENCE NORTHERLY ALONG THE ARC OF SAID CURVE THROUGH A CENTRAL ANGLE OF 50°40'58", A DISTANCE OF 66.34 FEET TO THE POINT OF COMPOUND CURVATURE OF A CURVE CONCAVE SOUTHEASTERLY AND HAVING

A RADIUS OF 940.00 FEET; THENCE NORTHEASTERLY ALONG THE ARC OF SAID CURVE THROUGH A CENTRAL ANGLE OF 09°00'35", A DISTANCE OF 147.81 FEET TO THE POINT OF REVERSE CURVATURE OF A CURVE CONCAVE NORTHWESTERLY AND HAVING A RADIUS OF 1,085.00 FEET; THENCE NORTHEASTERLY ALONG THE ARC OF SAID CURVE THROUGH A CENTRAL ANGLE OF 20°21'16", A DISTANCE OF 385.45 FEET; THENCE S71°56'37"E, 15.00 FEET; THENCE S41°02'51"E, 458.75 FEET; THENCE N60°15'21"E, 303.13 FEET; THENCE S88°21'24"E, 222.14 FEET; THENCE S86°20'12"E, 164.25 FEET; THENCE N41°21'17"E, 725.35 FEET TO THE POINT OF BEGINNING.

AND

THAT LAND LYING IN SECTIONS 10, 11, 12 AND 14, TOWNSHIP 19 SOUTH, RANGE 23 EAST, SUMTER COUNTY, FLORIDA, DESCRIBED AS FOLLOWS:

FROM THE SOUTHEAST CORNER OF THE SOUTHWEST 1/4 OF SAID SECTION 11 RUN N89°28'48"W, ALONG THE SOUTH LINE THEREOF A DISTANCE OF 10.93 FEET; THENCE DEPARTING SAID SOUTH LINE, S32°17'27"W, 116.55 FEET; THENCE S61°37'20"W, 104.64 FEET; THENCE S41°37'31"W, 107.27 FEET; THENCE S29°24'50"W, 94.68 FEET; THENCE S30°23'59"W, 103.12 FEET; THENCE S52°06'08"W, 119.45 FEET; THENCE S31°38'26"W, 100.45 FEET; THENCE S39°34'35"W, 81.46 FEET; THENCE S80°00'57"W, 96.58 FEET; THENCE S63°26'44"W, 138.44 FEET; THENCE S17°03'25"E, 165.77 FEET; THENCE S67°51'59"W, 52.25 FEET; THENCE S76°56'30"W, 134.37 FEET; THENCE S32°09'31"W, 65.13 FEET; THENCE S62°28'51"W, 89.38 FEET; THENCE S64°06'09"W, 110.44 FEET; THENCE S52°10'41"W, 86.59 FEET; THENCE S87°56'17"W, 136.03 FEET; THENCE N05°41'29"W, 27.14 FEET; THENCE S84°18'31"W, 143.63 FEET; THENCE S70°37'00"W, 82.80 FEET; THENCE S67°19'37"W, 52.71 FEET; THENCE S83°21'57"W, 106.88 FEET; THENCE S83°05'59"W, 83.34 FEET; THENCE S25°34'32"E, 26.67 FEET; THENCE S44°01'49"W, 78.37 FEET; THENCE S73°57'37"W, 83.60 FEET; THENCE S57°50'33"W, 34.77 FEET; THENCE N13°31'54"W, 49.10 FEET; THENCE N81°01'34"W, 30.55 FEET; THENCE S08°50'13"W, 46.27 FEET; THENCE N69°25'25"W, 62.40 FEET; THENCE S86°31'14"W, 86.78 FEET; THENCE N84°55'40"W, 104.52 FEET; THENCE S63°33'16"W, 36.33 FEET; THENCE N82°06'14"W, 136.34 FEET; THENCE N58°10'42"W, 50.77 FEET; THENCE N85°15'30"W, 72.49 FEET; THENCE S83°14'08"W, 71.39 FEET; THENCE N79°08'12"W, 100.36 FEET TO A POINT ON THE WEST LINE OF THE NORTHWEST 1/4 OF SAID SECTION 14; THENCE N00°35'41"E, 1,236.31 FEET TO THE SOUTHEAST CORNER OF THE SOUTHEAST 1/4 OF SAID SECTION 10; THENCE DEPARTING SAID WEST LINE, N89°28'25"W, ALONG THE SOUTH LINE THEREOF A DISTANCE OF 395.35 FEET; THENCE DEPARTING SAID SOUTH LINE, N00°00'00"E, 332.08 FEET; THENCE N24°20'31"E, 90.62 FEET; THENCE N46°47'32"E, 65.26 FEET; THENCE N57°47'48"E, 89.46 FEET; THENCE N20°09'34"W, 84.16 FEET; THENCE N12°53'17"W, 210.76 FEET; THENCE N63°23'06"W, 77.59 FEET; THENCE N60°36'00"W, 101.19 FEET; THENCE N31°28'01"W, 83.30 FEET; THENCE S44°44'19"W, 47.66 FEET; THENCE S63°40'58"W, 116.19 FEET; THENCE S75°06'22"W, 64.60 FEET; THENCE S64°43'36"W, 63.56 FEET; THENCE S60°31'30"W, 70.00 FEET; THENCE S65°12'13"W, 122.60 FEET; THENCE S85°27'02"W, 568.83 FEET; THENCE N44°16'28"W, 151.80 FEET;

THENCE N13°37'54"W, 130.70 FEET; THENCE N13°45'30"W, 73.29 FEET; THENCE
 N18°06'38"W, 72.87 FEET; THENCE N40°11'04"W, 151.52 FEET; THENCE N01°47'04"W,
 139.11 FEET; THENCE N57°33'25"W, 161.80 FEET; THENCE N26°21'53"W, 626.45 FEET;
 THENCE S65°42'28"W, 128.17 FEET TO THE POINT OF CURVATURE OF A CURVE
 CONCAVE NORTHERLY AND HAVING A RADIUS OF 1,280.00 FEET; THENCE
 WESTERLY ALONG THE ARC THEREOF THROUGH A CENTRAL ANGLE OF 15°30'23",
 A DISTANCE OF 346.42 FEET; THENCE N08°47'09"W, 60.00 FEET; THENCE
 N02°29'11"E, 556.42 FEET; THENCE N14°07'01"E, 677.54 FEET; THENCE S46°32'24"E,
 99.36 FEET; THENCE S72°59'44"E, 128.64 FEET; THENCE N64°45'07"E, 126.92 FEET;
 THENCE N50°35'09"E, 129.41 FEET; THENCE N21°26'58"E, 73.87 FEET; THENCE
 N19°36'47"E, 72.09 FEET; THENCE N25°22'53"E, 69.13 FEET; THENCE N79°16'57"E, 65.44
 FEET; THENCE N67°26'10"E, 111.62 FEET; THENCE N59°46'03"E, 97.73 FEET; THENCE
 N35°29'56"E, 97.31 FEET; THENCE N70°14'13"E, 79.44 FEET; THENCE S52°10'46"E,
 108.97 FEET; THENCE S59°47'45"E, 103.83 FEET; THENCE CONTINUE S59°47'45"E,
 57.89 FEET; THENCE S47°22'10"E, 117.34 FEET; THENCE S10°01'34"E, 184.87 FEET;
 THENCE S30°52'25"E, 102.47 FEET; THENCE S46°46'31"E, 177.93 FEET; THENCE
 S77°43'02"E, 177.45 FEET; THENCE S71°25'51"E, 112.77 FEET; THENCE S60°52'47"E,
 84.25 FEET; THENCE S82°58'08"E, 92.71 FEET; THENCE S32°47'36"W, 439.51 FEET;
 THENCE S31°55'32"W, 60.02 FEET; THENCE S21°06'14"W, 59.97 FEET; THENCE
 S18°40'59"W, 59.20 FEET; THENCE S12°36'30"W, 59.94 FEET; THENCE S12°17'59"W,
 88.76 FEET TO A POINT ON THE ARC OF A CURVE CONCAVE SOUTHWESTERLY,
 HAVING A RADIUS OF 2,841.98 FEET AND A CHORD BEARING AND DISTANCE OF
 S66°49'04"E, 846.36 FEET; THENCE SOUTHEASTERLY ALONG THE ARC OF SAID
 CURVE, THROUGH A CENTRAL ANGLE OF 17°07'36", A DISTANCE OF 849.52 FEET
 TO THE POINT OF COMPOUND CURVATURE OF A CURVE CONCAVE
 SOUTHWESTERLY AND HAVING A RADIUS OF 1,130.00 FEET; THENCE
 SOUTHEASTERLY ALONG THE ARC OF SAID CURVE THROUGH A CENTRAL
 ANGLE OF 10°32'43", A DISTANCE OF 207.98 FEET; THENCE S47°42'33"E, 388.21 FEET
 TO THE POINT OF CURVATURE OF A CURVE CONCAVE NORTHERLY AND HAVING
 A RADIUS OF 20.00 FEET; THENCE EASTERLY ALONG THE ARC THEREOF
 THROUGH A CENTRAL ANGLE OF 92°11'55", A DISTANCE OF 32.18 FEET; THENCE
 N40°05'32"E, 402.38 FEET TO THE POINT OF CURVATURE OF A CURVE CONCAVE
 NORTHWESTERLY AND HAVING A RADIUS OF 1,370.00 FEET; THENCE
 NORTHEASTERLY ALONG THE ARC THEREOF THROUGH A CENTRAL ANGLE OF
 14°41'57", A DISTANCE OF 351.47 FEET; THENCE S64°36'25"E, 60.00 FEET; THENCE
 S38°15'14"E, 118.83 FEET; THENCE S34°10'54"E, 86.47 FEET; THENCE S59°48'05"E, 82.33
 FEET; THENCE S63°07'40"E, 74.93 FEET; THENCE S80°19'26"E, 72.26 FEET; THENCE
 N84°59'18"E, 67.88 FEET; THENCE N81°46'16"E, 68.54 FEET; THENCE N76°45'39"E, 68.22
 FEET; THENCE N71°14'49"E, 80.88 FEET; THENCE N65°18'02"E, 79.91 FEET; THENCE
 N59°49'21"E, 68.22 FEET; THENCE N56°17'10"E, 69.60 FEET; THENCE N56°33'35"E, 71.58
 FEET; THENCE N57°46'45"E, 140.77 FEET; THENCE N57°49'28"E, 70.00 FEET; THENCE
 N53°08'44"E, 66.52 FEET; THENCE N44°32'16"E, 79.50 FEET; THENCE N43°47'00"E, 70.00
 FEET; THENCE N36°13'29"E, 287.37 FEET; THENCE S46°43'20"E, 472.38 FEET; THENCE
 S60°52'42"E, 769.61 FEET; THENCE S25°38'42"E, 86.09 FEET; THENCE S07°08'26"E, 60.00
 FEET TO A POINT ON THE ARC OF A CURVE CONCAVE SOUTHERLY, HAVING A
 RADIUS OF 1,370.00 FEET AND A CHORD BEARING AND DISTANCE OF S88°08'01"E,

428.96 FEET; THENCE EASTERLY ALONG THE ARC OF SAID CURVE, THROUGH A
 CENTRAL ANGLE OF 18°00'50", A DISTANCE OF 430.73 FEET; THENCE S79°07'36"E,
 221.27 FEET TO THE POINT OF CURVATURE OF A CURVE CONCAVE NORTHERLY
 AND HAVING A RADIUS OF 1,230.00 FEET; THENCE EASTERLY ALONG THE ARC
 THEREOF THROUGH A CENTRAL ANGLE OF 24°26'45", A DISTANCE OF 524.79 FEET;
 THENCE N76°25'39"E, 386.10 FEET TO THE POINT OF CURVATURE OF A CURVE
 CONCAVE SOUTHERLY AND HAVING A RADIUS OF 1,470.00 FEET; THENCE
 EASTERLY ALONG THE ARC THEREOF THROUGH A CENTRAL ANGLE OF 28°33'23",
 A DISTANCE OF 732.65 FEET; THENCE S75°00'58"E, 336.64 FEET TO THE POINT OF
 CURVATURE OF A CURVE CONCAVE NORTHERLY AND HAVING A RADIUS OF
 1,230.00 FEET; THENCE EASTERLY ALONG THE ARC THEREOF THROUGH A
 CENTRAL ANGLE OF 14°25'28", A DISTANCE OF 309.66 FEET; THENCE S89°26'26"E,
 716.10 FEET TO THE POINT OF CURVATURE OF A CURVE CONCAVE SOUTHERLY
 AND HAVING A RADIUS OF 35.00 FEET; THENCE EASTERLY ALONG THE ARC
 THEREOF THROUGH A CENTRAL ANGLE OF 30°47'39", A DISTANCE OF 18.81 FEET
 TO THE POINT OF REVERSE CURVATURE OF A CURVE CONCAVE NORTHERLY
 AND HAVING A RADIUS OF 52.00 FEET; THENCE EASTERLY ALONG THE ARC OF
 SAID CURVE THROUGH A CENTRAL ANGLE OF 63°35'32", A DISTANCE OF 57.71
 FEET TO THE POINT OF REVERSE CURVATURE OF A CURVE CONCAVE
 SOUTHERLY AND HAVING A RADIUS OF 18.00 FEET; THENCE EASTERLY ALONG
 THE ARC OF SAID CURVE THROUGH A CENTRAL ANGLE OF 36°49'33", A DISTANCE
 OF 11.57 FEET TO THE POINT OF COMPOUND CURVATURE OF A CURVE CONCAVE
 SOUTHERLY AND HAVING A RADIUS OF 871.00 FEET; THENCE EASTERLY ALONG
 THE ARC OF SAID CURVE THROUGH A CENTRAL ANGLE OF 04°12'21", A DISTANCE
 OF 63.94 FEET TO THE POINT OF COMPOUND CURVATURE OF A CURVE CONCAVE
 SOUTHWESTERLY AND HAVING A RADIUS OF 50.00 FEET; THENCE
 SOUTHEASTERLY ALONG THE ARC OF SAID CURVE THROUGH A CENTRAL
 ANGLE OF 67°37'38", A DISTANCE OF 59.02 FEET TO THE POINT OF REVERSE
 CURVATURE OF A CURVE CONCAVE NORTHEASTERLY AND HAVING A RADIUS
 OF 131.00 FEET; THENCE SOUTHEASTERLY ALONG THE ARC OF SAID CURVE
 THROUGH A CENTRAL ANGLE OF 19°37'45", A DISTANCE OF 44.88 FEET TO THE
 POINT OF REVERSE CURVATURE OF A CURVE CONCAVE WESTERLY AND HAVING
 A RADIUS OF 50.00 FEET; THENCE SOUTHERLY ALONG THE ARC OF SAID CURVE
 THROUGH A CENTRAL ANGLE OF 48°40'28", A DISTANCE OF 42.48 FEET TO THE
 POINT OF REVERSE CURVATURE OF A CURVE CONCAVE EASTERLY AND HAVING
 A RADIUS OF 1,035.00 FEET; THENCE SOUTHERLY ALONG THE ARC OF SAID
 CURVE THROUGH A CENTRAL ANGLE OF 22°24'52", A DISTANCE OF 404.90 FEET;
 THENCE S06°56'54"E, 544.34 FEET TO THE POINT OF CURVATURE OF A CURVE
 CONCAVE WESTERLY AND HAVING A RADIUS OF 1,545.00 FEET; THENCE
 SOUTHERLY ALONG THE ARC THEREOF THROUGH A CENTRAL ANGLE OF
 02°32'48", A DISTANCE OF 68.67 FEET; THENCE S85°35'54"W, 45.00 FEET; THENCE
 S62°59'18"W, 210.10 FEET; THENCE N43°01'18"W, 26.26 FEET; THENCE N54°26'40"W,
 94.23 FEET; THENCE N71°55'54"W, 113.90 FEET; THENCE N89°22'47"W, 181.25 FEET;
 THENCE S75°34'22"W, 98.19 FEET; THENCE S66°48'33"W, 87.02 FEET; THENCE
 S71°51'00"W, 129.97 FEET; THENCE S75°57'38"W, 84.27 FEET; THENCE N58°04'30"W,
 55.62 FEET; THENCE N26°03'08"W, 115.30 FEET; THENCE N28°51'03"W, 101.64 FEET;

THENCE N22°19'40"W, 135.13 FEET; THENCE N15°23'06"W, 105.30 FEET; THENCE N04°37'51"E, 95.65 FEET; THENCE N10°41'39"E, 101.23 FEET; THENCE N01°18'04"W, 106.34 FEET; THENCE N19°31'55"W, 73.55 FEET; THENCE N53°47'42"W, 114.31 FEET; THENCE N38°16'11"W, 146.38 FEET; THENCE N35°00'12"W, 127.09 FEET; THENCE CONTINUE N35°00'12"W, 19.54 FEET; THENCE N28°07'20"W, 137.15 FEET; THENCE S85°57'24"W, 123.88 FEET; THENCE S41°41'46"W, 158.79 FEET; THENCE S25°15'07"W, 207.00 FEET; THENCE S26°12'55"W, 196.87 FEET; THENCE S49°44'33"W, 91.60 FEET; THENCE S24°01'00"W, 73.59 FEET; THENCE S13°19'26"E, 101.97 FEET; THENCE S28°07'34"W, 132.79 FEET; THENCE S45°42'19"W, 104.12 FEET; THENCE S28°52'51"W, 143.80 FEET; THENCE S57°50'32"W, 96.48 FEET; THENCE S58°41'03"W, 119.98 FEET; THENCE S43°02'33"W, 72.37 FEET; THENCE S14°17'01"W, 114.17 FEET; THENCE S43°58'36"W, 142.14 FEET; THENCE N31°18'51"W, 135.62 FEET; THENCE S60°47'43"W, 62.97 FEET; THENCE S19°56'12"W, 43.96 FEET; THENCE N61°55'46"W, 90.16 FEET; THENCE N86°19'47"W, 134.45 FEET; THENCE N73°05'49"W, 124.07 FEET; THENCE S26°31'48"W, 61.61 FEET; THENCE N67°43'12"W, 189.98 FEET; THENCE N33°19'43"E, 41.71 FEET; THENCE N54°39'22"W, 122.20 FEET; THENCE N71°26'05"W, 87.42 FEET; THENCE N22°20'55"W, 167.33 FEET; THENCE N17°49'36"W, 108.91 FEET; THENCE N26°40'14"W, 67.43 FEET; THENCE N17°42'24"W, 65.61 FEET; THENCE N55°44'24"W, 50.35 FEET; THENCE N89°39'25"W, 53.80 FEET; THENCE N33°44'13"W, 54.07 FEET; THENCE N20°22'55"W, 59.85 FEET; THENCE N86°58'36"W, 68.05 FEET; THENCE S55°07'51"W, 65.94 FEET; THENCE S20°12'04"W, 38.55 FEET; THENCE S71°02'46"W, 47.87 FEET; THENCE S74°33'52"W, 106.24 FEET; THENCE S42°26'42"W, 147.12 FEET; THENCE S64°28'56"W, 87.32 FEET; THENCE S29°11'29"W, 75.29 FEET; THENCE S84°43'52"E, 27.35 FEET; THENCE S18°39'12"E, 44.74 FEET; THENCE S71°14'00"E, 86.31 FEET; THENCE S58°53'10"E, 86.85 FEET; THENCE S35°44'44"E, 92.21 FEET; THENCE S20°13'34"E, 85.15 FEET; THENCE S04°45'14"W, 74.29 FEET; THENCE S50°09'56"W, 125.19 FEET; THENCE S68°41'32"W, 143.39 FEET; THENCE S59°16'59"W, 144.16 FEET TO A POINT ON THE SOUTH LINE OF THE SOUTHEAST 1/4 OF SAID SECTION 11; THENCE N89°12'27"W, ALONG SAID SOUTH LINE A DISTANCE OF 130.14 FEET TO THE POINT OF BEGINNING.

AND

THAT LAND LYING IN SECTIONS 12 AND 13, TOWNSHIP 19 SOUTH, RANGE 23 EAST, SUMTER COUNTY, FLORIDA, DESCRIBED AS FOLLOWS:

FROM THE SOUTHWEST CORNER OF THE SOUTHEAST 1/4 OF SAID SECTION 12 RUN N00°35'56"E, ALONG THE WEST LINE THEREOF A DISTANCE OF 476.94 FEET; THENCE DEPARTING SAID WEST LINE, S89°24'04"E, 589.10 FEET TO THE POINT OF BEGINNING; THENCE S58°49'35"W, 292.97 FEET; THENCE S58°48'19"W, 72.14 FEET; THENCE S43°21'10"W, 63.97 FEET; THENCE S17°46'02"W, 62.84 FEET; THENCE S04°21'25"E, 69.62 FEET; THENCE S05°39'12"E, 223.76 FEET; THENCE S34°32'53"W, 127.82 FEET; THENCE S82°40'40"W, 468.80 FEET; THENCE S84°58'32"W, 363.54 FEET; THENCE N51°44'32"W, 165.27 FEET; THENCE N73°02'31"W, 15.00 FEET TO A POINT ON THE ARC OF A CURVE CONCAVE WESTERLY, HAVING A RADIUS OF 1,665.00 FEET AND A CHORD BEARING AND DISTANCE OF N05°00'17"E, 689.69 FEET; THENCE

NORTHERLY ALONG THE ARC OF SAID CURVE, THROUGH A CENTRAL ANGLE OF
 23°54'23", A DISTANCE OF 694.71 FEET; THENCE N06°56'54"W, 544.34 FEET TO THE
 POINT OF CURVATURE OF A CURVE CONCAVE EASTERLY AND HAVING A RADIUS
 OF 915.00 FEET; THENCE NORTHERLY ALONG THE ARC THEREOF THROUGH A
 CENTRAL ANGLE OF 21°27'04", A DISTANCE OF 342.57 FEET TO THE POINT OF
 COMPOUND CURVATURE OF A CURVE CONCAVE SOUTHEASTERLY AND HAVING
 A RADIUS OF 50.00 FEET; THENCE NORTHEASTERLY ALONG THE ARC OF SAID
 CURVE THROUGH A CENTRAL ANGLE OF 57°11'49", A DISTANCE OF 49.91 FEET TO
 THE POINT OF REVERSE CURVATURE OF A CURVE CONCAVE NORTHWESTERLY
 AND HAVING A RADIUS OF 131.00 FEET; THENCE NORTHEASTERLY ALONG THE
 ARC OF SAID CURVE THROUGH A CENTRAL ANGLE OF 99°55'42", A DISTANCE OF
 228.47 FEET TO THE POINT OF REVERSE CURVATURE OF A CURVE CONCAVE
 EASTERLY AND HAVING A RADIUS OF 50.00 FEET; THENCE NORTHERLY ALONG
 THE ARC OF SAID CURVE THROUGH A CENTRAL ANGLE OF 52°37'25", A DISTANCE
 OF 45.92 FEET; THENCE N24°23'42"E, 125.50 FEET TO THE POINT OF CURVATURE OF
 A CURVE CONCAVE SOUTHEASTERLY AND HAVING A RADIUS OF 1,515.00 FEET;
 THENCE NORTHEASTERLY ALONG THE ARC THEREOF THROUGH A CENTRAL
 ANGLE OF 21°44'11", A DISTANCE OF 574.75 FEET; THENCE N46°07'53"E, 902.91 FEET
 TO THE POINT OF CURVATURE OF A CURVE CONCAVE NORTHWESTERLY AND
 HAVING A RADIUS OF 1,665.00 FEET; THENCE NORTHEASTERLY ALONG THE ARC
 THEREOF THROUGH A CENTRAL ANGLE OF 25°26'35", A DISTANCE OF 739.37 FEET;
 THENCE S69°18'42"E, 15.00 FEET; THENCE S60°23'00"E, 85.92 FEET; THENCE
 CONTINUE S60°23'00"E, 85.92 FEET; THENCE S81°16'42"E, 70.64 FEET; THENCE
 N83°48'51"E, 114.45 FEET; THENCE N53°47'01"E, 130.77 FEET; THENCE N37°55'06"E,
 72.19 FEET; THENCE N40°18'09"E, 46.52 FEET; THENCE N46°18'17"E, 96.08 FEET;
 THENCE S85°17'01"E, 90.89 FEET; THENCE S71°44'55"E, 142.63 FEET; THENCE
 S82°46'08"E, 210.00 FEET; THENCE S84°18'10"E, 216.64 FEET; THENCE S39°52'52"E,
 128.12 FEET; THENCE S01°46'31"E, 106.49 FEET; THENCE S51°00'49"E, 381.84 FEET;
 THENCE S11°39'20"W, 160.10 FEET; THENCE CONTINUE S11°39'20"W, 160.10 FEET;
 THENCE S10°36'27"W, 138.30 FEET; THENCE S09°14'51"W, 286.71 FEET; THENCE
 S07°37'20"W, 261.56 FEET; THENCE S40°58'48"W, 174.73 FEET; THENCE S10°05'29"E,
 193.56 FEET; THENCE S00°02'41"W, 77.54 FEET; THENCE S12°33'56"W, 66.94 FEET;
 THENCE S06°50'45"W, 67.13 FEET; THENCE S10°03'33"E, 158.96 FEET; THENCE
 S01°31'30"E, 92.18 FEET; THENCE S17°45'02"W, 92.10 FEET; THENCE S20°41'45"W,
 71.44 FEET; THENCE S10°09'14"W, 71.20 FEET; THENCE S00°29'31"E, 223.89 FEET;
 THENCE CONTINUE S00°29'31"E, 46.64 FEET; THENCE S38°43'19"W, 408.37 FEET;
 THENCE S90°00'00"W, 438.23 FEET; THENCE N88°01'26"W, 175.75 FEET; THENCE
 N21°46'38"W, 303.10 FEET; THENCE S71°45'01"W, 25.47 FEET; THENCE N85°07'48"W,
 234.76 FEET; THENCE S87°52'41"W, 61.85 FEET; THENCE S62°03'22"W, 70.42 FEET;
 THENCE S50°32'20"W, 71.28 FEET; THENCE S30°36'15"W, 70.66 FEET; THENCE
 S06°00'09"W, 55.83 FEET; THENCE S16°20'16"W, 96.49 FEET TO THE POINT OF
 BEGINNING.

AND

THAT LAND LYING IN SECTIONS 9, 10 AND 16, TOWNSHIP 19 SOUTH, RANGE 23 EAST, SUMTER COUNTY, FLORIDA, DESCRIBED AS FOLLOWS:

BEGIN AT THE SOUTHWEST CORNER OF THE SOUTHWEST 1/4 OF SAID SECTION 10, THENCE S89°25'15"E, ALONG THE SOUTH LINE THEREOF A DISTANCE OF 2,650.54 FEET TO THE SOUTHWEST CORNER OF THE SOUTHEAST 1/4 OF SAID SECTION 10; THENCE DEPARTING SAID SOUTH LINE, S89°28'25"E, ALONG THE SOUTH LINE THEREOF A DISTANCE OF 258.56 FEET; THENCE DEPARTING SAID SOUTH LINE, N27°46'37"E, 161.94 FEET; THENCE N27°45'33"W, 95.60 FEET; THENCE N23°37'26"E, 80.48 FEET; THENCE N36°58'02"W, 16.49 FEET; THENCE N80°56'14"W, 65.43 FEET; THENCE S80°45'01"W, 97.88 FEET; THENCE N73°54'23"W, 109.77 FEET; THENCE N17°15'31"W, 101.06 FEET; THENCE N06°38'15"E, 94.43 FEET; THENCE N08°14'16"E, 47.92 FEET; THENCE S88°46'58"W, 361.64 FEET; THENCE N19°31'21"W, 868.75 FEET; THENCE N42°14'01"E, 116.07 FEET; THENCE N19°43'47"E, 291.07 FEET TO A POINT ON THE ARC OF A CURVE CONCAVE SOUTHERLY, HAVING A RADIUS OF 1,220.00 FEET AND A CHORD BEARING AND DISTANCE OF S75°14'05"W, 202.36 FEET; THENCE WESTERLY ALONG THE ARC OF SAID CURVE, THROUGH A CENTRAL ANGLE OF 09°30'53", A DISTANCE OF 202.60 FEET; THENCE S70°28'39"W, 66.31 FEET; THENCE N19°31'21"W, 84.82 FEET; THENCE N03°08'54"W, 152.95 FEET; THENCE N23°06'11"W, 120.19 FEET; THENCE N41°56'49"W, 186.34 FEET; THENCE N08°09'53"W, 29.80 FEET; THENCE N12°11'03"W, 485.30 FEET; THENCE N20°01'16"W, 25.13 FEET; THENCE N23°15'13"W, 202.42 FEET; THENCE N22°11'04"W, 97.35 FEET; THENCE N22°28'26"W, 57.09 FEET; THENCE N59°08'23"W, 84.35 FEET TO A POINT ON THE ARC OF A CURVE CONCAVE NORTHWESTERLY, HAVING A RADIUS OF 1,460.00 FEET AND A CHORD BEARING AND DISTANCE OF S51°21'40"W, 1,022.65 FEET; THENCE SOUTHWESTERLY ALONG THE ARC OF SAID CURVE, THROUGH A CENTRAL ANGLE OF 41°00'07", A DISTANCE OF 1,044.80 FEET TO THE POINT OF REVERSE CURVATURE OF A CURVE CONCAVE SOUTHEASTERLY AND HAVING A RADIUS OF 1,450.00 FEET; THENCE SOUTHWESTERLY ALONG THE ARC OF SAID CURVE THROUGH A CENTRAL ANGLE OF 22°01'14", A DISTANCE OF 557.28 FEET; THENCE S49°50'30"W, 137.13 FEET TO THE POINT OF CURVATURE OF A CURVE CONCAVE SOUTHEASTERLY AND HAVING A RADIUS OF 94.00 FEET; THENCE SOUTHWESTERLY ALONG THE ARC THEREOF THROUGH A CENTRAL ANGLE OF 46°48'29", A DISTANCE OF 76.79 FEET TO THE POINT OF REVERSE CURVATURE OF A CURVE CONCAVE NORTHWESTERLY AND HAVING A RADIUS OF 131.00 FEET; THENCE SOUTHWESTERLY ALONG THE ARC OF SAID CURVE THROUGH A CENTRAL ANGLE OF 94°47'52", A DISTANCE OF 216.74 FEET TO THE POINT OF REVERSE CURVATURE OF A CURVE CONCAVE SOUTHERLY AND HAVING A RADIUS OF 49.00 FEET; THENCE WESTERLY ALONG THE ARC OF SAID CURVE THROUGH A CENTRAL ANGLE OF 57°21'35", A DISTANCE OF 49.05 FEET TO THE POINT OF REVERSE CURVATURE OF A CURVE CONCAVE NORTHWESTERLY AND HAVING A RADIUS OF 1,340.00 FEET; THENCE SOUTHWESTERLY ALONG THE ARC OF SAID CURVE THROUGH A CENTRAL ANGLE OF 49°55'13", A DISTANCE OF 1,167.51 FEET; THENCE N89°36'29"W, 73.50 FEET TO A POINT ON THE WEST LINE OF THE EAST 1/2 OF THE SOUTHEAST 1/4 OF SAID SECTION 9; THENCE S00°31'22"W,

ALONG SAID WEST LINE A DISTANCE OF 1,344.66 FEET TO THE NORTHWEST CORNER OF THE NORTHEAST 1/4 OF THE NORTHEAST 1/4 OF SAID SECTION 9; THENCE S00°35'25"W, ALONG THE WEST LINE THEREOF A DISTANCE OF 1,048.93 FEET TO A POINT ON THE NORTH RIGHT OF WAY LINE OF COUNTY ROAD NO. 44A, MAINTENANCE ONLY, RECORDED IN OFFICIAL RECORDS BOOK 4, PAGES 117 THROUGH 124, PUBLIC RECORDS OF SUMTER COUNTY, FLORIDA; (THE FOLLOWING 9 COURSES BEING ALONG SAID NORTH RIGHT OF WAY LINE OF COUNTY ROAD NO. 44A); THENCE S51°58'45"E, 100.32 FEET; THENCE S52°14'51"E, 162.73 FEET; THENCE S51°21'05"E, 50.58 FEET; THENCE S52°08'21"E, 384.83 FEET; THENCE S52°00'04"E, 343.31 FEET; THENCE S51°54'32"E, 111.53 FEET; THENCE S52°45'17"E, 54.84 FEET; THENCE S51°46'32"E, 69.00 FEET; THENCE S52°11'53"E, 173.23 FEET; THENCE DEPARTING SAID NORTH RIGHT OF WAY, N38°28'10"E, 86.56 FEET; THENCE S51°31'50"E, 133.00 FEET TO THE EAST LINE OF THE NORTHEAST 1/4 OF SAID SECTION 16; THENCE ALONG SAID EAST LINE, N00°37'40"E, 1,945.79 FEET TO THE POINT OF BEGINNING.

AND

THAT LAND LYING IN SECTIONS 9 AND 10, TOWNSHIP 19 SOUTH, RANGE 23 EAST, SUMTER COUNTY, FLORIDA, DESCRIBED AS FOLLOWS:

FROM THE NORTHEAST CORNER OF THE SOUTHEAST 1/4 OF SAID SECTION 9 RUN N89°37'04"W, ALONG THE NORTH LINE THEREOF A DISTANCE OF 1,279.72 FEET; THENCE DEPARTING SAID NORTH LINE, S00°22'56"W, 290.62 FEET TO THE POINT OF BEGINNING; THENCE N87°49'28"W, 222.23 FEET TO THE POINT OF CURVATURE OF A CURVE CONCAVE NORTHERLY AND HAVING A RADIUS OF 1,530.00 FEET; THENCE WESTERLY ALONG THE ARC THEREOF THROUGH A CENTRAL ANGLE OF 02°58'07", A DISTANCE OF 79.27 FEET; THENCE N05°08'39"E, 60.00 FEET; THENCE N13°05'05"W, 162.41 FEET; THENCE N28°28'27"E, 527.23 FEET; THENCE N24°33'42"E, 206.74 FEET; THENCE N18°39'19"E, 101.55 FEET; THENCE N03°05'42"E, 86.59 FEET; THENCE N76°27'37"E, 123.98 FEET; THENCE N80°53'48"E, 99.83 FEET; THENCE N56°34'24"E, 136.51 FEET; THENCE N57°11'52"E, 125.20 FEET; THENCE N38°28'49"E, 108.28 FEET; THENCE N38°53'10"E, 103.73 FEET; THENCE N65°16'34"E, 122.51 FEET; THENCE N72°41'10"E, 144.98 FEET; THENCE S81°19'19"E, 38.26 FEET; THENCE S64°54'10"E, 188.45 FEET; THENCE N66°32'22"E, 75.67 FEET; THENCE S56°33'42"E, 96.63 FEET; THENCE N76°59'45"E, 152.56 FEET; THENCE S57°52'09"E, 362.75 FEET; THENCE S59°30'10"E, 28.31 FEET; THENCE S81°00'28"E, 73.20 FEET; THENCE S53°56'25"E, 79.65 FEET; THENCE S88°12'03"E, 54.93 FEET; THENCE N50°32'03"E, 91.35 FEET; THENCE N24°36'35"E, 42.73 FEET; THENCE N45°41'30"E, 119.84 FEET; THENCE N45°23'24"E, 79.19 FEET; THENCE N33°06'15"E, 63.02 FEET; THENCE N43°54'08"E, 48.52 FEET; THENCE N62°05'50"E, 130.64 FEET; THENCE N47°46'14"E, 53.28 FEET; THENCE N76°03'38"E, 68.18 FEET; THENCE N71°46'06"E, 46.43 FEET; THENCE N58°11'16"E, 66.29 FEET; THENCE N39°31'07"E, 65.69 FEET; THENCE N56°22'43"E, 54.68 FEET; THENCE N59°23'27"E, 100.77 FEET; THENCE N76°15'21"E, 15.00 FEET; THENCE S13°44'39"E, 79.01 FEET TO THE POINT OF CURVATURE OF A CURVE CONCAVE WESTERLY AND HAVING A RADIUS OF 1,340.00 FEET; THENCE SOUTHERLY ALONG THE ARC

THEREOF THROUGH A CENTRAL ANGLE OF 10°40'23", A DISTANCE OF 249.62 FEET TO THE POINT OF COMPOUND CURVATURE OF A CURVE CONCAVE NORTHWESTERLY AND HAVING A RADIUS OF 49.00 FEET; THENCE SOUTHWESTERLY ALONG THE ARC OF SAID CURVE THROUGH A CENTRAL ANGLE OF 55°50'49", A DISTANCE OF 47.76 FEET TO THE POINT OF REVERSE CURVATURE OF A CURVE CONCAVE EASTERLY AND HAVING A RADIUS OF 131.00 FEET; THENCE SOUTHERLY ALONG THE ARC OF SAID CURVE THROUGH A CENTRAL ANGLE OF 93°05'26", A DISTANCE OF 212.84 FEET TO THE POINT OF REVERSE CURVATURE OF A CURVE CONCAVE WESTERLY AND HAVING A RADIUS OF 94.00 FEET; THENCE SOUTHERLY ALONG THE ARC OF SAID CURVE THROUGH A CENTRAL ANGLE OF 50°28'20", A DISTANCE OF 82.81 FEET TO THE POINT OF COMPOUND CURVATURE OF A CURVE CONCAVE NORTHWESTERLY AND HAVING A RADIUS OF 1,340.00 FEET; THENCE SOUTHWESTERLY ALONG THE ARC OF SAID CURVE THROUGH A CENTRAL ANGLE OF 61°42'17", A DISTANCE OF 1,443.12 FEET TO THE POINT OF REVERSE CURVATURE OF A CURVE CONCAVE SOUTHEASTERLY AND HAVING A RADIUS OF 1,570.00 FEET; THENCE SOUTHWESTERLY ALONG THE ARC OF SAID CURVE THROUGH A CENTRAL ANGLE OF 15°53'08", A DISTANCE OF 435.29 FEET TO THE POINT OF REVERSE CURVATURE OF A CURVE CONCAVE NORTHWESTERLY AND HAVING A RADIUS OF 1,500.00 FEET; THENCE SOUTHWESTERLY ALONG THE ARC OF SAID CURVE THROUGH A CENTRAL ANGLE OF 12°01'02", A DISTANCE OF 314.61 FEET TO THE POINT OF REVERSE CURVATURE OF A CURVE CONCAVE SOUTHEASTERLY AND HAVING A RADIUS OF 542.54 FEET; THENCE SOUTHWESTERLY ALONG THE ARC OF SAID CURVE THROUGH A CENTRAL ANGLE OF 44°16'55", A DISTANCE OF 419.31 FEET TO THE POINT OF REVERSE CURVATURE OF A CURVE CONCAVE NORTHWESTERLY AND HAVING A RADIUS OF 593.00 FEET; THENCE SOUTHWESTERLY ALONG THE ARC OF SAID CURVE THROUGH A CENTRAL ANGLE OF 14°21'42", A DISTANCE OF 148.64 FEET TO THE POINT OF COMPOUND CURVATURE OF A CURVE CONCAVE NORTHWESTERLY AND HAVING A RADIUS OF 300.00 FEET; THENCE SOUTHWESTERLY ALONG THE ARC OF SAID CURVE THROUGH A CENTRAL ANGLE OF 17°13'39", A DISTANCE OF 90.20 FEET TO THE POINT OF COMPOUND CURVATURE OF A CURVE CONCAVE NORTHERLY AND HAVING A RADIUS OF 1,220.00 FEET; THENCE WESTERLY ALONG THE ARC OF SAID CURVE THROUGH A CENTRAL ANGLE OF 33°22'21", A DISTANCE OF 710.60 FEET; THENCE N01°19'34"W, 45.00 FEET; THENCE N04°25'44"W, 860.56 FEET TO THE POINT OF BEGINNING.

AND

THAT LAND LYING IN SECTION 9, TOWNSHIP 19 SOUTH, RANGE 23 EAST, SUMTER COUNTY, FLORIDA, DESCRIBED AS FOLLOWS:

FROM THE NORTHEAST CORNER OF THE NORTHWEST 1/4 OF SAID SECTION 9 RUN S00°29'33"W, ALONG THE EAST LINE THEREOF A DISTANCE OF 667.66 FEET TO THE SOUTH LINE OF THE NORTH 1/4 OF THE NORTHWEST 1/4 OF SAID SECTION 9; THENCE DEPARTING SAID EAST LINE, N89°35'19"W, ALONG SAID SOUTH LINE A

DISTANCE OF 1,590.90 FEET TO THE POINT OF BEGINNING; THENCE CONTINUE
 ALONG SAID SOUTH LINE N89°35'19"W, 423.19 FEET; THENCE DEPARTING SAID
 SOUTH LINE, S00°06'44"W, 30.00 FEET TO A LINE 30.00 SOUTHERLY OF, WHEN
 MEASURED AT RIGHT ANGLES TO AND PARALLEL WITH, THE SAID SOUTH LINE
 OF THE NORTH 1/4 OF THE NORTHWEST 1/4 OF SECTION 9; THENCE N89°35'19"W
 ALONG SAID PARALLEL LINE FOR 568.89 FEET; THENCE DEPARTING SAID LINE
 S00°27'24"W, 163.64 FEET TO A POINT ON THE ARC OF A CURVE CONCAVE
 WESTERLY, HAVING A RADIUS OF 1599.55 FEET AND A CHORD BEARING AND
 DISTANCE OF S05°21'49"W, 297.20 FEET; THENCE SOUTHERLY ALONG THE ARC OF
 SAID CURVE, THROUGH A CENTRAL ANGLE OF 10°39'40", A DISTANCE OF 297.63
 FEET; THENCE S00°25'07"W, 1,511.83 FEET; THENCE S00°57'59"W, 987.31 FEET;
 THENCE S65°02'56"E, 808.32 FEET; THENCE S65°24'33"E, 365.88 FEET TO A POINT ON
 THE ARC OF A CURVE CONCAVE SOUTHWESTERLY, HAVING A RADIUS OF
 1,500.00 FEET AND A CHORD BEARING AND DISTANCE OF S62°48'07"E, 29.99 FEET;
 THENCE SOUTHEASTERLY ALONG THE ARC OF SAID CURVE, THROUGH A
 CENTRAL ANGLE OF 01°08'44", A DISTANCE OF 29.99 FEET; THENCE S27°46'15"W,
 ALONG A RADIAL LINE A DISTANCE OF 40.00 FEET TO A POINT ON THE ARC OF A
 CURVE CONCAVE SOUTHWESTERLY, HAVING A RADIUS OF 1,460.00 FEET AND A
 CHORD BEARING AND DISTANCE OF S58°46'21"E, 176.07 FEET; THENCE
 SOUTHEASTERLY ALONG THE ARC OF SAID CURVE, THROUGH A CENTRAL
 ANGLE OF 06°54'50", A DISTANCE OF 176.18 FEET; THENCE S53°17'52"E, 170.64 FEET;
 THENCE S51°15'31"E, 176.70 FEET TO A POINT ON THE ARC OF A CURVE CONCAVE
 NORTHERLY, HAVING A RADIUS OF 75.00 FEET AND A CHORD BEARING AND
 DISTANCE OF S80°20'40"E, 50.58 FEET; THENCE EASTERLY ALONG THE ARC OF
 SAID CURVE, THROUGH A CENTRAL ANGLE OF 39°24'44", A DISTANCE OF 51.59
 FEET TO THE POINT OF REVERSE CURVATURE OF A CURVE CONCAVE
 SOUTHERLY AND HAVING A RADIUS OF 131.00 FEET; THENCE EASTERLY ALONG
 THE ARC OF SAID CURVE THROUGH A CENTRAL ANGLE OF 04°36'53", A DISTANCE
 OF 10.55 FEET TO THE POINT OF REVERSE CURVATURE OF A CURVE CONCAVE
 NORTHWESTERLY AND HAVING A RADIUS OF 75.00 FEET; THENCE
 NORTHEASTERLY ALONG THE ARC OF SAID CURVE THROUGH A CENTRAL
 ANGLE OF 49°03'16", A DISTANCE OF 64.21 FEET; THENCE N35°30'35"E, 275.82 FEET
 TO THE POINT OF CURVATURE OF A CURVE CONCAVE SOUTHEASTERLY AND
 HAVING A RADIUS OF 960.00 FEET; THENCE NORTHEASTERLY ALONG THE ARC
 THEREOF THROUGH A CENTRAL ANGLE OF 56°47'53", A DISTANCE OF 951.66 FEET;
 THENCE S87°41'32"E, 137.04 FEET TO THE POINT OF CURVATURE OF A CURVE
 CONCAVE NORTHERLY AND HAVING A RADIUS OF 840.00 FEET; THENCE
 EASTERLY ALONG THE ARC THEREOF THROUGH A CENTRAL ANGLE OF 17°13'08",
 A DISTANCE OF 252.44 FEET TO THE POINT OF COMPOUND CURVATURE OF A
 CURVE CONCAVE NORTHWESTERLY AND HAVING A RADIUS OF 94.00 FEET;
 THENCE NORTHEASTERLY ALONG THE ARC OF SAID CURVE THROUGH A
 CENTRAL ANGLE OF 42°09'16", A DISTANCE OF 69.16 FEET TO THE POINT OF
 REVERSE CURVATURE OF A CURVE CONCAVE SOUTHEASTERLY AND HAVING A
 RADIUS OF 131.00 FEET; THENCE NORTHEASTERLY ALONG THE ARC OF SAID
 CURVE THROUGH A CENTRAL ANGLE OF 25°53'32", A DISTANCE OF 59.20 FEET TO
 THE POINT OF REVERSE CURVATURE OF A CURVE CONCAVE NORTHWESTERLY

AND HAVING A RADIUS OF 80.00 FEET; THENCE NORTHEASTERLY ALONG THE
 ARC OF SAID CURVE THROUGH A CENTRAL ANGLE OF 57°56'24", A DISTANCE OF
 80.90 FEET; THENCE N00°53'11"E, 55.55 FEET TO THE POINT OF CURVATURE OF A
 CURVE CONCAVE WESTERLY AND HAVING A RADIUS OF 15.00 FEET; THENCE
 NORTHERLY ALONG THE ARC THEREOF THROUGH A CENTRAL ANGLE OF
 35°29'00", A DISTANCE OF 9.29 FEET TO THE POINT OF REVERSE CURVATURE OF A
 CURVE CONCAVE EASTERLY AND HAVING A RADIUS OF 55.00 FEET; THENCE
 NORTHERLY ALONG THE ARC OF SAID CURVE THROUGH A CENTRAL ANGLE OF
 70°57'59", A DISTANCE OF 68.12 FEET TO THE POINT OF REVERSE CURVATURE OF
 A CURVE CONCAVE WESTERLY AND HAVING A RADIUS OF 15.00 FEET; THENCE
 NORTHERLY ALONG THE ARC OF SAID CURVE THROUGH A CENTRAL ANGLE OF
 35°29'00", A DISTANCE OF 9.29 FEET; THENCE N00°53'11"E, 141.00 FEET TO A POINT
 ON THE ARC OF A CURVE CONCAVE WESTERLY, HAVING A RADIUS OF 392.68
 FEET AND A CHORD BEARING AND DISTANCE OF N04°52'06"W, 59.63 FEET;
 THENCE NORTHERLY ALONG THE ARC OF SAID CURVE, THROUGH A CENTRAL
 ANGLE OF 08°42'33", A DISTANCE OF 59.69 FEET TO A POINT ON THE ARC OF A
 CURVE CONCAVE WESTERLY, HAVING A RADIUS OF 486.00 FEET AND A CHORD
 BEARING AND DISTANCE OF N04°37'40"W, 11.74 FEET; THENCE NORTHERLY
 ALONG THE ARC OF SAID CURVE, THROUGH A CENTRAL ANGLE OF 01°23'02", A
 DISTANCE OF 11.74 FEET; THENCE N05°19'11"W, 380.19 FEET TO THE POINT OF
 CURVATURE OF A CURVE CONCAVE WESTERLY AND HAVING A RADIUS OF
 670.00 FEET; THENCE NORTHERLY ALONG THE ARC THEREOF THROUGH A
 CENTRAL ANGLE OF 32°38'16", A DISTANCE OF 381.66 FEET; THENCE N37°57'27"W,
 424.50 FEET TO THE POINT OF CURVATURE OF A CURVE CONCAVE EASTERLY
 AND HAVING A RADIUS OF 730.00 FEET; THENCE NORTHERLY ALONG THE ARC
 THEREOF THROUGH A CENTRAL ANGLE OF 53°22'50", A DISTANCE OF 680.11 FEET;
 THENCE N15°25'23"E, 278.83 FEET TO THE POINT OF CURVATURE OF A CURVE
 CONCAVE EASTERLY AND HAVING A RADIUS OF 1,230.00 FEET; THENCE
 NORTHERLY ALONG THE ARC THEREOF THROUGH A CENTRAL ANGLE OF
 08°01'49", A DISTANCE OF 172.39 FEET; THENCE N23°27'12"E, 167.54 FEET; THENCE
 N66°32'48"W, 155.42 FEET; THENCE S74°49'09"W, 100.76 FEET; THENCE S60°26'27"W,
 70.61 FEET; THENCE S36°11'06"W, 229.74 FEET; THENCE S35°23'40"W, 80.07 FEET;
 THENCE S31°02'50"W, 80.82 FEET; THENCE S29°58'52"W, 70.00 FEET; THENCE
 S28°56'39"W, 74.02 FEET; THENCE S25°48'13"W, 75.04 FEET; THENCE S22°26'41"W,
 81.47 FEET; THENCE S25°55'09"W, 82.38 FEET; THENCE S15°35'19"W, 75.60 FEET;
 THENCE S12°22'04"W, 75.60 FEET; THENCE S09°08'37"W, 75.60 FEET; THENCE
 S06°31'41"W, 72.21 FEET; THENCE S06°15'56"W, 140.00 FEET; THENCE S02°10'48"W,
 140.36 FEET; THENCE S06°15'56"W, 116.80 FEET; THENCE S08°15'10"W, 23.22 FEET;
 THENCE S10°14'59"W, 64.75 FEET; THENCE S18°33'06"W, 68.58 FEET; THENCE
 S18°56'28"W, 140.00 FEET; THENCE S29°43'35"W, 72.96 FEET; THENCE S88°03'29"W,
 574.91 FEET; THENCE N64°03'28"W, 54.82 FEET; THENCE N49°18'10"W, 689.66 FEET;
 THENCE N65°50'05"W, 128.44 FEET; THENCE N73°57'53"W, 70.71 FEET; THENCE
 N65°00'39"W, 80.90 FEET; THENCE N51°18'44"W, 76.65 FEET; THENCE N36°39'16"W,
 61.03 FEET; THENCE N23°29'03"W, 60.26 FEET; THENCE N10°40'18"W, 59.64 FEET;
 THENCE N00°09'23"W, 76.75 FEET; THENCE N00°26'56"E, 289.00 FEET; THENCE
 N05°17'40"E, 73.07 FEET; THENCE N20°29'12"E, 65.50 FEET; THENCE N36°21'16"E, 73.46

FEET; THENCE N50°07'41"E, 71.90 FEET; THENCE N64°30'21"E, 62.94 FEET; THENCE
N74°29'48"E, 175.88 FEET; THENCE N60°02'31"E, 412.86 FEET; THENCE N03°39'18"E,
409.23 FEET TO THE POINT OF BEGINNING.